



Fira Barcelona

**GRAN VIA**





## FIRA GRAN VIA

Fira Gran Via is one of the largest and most modern Exhibition and Conference Centre in Europe, and also one of the most highly-rated by organisers, exhibitors and visitors from all over the world.

Designed by Pritzker Prize Japanese architect Toyo Ito, it combines a spectacular appearance with respect for the environment and provides an efficient yet creative solution to the needs of exhibitors and visitors alike.

The venue covers an area of 198,500 m<sup>2</sup> distributed among eight halls and three independent accesses. Hall 8 is home to the Gran Via Convention Centre, an area of 24,500 m<sup>2</sup> equipped with soundproof panels that its flexibility lets create multiple rooms being the maximum size of 2,500 seats. In total there are 70 rooms available.

Larger events can also be hosted using its adjacent halls. Specially Hall 6, a multipurpose pavilion that can be turned into a real plenary room of 3,600 seats extendible to 5,600.



## HOW TO GET THERE

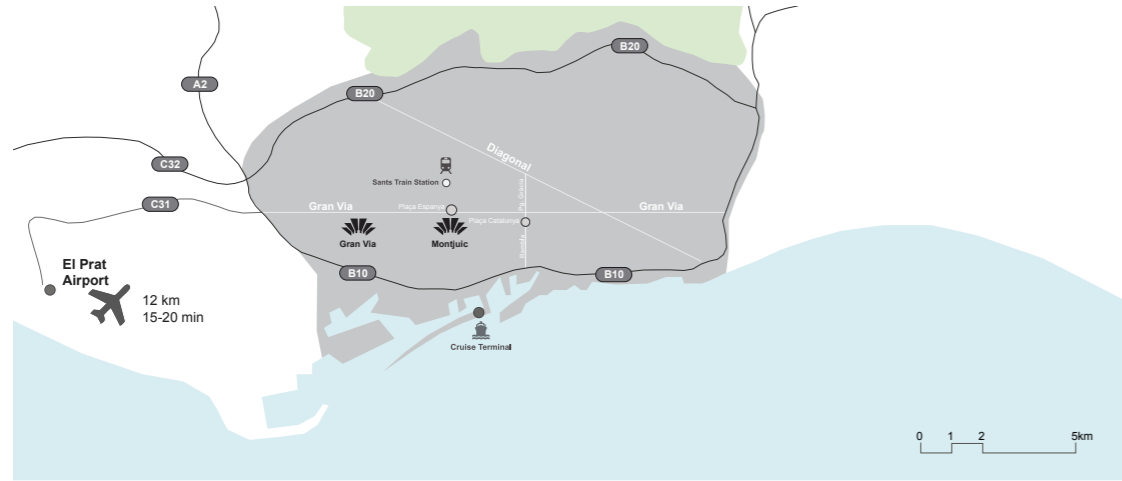

### VENUE

Located just 3 kilometers from Barcelona's historic city center, Fira Gran Via is ideally situated in a newly redeveloped business district. The expansive and modern venue is conveniently linked by the local public transport network to both the metropolitan downtown and nearby El Prat International Airport (12 km).

Its outstanding features include renowned architecture, modern functionality and commitment to sustainability. The venue comprises of an impressive rooftop photovoltaic installation stretching across its eight inter-connected pavilions. The inspiring South Entrance holds the acclaimed Nucló Restaurant and leads exhibition visitors to the upper walkway. This free-flowing design both maximizes connectivity and gives exhibitors and visitors unparalleled access to Fira Gran Via's cutting-edge event services and logistics capacity.

### AIRPORT

Barcelona Airport handles more than 800 flights per day to 141 destinations (30 intercontinental) and over 47 million passengers per year in 2017. It is accessible directly from Fira Gran Via thanks to the Metro line 9 and 10, train and bus connections.

### HOTELS

Barcelona city offers in 2018 more than 40,000 rooms in all categories, and has new projects for around 2,500 more to be completed in the coming years. There are some 1,345 hotel rooms built already in a walking distance around the venue, increasing to more than 5,000 rooms within a perimeter of 3km.

### TRANSPORT

Fira Gran Via is easy to reach by public transport. The venue has three Metro stations (L9 and L10) connecting the airport and the city center and it is also connected through FGC Regional Train to Barcelona downtown and surroundings. Barcelona has 10,500 taxis and attendees can easily find taxi ranks right in front of South, North and East accesses.

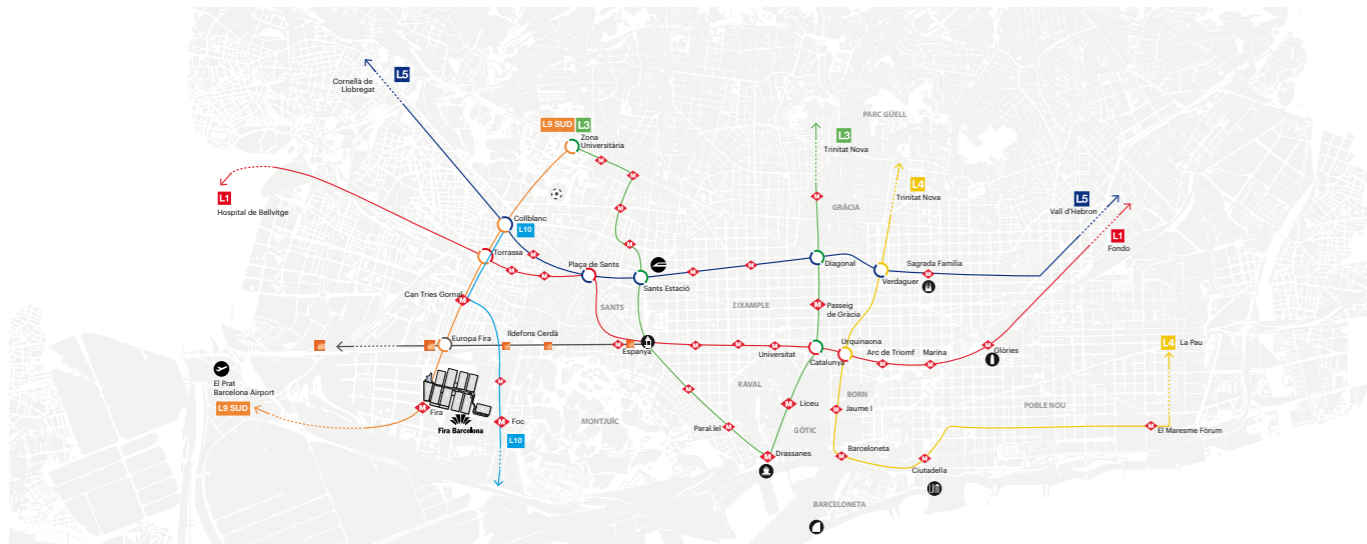

## EASY FLOW

Gran Via's walkway is an easy and pleasant way to cross the venue and access all facilities located on the first floor.

It connects Conference Centers, Multipurpose Rooms, catering outlets, terraces and it helps enormously on the attendee's sense of direction within the venue.

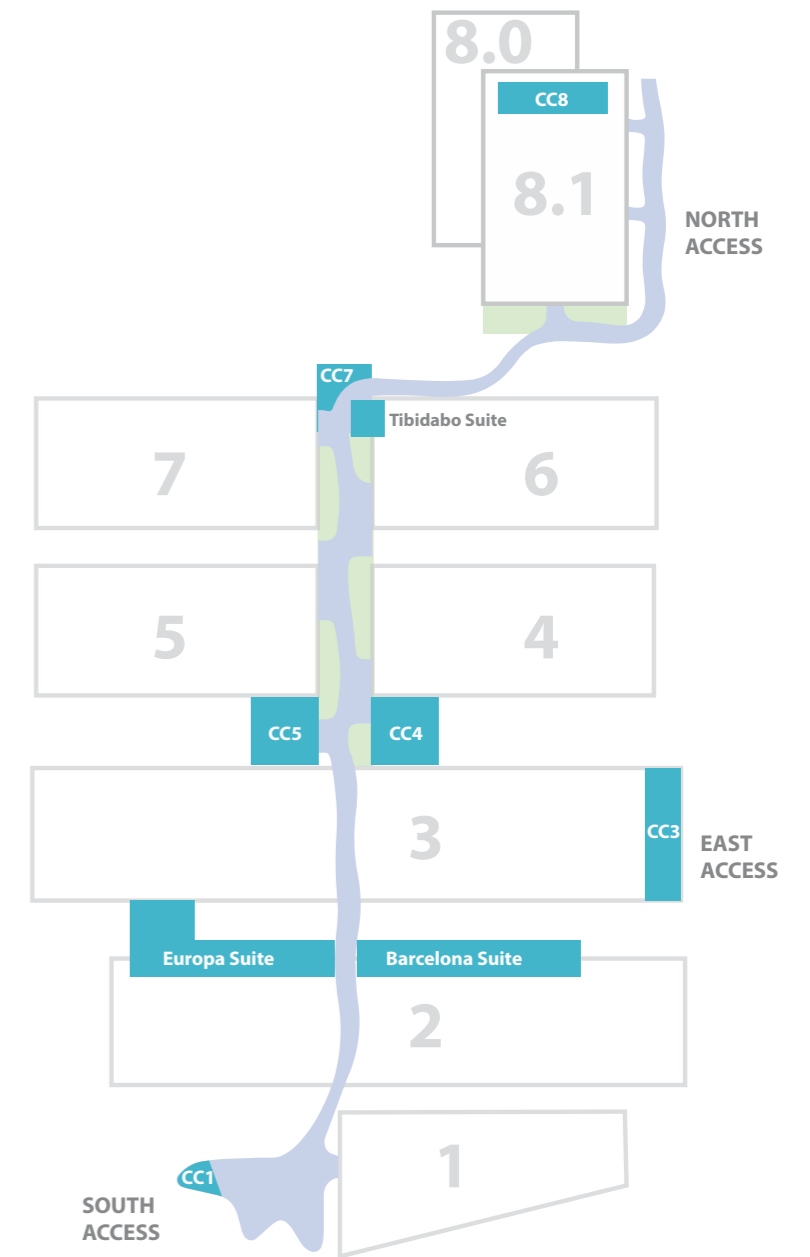

## SUSTAINABILITY

The architectural design of the venue made use of various sources of natural energy with the aim of maximizing sustainability and reducing the impact on the environment. As the ultimate exponent of this trend, Fira Barcelona has a photovoltaic plant of 165,000 m2 which avoids the annual emission of 2,047 tons of CO2 and generates enough energy to power 980 standard family homes.



## WIFI & INTERNET

All our facilities are equipped with the most advanced installations that deliver up to 10 Gb to anywhere in the venue with a permanent overall internet throughput of 20 Gbps. At the same time, a state-of-the-art network of wireless antennae integrated in the cable network provides 802.11ac coverage to every hall to fully satisfy the technology needs of every event organizer.





# VENUE OVERVIEW

HALL	m <sup>2</sup>
1	14,000
2	32,000
3	43,000
4	20,000
5	17,000
6	20,000
7	17,000
8.0	13,800
8.1	12,700



- Metro
- FGC
- BUS
- TAXI
- Parking



Welcome to ISE 2023  
We hope you enjoy your visit

Tervetuloa

Tervetuloa

Welcome to ISE 2023  
We hope you enjoy your visit

Welcome to ISE 2023  
We hope you enjoy your visit

Welcome to ISE 2023  
We hope you enjoy your visit

Welcome to ISE 2023  
We hope you enjoy your visit

integrated systems europe

Print and Go

Sustainable  
Sustainable

Keep your digital entry voucher or printed badge ready



# SOUTH ACCESS

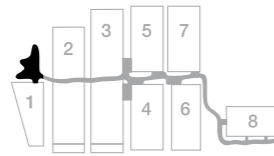

## LEVEL 0

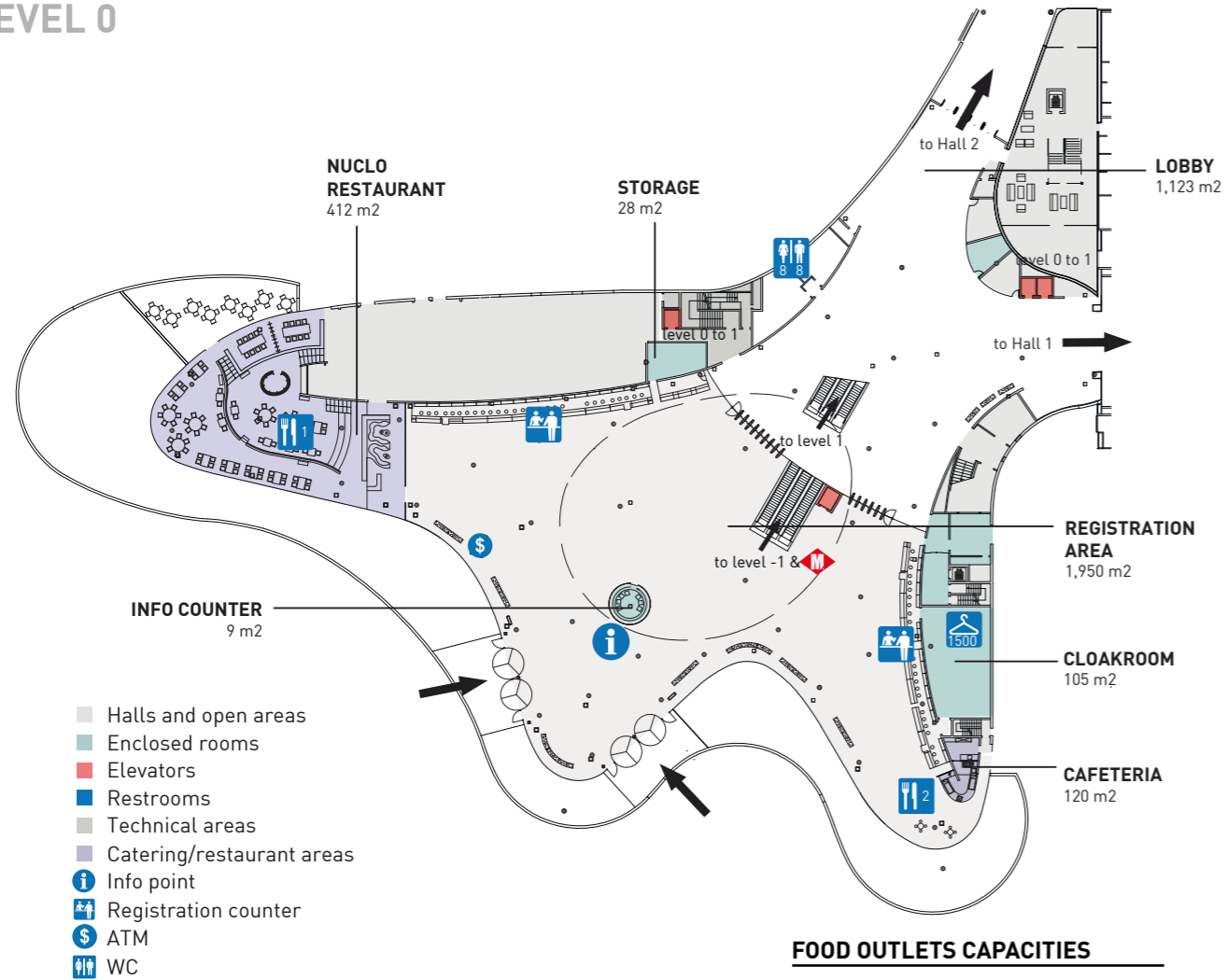

### FOOD OUTLETS CAPACITIES

	INDOORS	OUTDOORS
Outlet 1 (Nucló)	150	24
Outlet 2	50	-

## LEVEL -1

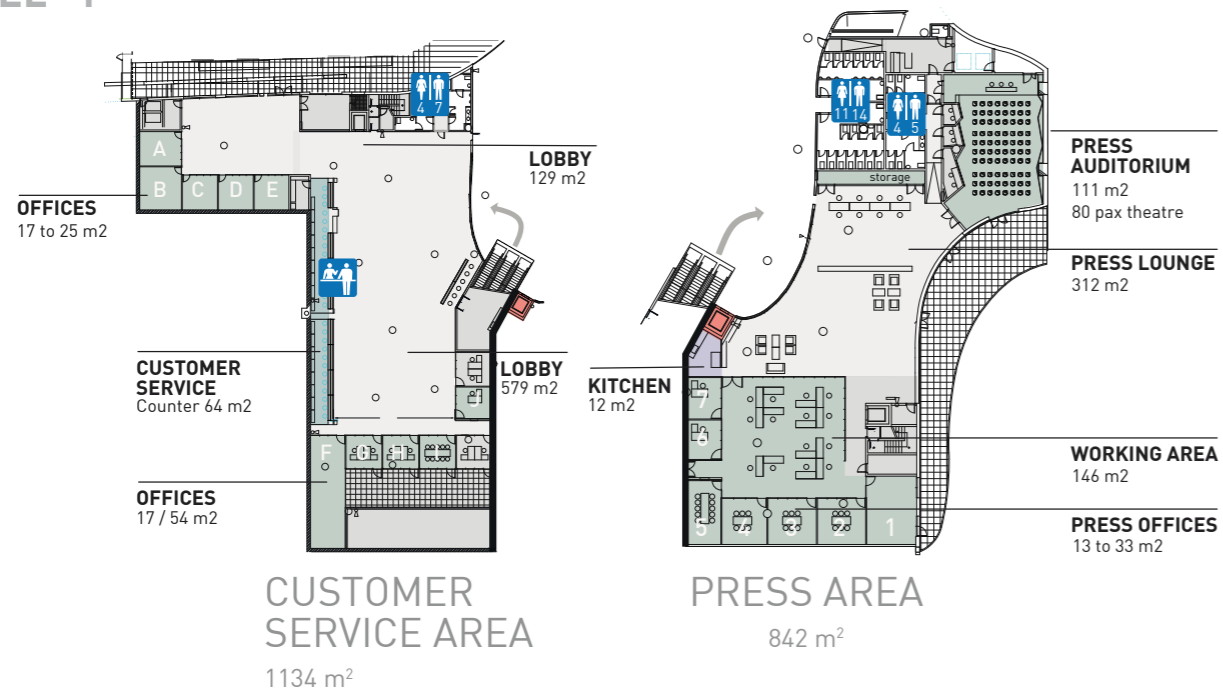

## LEVEL 1

### CONFERENCE CENTER 1

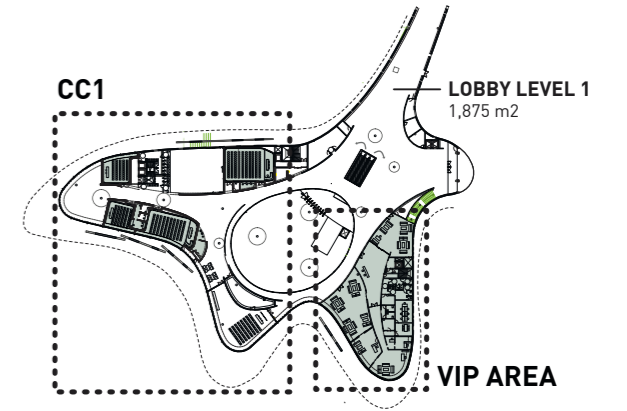
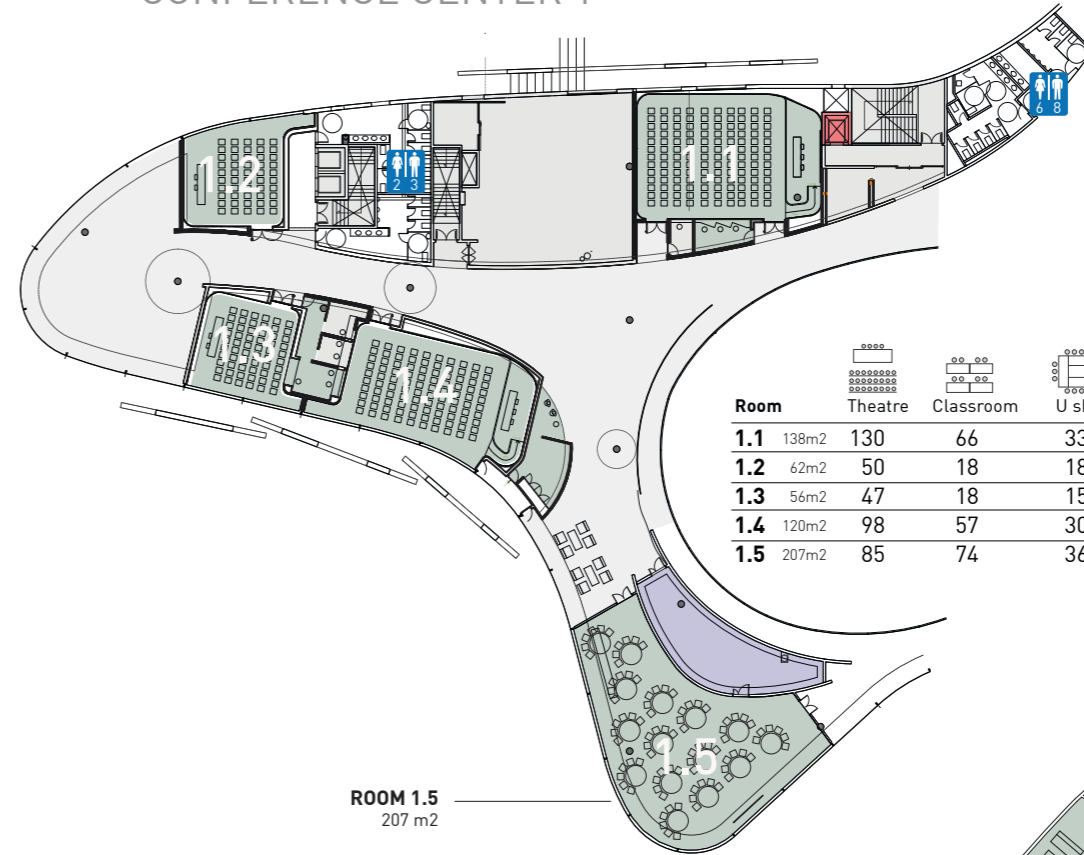

### VIP AREA

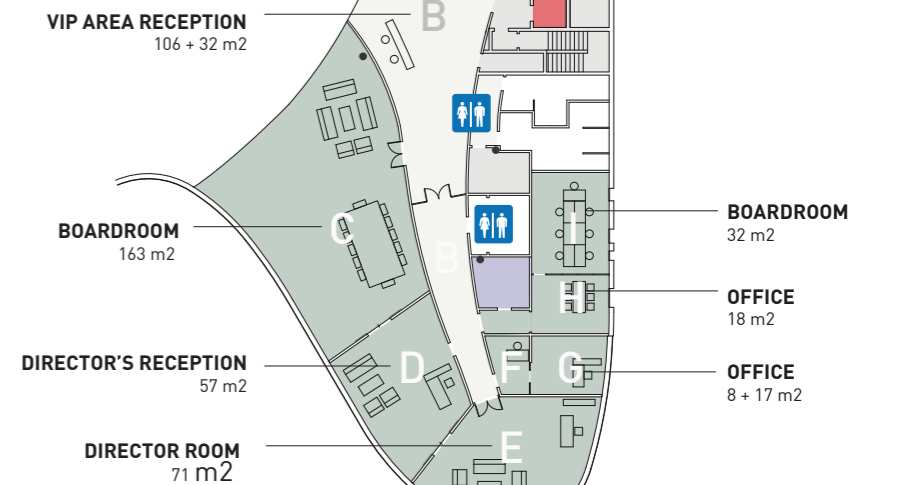



# HALL 1

Gross Surface 14,000 sqm

Ground Resistance 3,000 kg/sqm

Height 11m

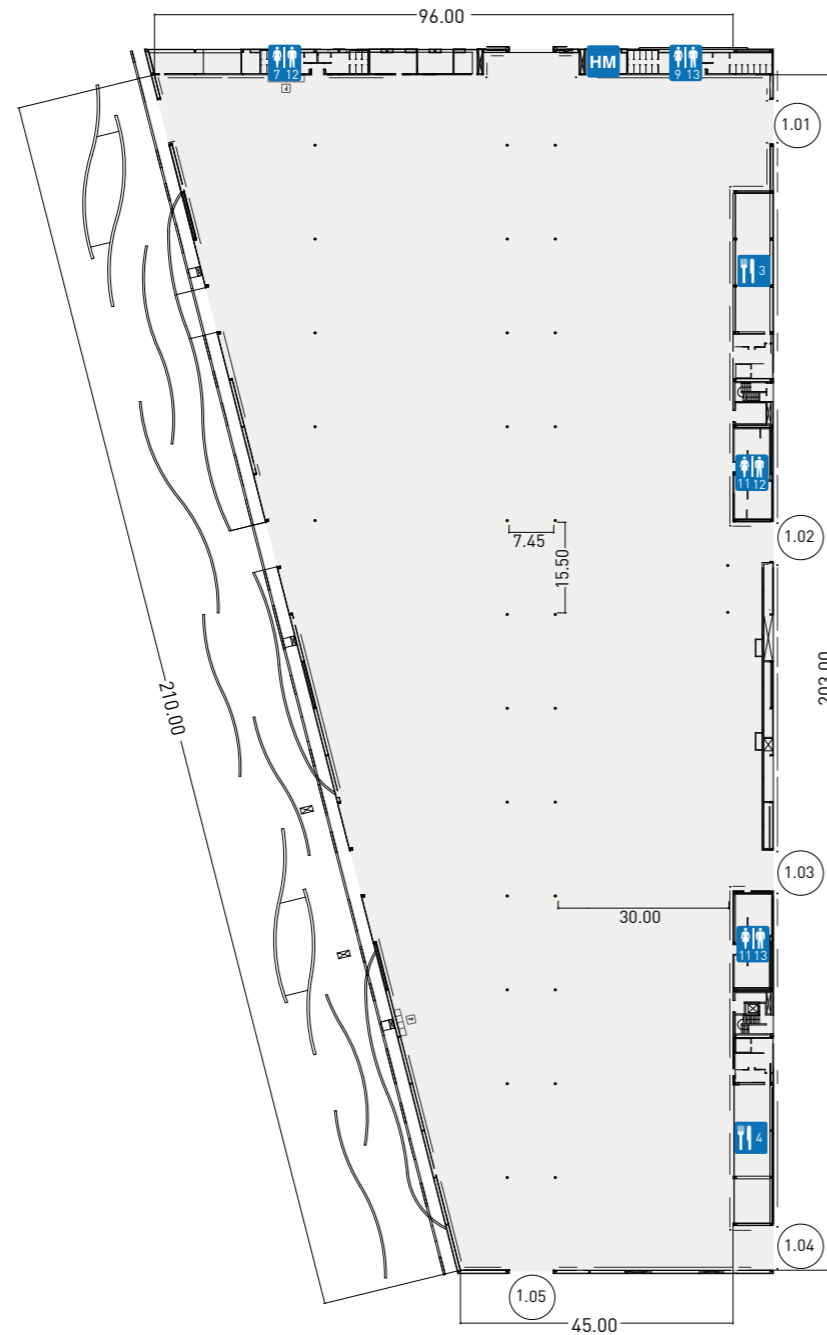
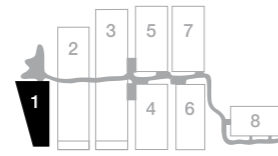

- Outlet
- Cloakroom
- WC
- Hall manager
- Info point

## FOOD OUTLET CAPACITIES

	INDOORS	OUTDOORS
Outlet 3	80	120
Outlet 4	80	120

# HALL 2

Gross Surface 32,000 m2

Ground Resistance 5,000 kg/m2

1,800 kg/m2

Height 9.50 - 12m

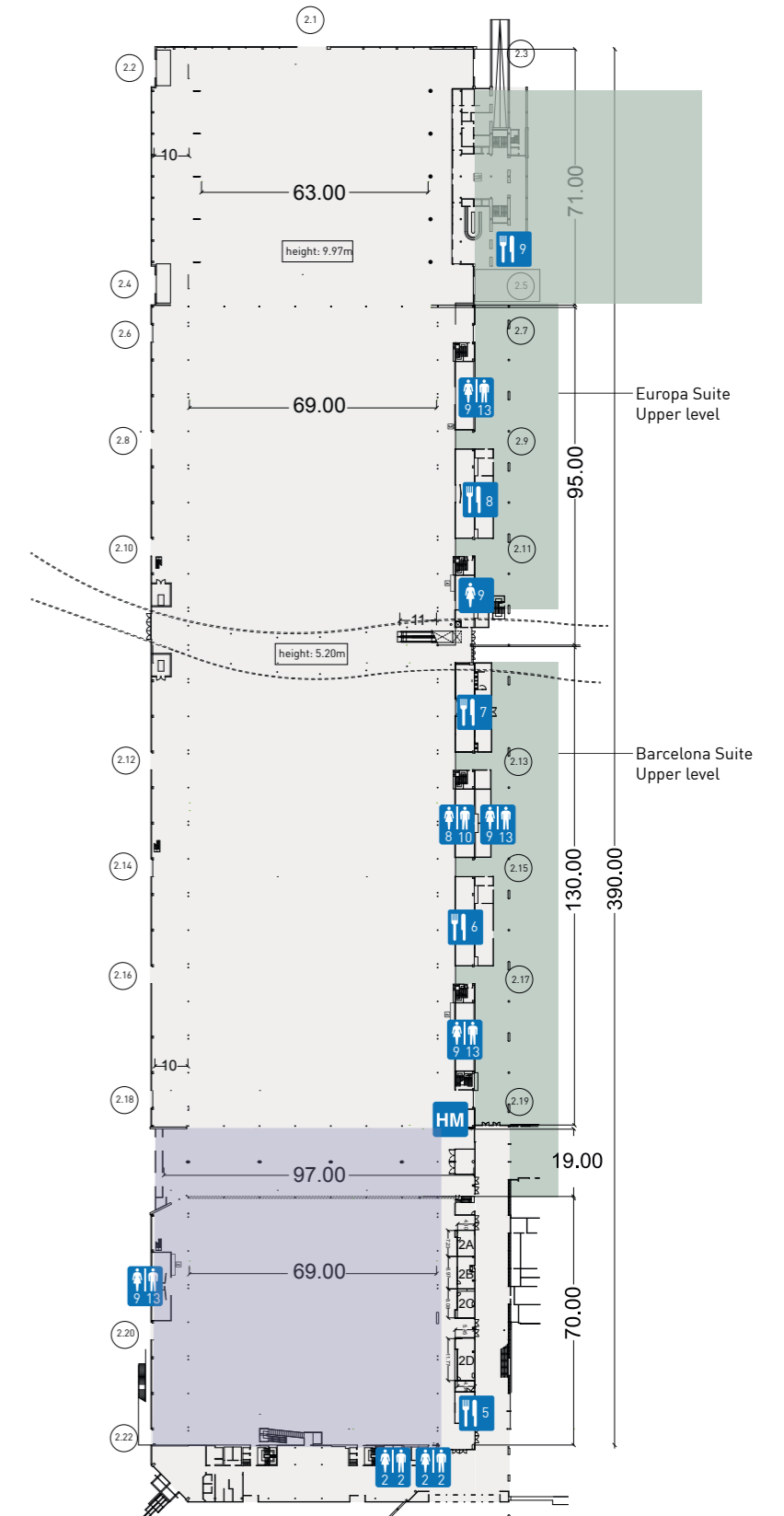
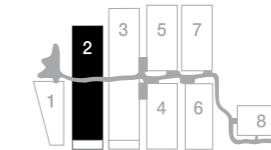

- Outlet
- WC
- Hall manager

## FOOD OUTLET CAPACITIES

	INDOORS	OUTDOORS
Outlet 5	30	-
Outlet 6	50	180
Outlet 7	50	60
Outlet 8	100	130
Outlet 9	65	90



# BARCELONA SUITE

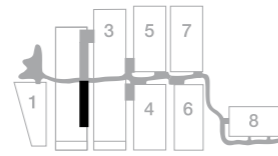

<b>Number of Rooms</b>	46
<b>Room height</b>	2.60m
<b>Sizes</b>	18-25 m2/ 32-36 m2
<b>Capacities</b>	8 pax/ 16 pax

Soundproof walls. Furnished with table, chairs and lockable cupboard. Sockets on wall: 4 units. Floor mounted electrical box with 4 sockets and ethernet connection.



<b>18m2/ 8 pax</b>	36 rooms
<b>21m2/ 8 pax</b>	2 rooms
<b>25m2/ 8 pax</b>	1 room
<b>32m2/ 16 pax</b>	1 room
<b>36m2/ 16 pax</b>	6 rooms

- Halls and open areas
- Enclosed rooms
- Elevators
- Restrooms
- Technical areas/ stairs

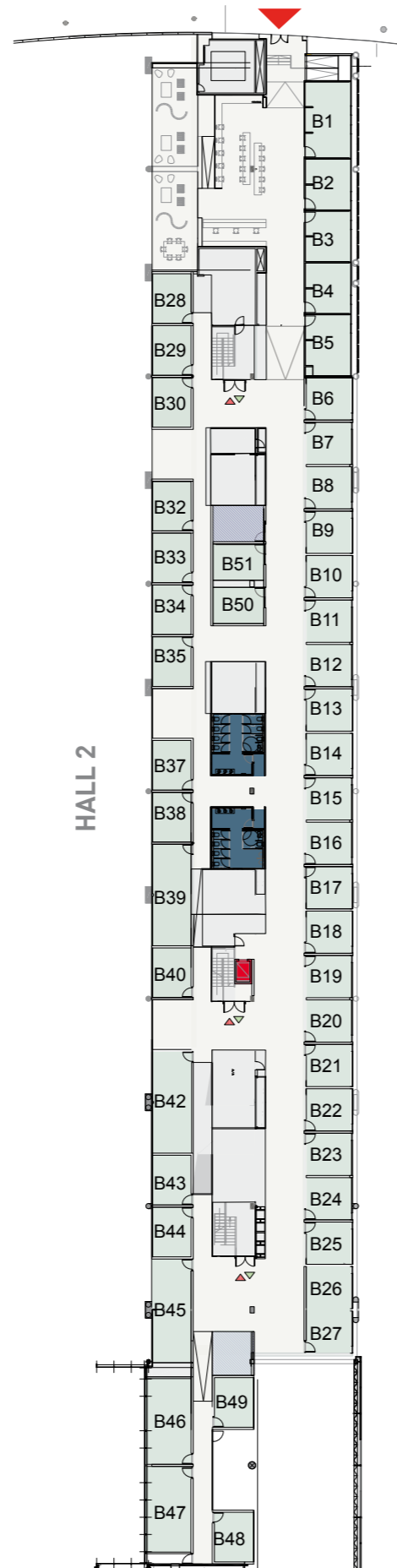

# EUROPA SUITE

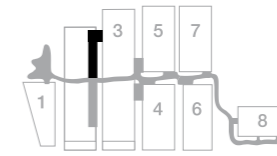

<b>Number of Rooms</b>	56
<b>Room height</b>	2.60m
<b>Sizes</b>	16-23 m2 / 32-36 m2
<b>Capacities</b>	8 pax / 16 pax

Soundproof walls. Furnished with table, chairs and lockable cupboard. Sockets on wall: 4 units. Floor mounted electrical box with 4 sockets and ethernet connection.

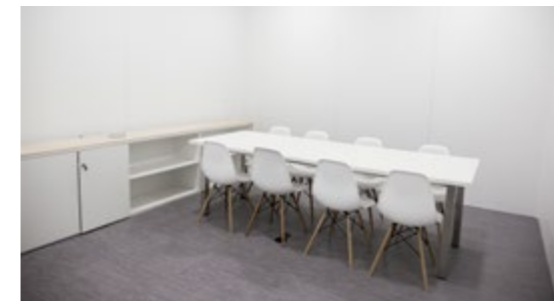

<b>16m2/ 8 pax</b>	15 rooms
<b>18m2/ 8 pax</b>	28 rooms
<b>23m2/ 8 pax</b>	7 rooms
<b>32m2/ 16 pax</b>	3 rooms
<b>36m2/ 16 pax</b>	3 rooms

- Halls and open areas
- Enclosed rooms
- Elevators
- Restrooms
- Technical areas/ stairs

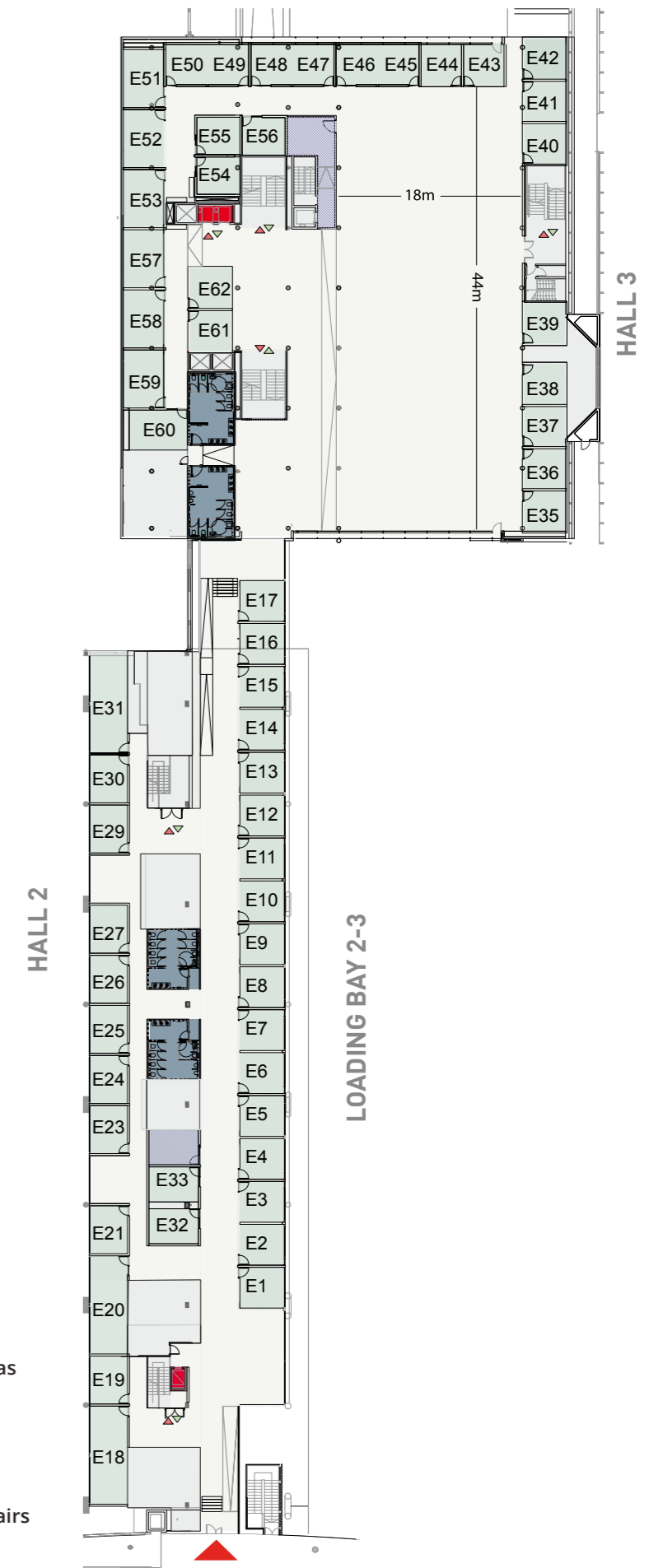



# HALL 3

Gross Surface 43,000 m<sup>2</sup>

Ground Resistance 5,000 kg/m<sup>2</sup>

Height 12 - 15.8 m



- Outlet
- Cloakroom
- WC
- Hall manager
- First aid
- Info point
- Registration counter

## FOOD OUTLET CAPACITIES

	INDOORS	OUTDOORS
Outlet 11	550	-
Outlet 12	60	108
Outlet 13	60	108
Outlet 14	60	108
Outlet 15	60	108
Outlet 16	180	-
Outlet 17	50	-
Outlet 18	50	-
Outlet 19	50	-
Outlet 20	50	-
Outlet 21	50	-
Outlet 22	50	-

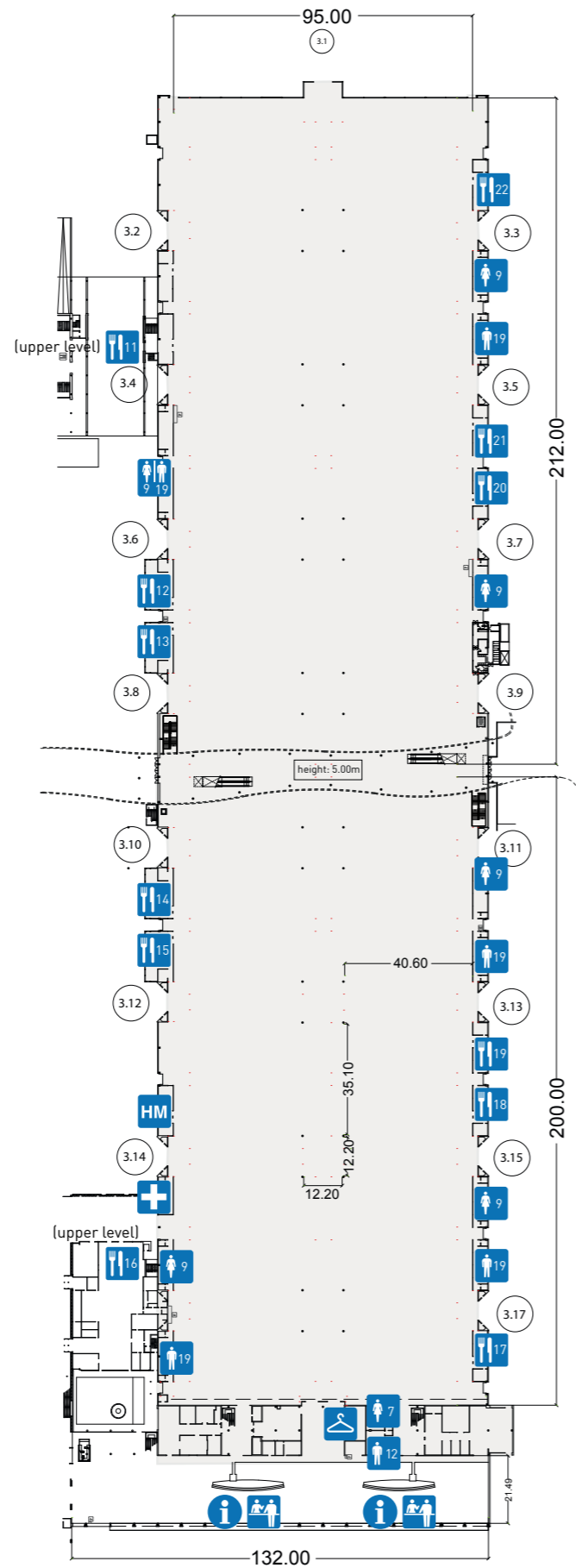
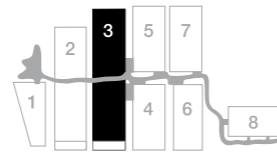

# EAST ACCESS AND CONFERENCE CENTER 3

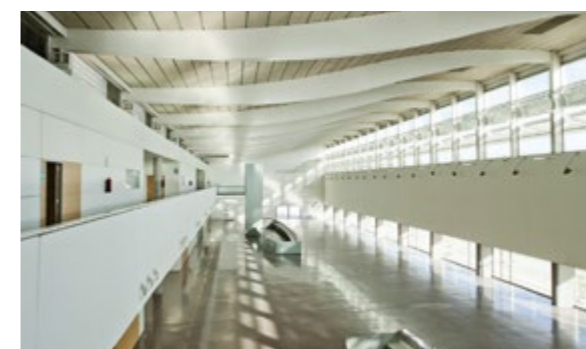
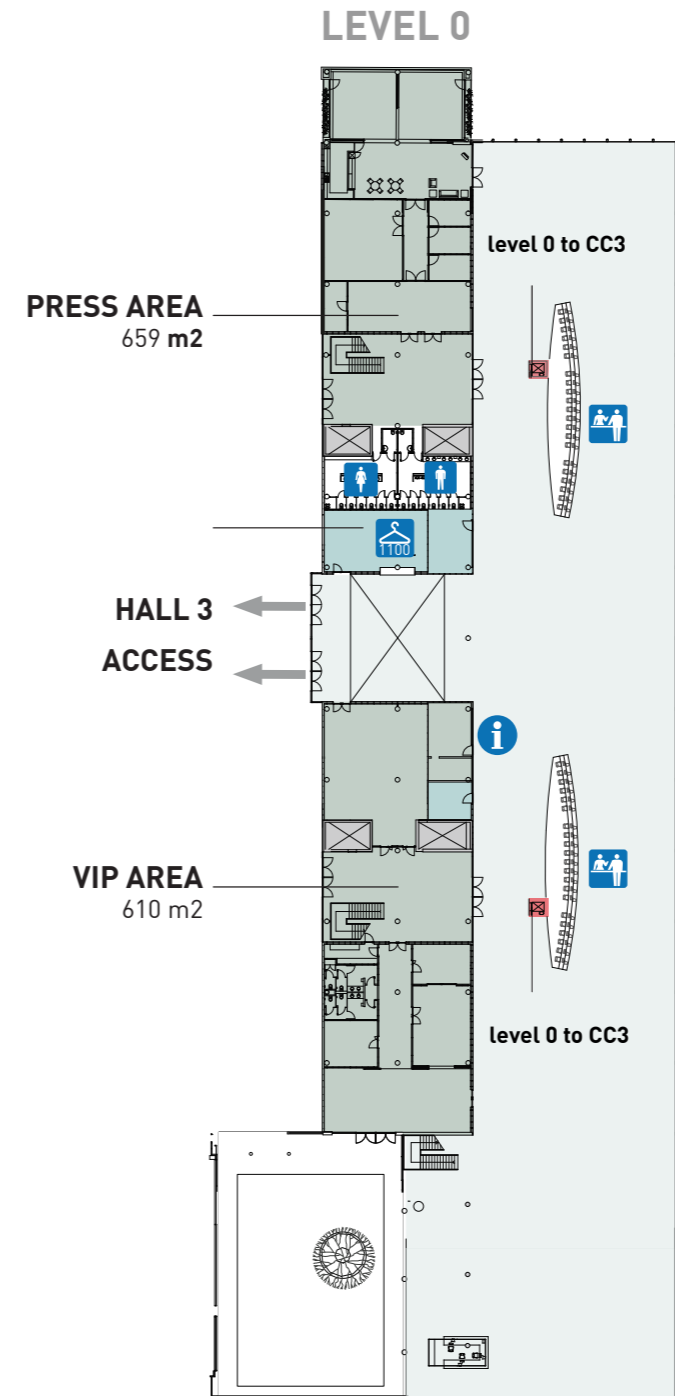
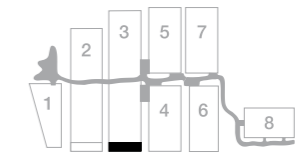

## LEVEL 1

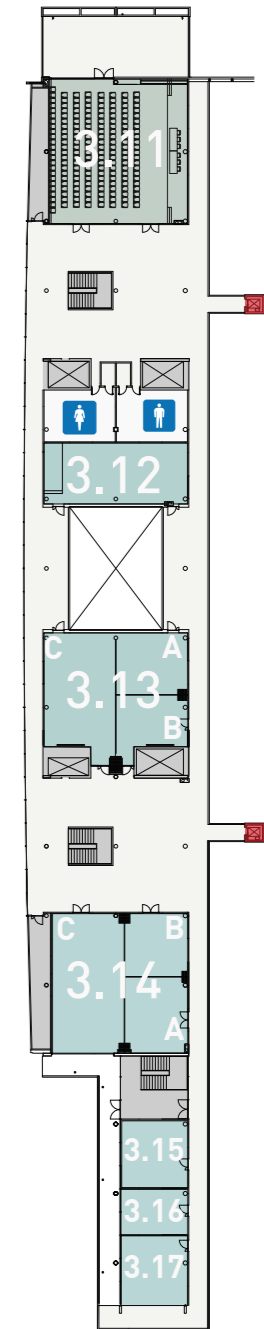

Room	Theatre	Classroom	U shape	Boardroom
3.11	182	126	42	60
3.12	88	48	36	39
3.13	150	102	42	54
3.14	152	105	42	54
3.15/3.17	12	-	-	12
3.16	12	-	-	12







# HALL 4

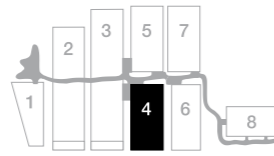

**Gross Surface** 20,000 m<sup>2</sup>  
**Ground Resistance** 5,000 kg/m<sup>2</sup>  
**Height** 12 - 15.8 m

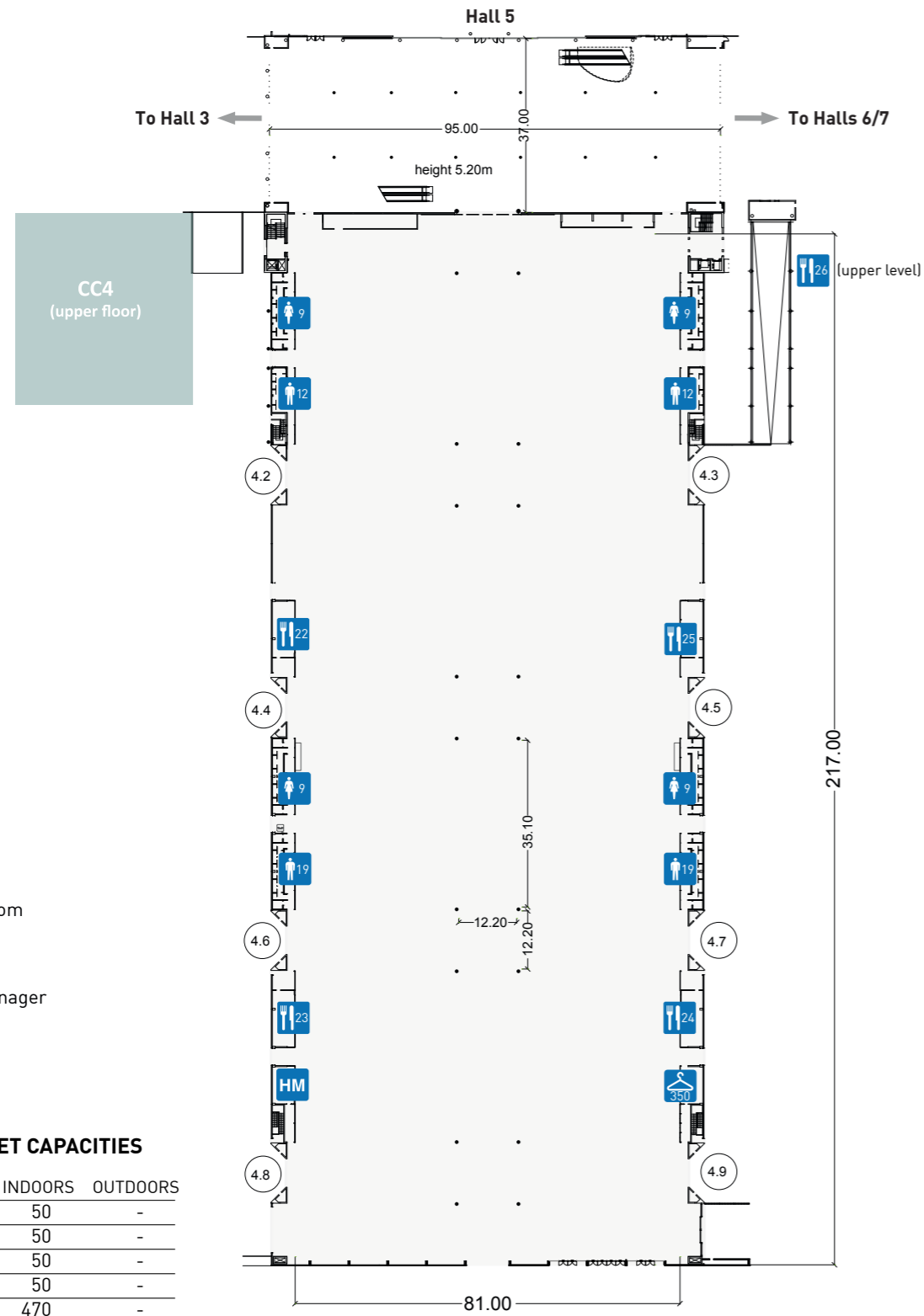

- Outlet
- Cloakroom
- WC
- Hall manager

### FOOD OUTLET CAPACITIES

	INDOORS	OUTDOORS
Outlet 22	50	-
Outlet 23	50	-
Outlet 24	50	-
Outlet 25	50	-
Outlet 26	470	-

# CONFERENCE CENTER 4

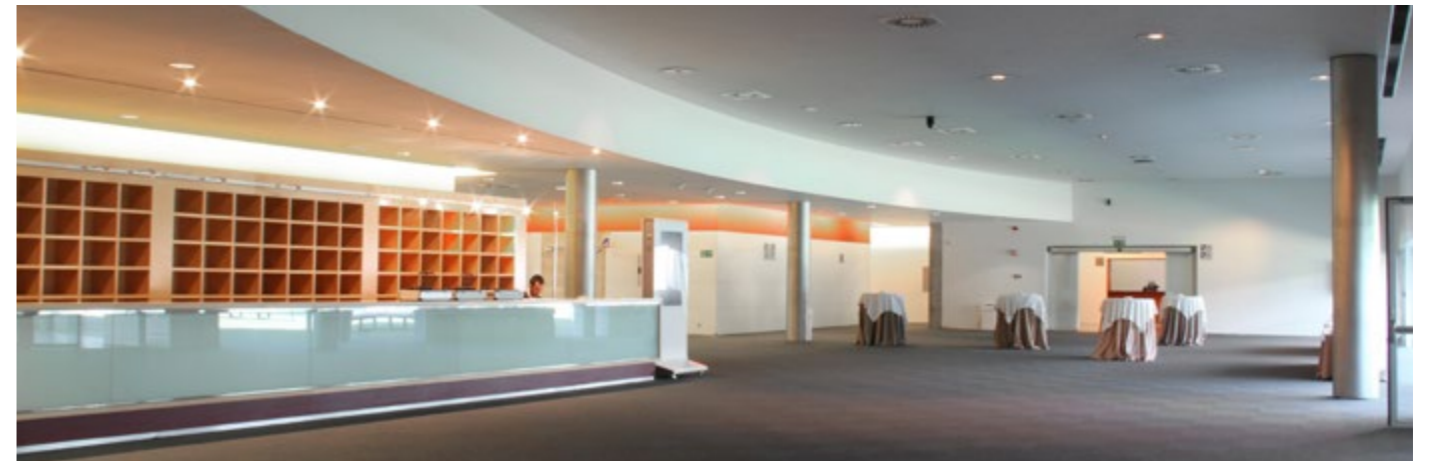
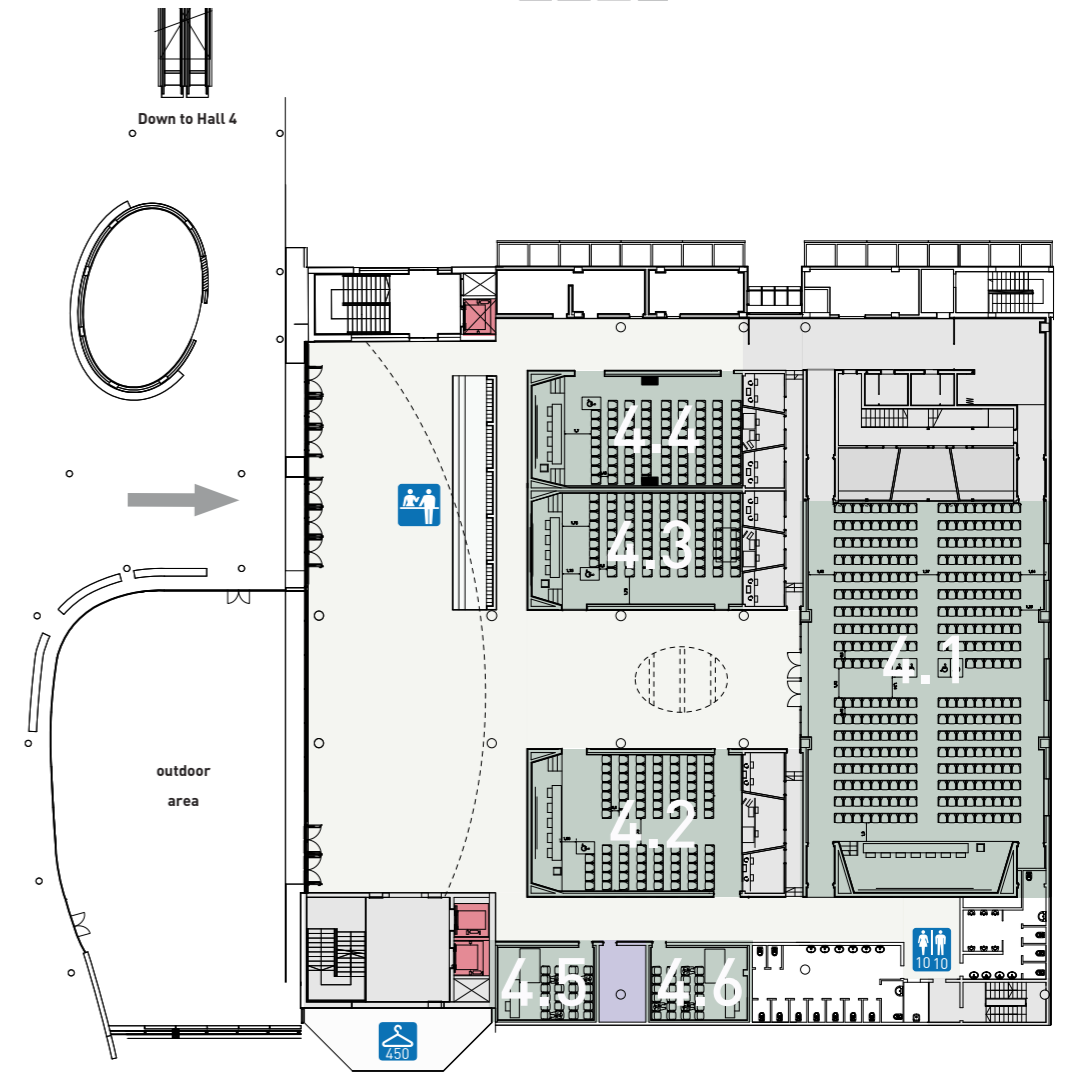
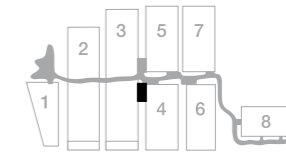

Room	Theatre	Classroom	U shape	Boardroom	Banquet	Cabaret
4.1	326	219	69	84	140	120
4.2	89	54	24	30	-	-
4.3	81	36	24	30	-	-
4.4	80 (36+36)	36	24	20	-	-
4.5/4.6	24	10	12	12	-	-



# HALL 5

Gross Surface	17,000 m <sup>2</sup>
Ground Resistance	3,000 kg/m <sup>2</sup>
Height	11 m

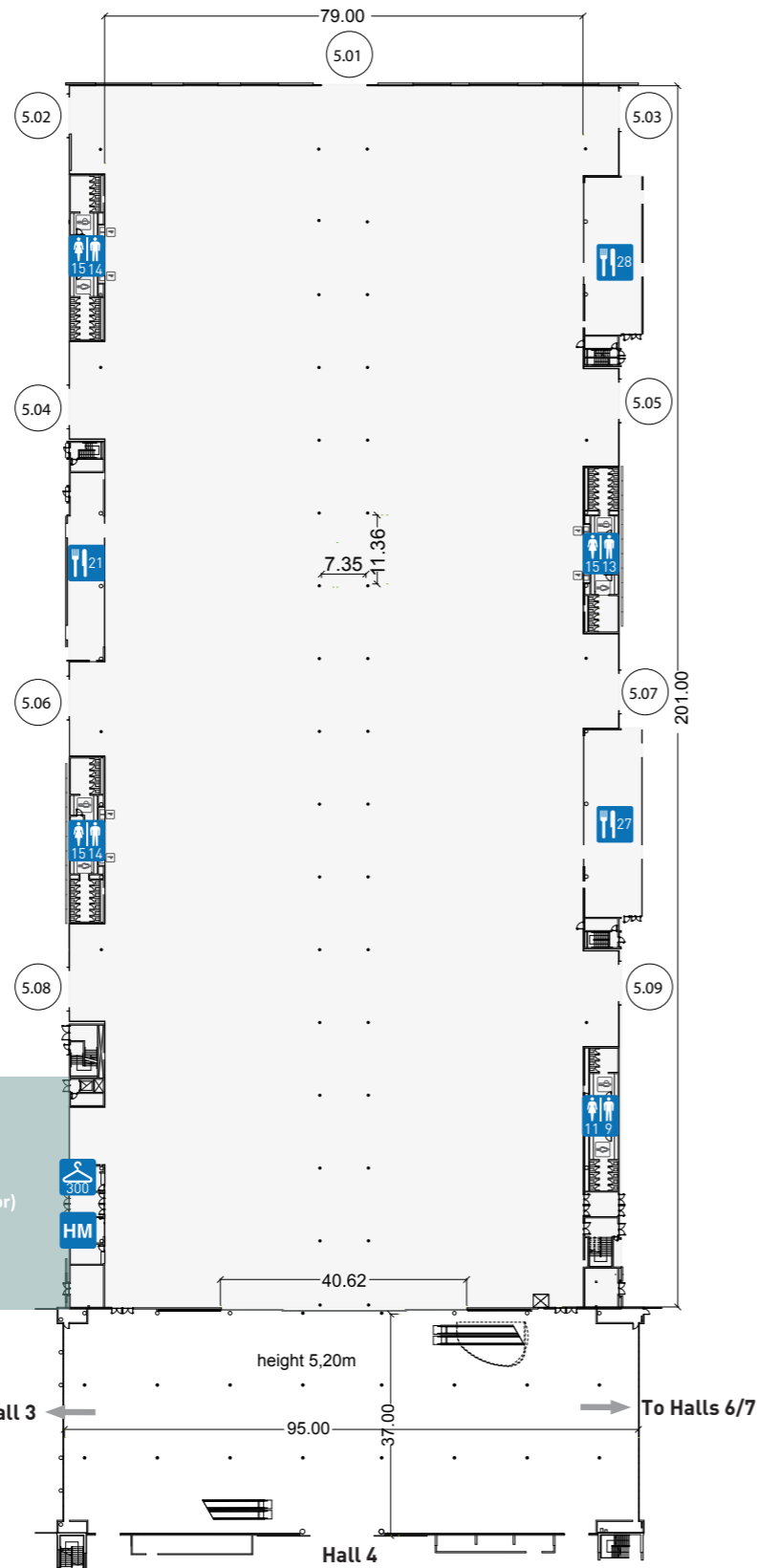
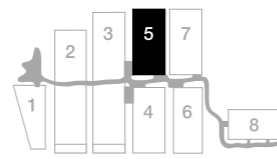
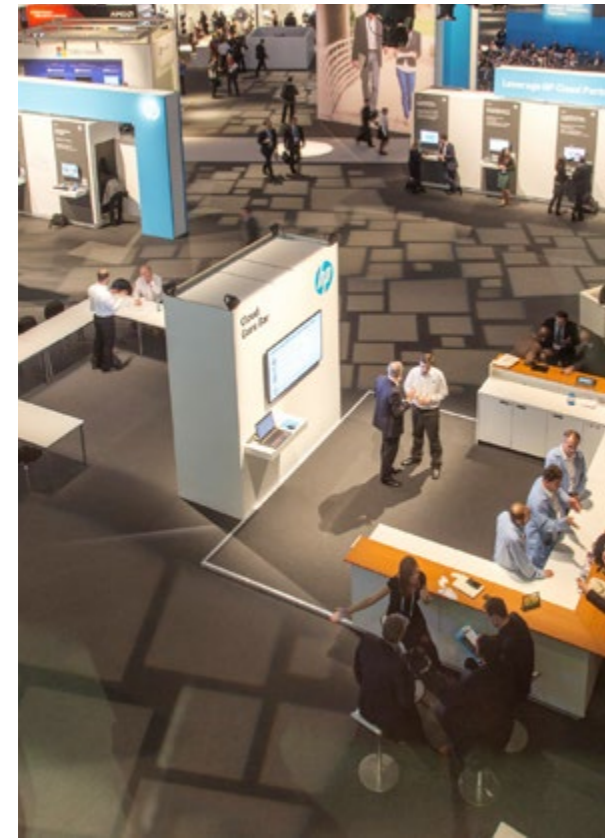

- Outlet
- Cloakroom
- WC
- Hall manager

### FOOD OUTLET CAPACITIES

	INDOORS	OUTDOORS
Outlet 21	80	140
Outlet 27	100	100
Outlet 28	100	140

# CONFERENCE CENTER 5

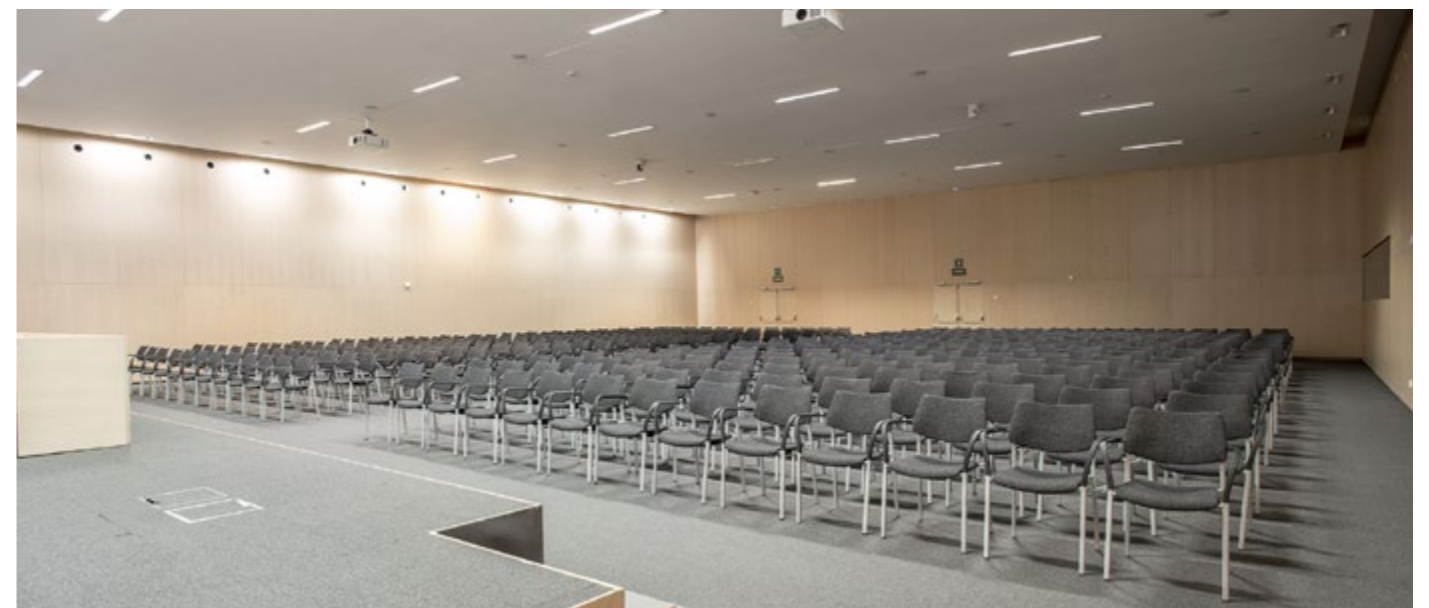
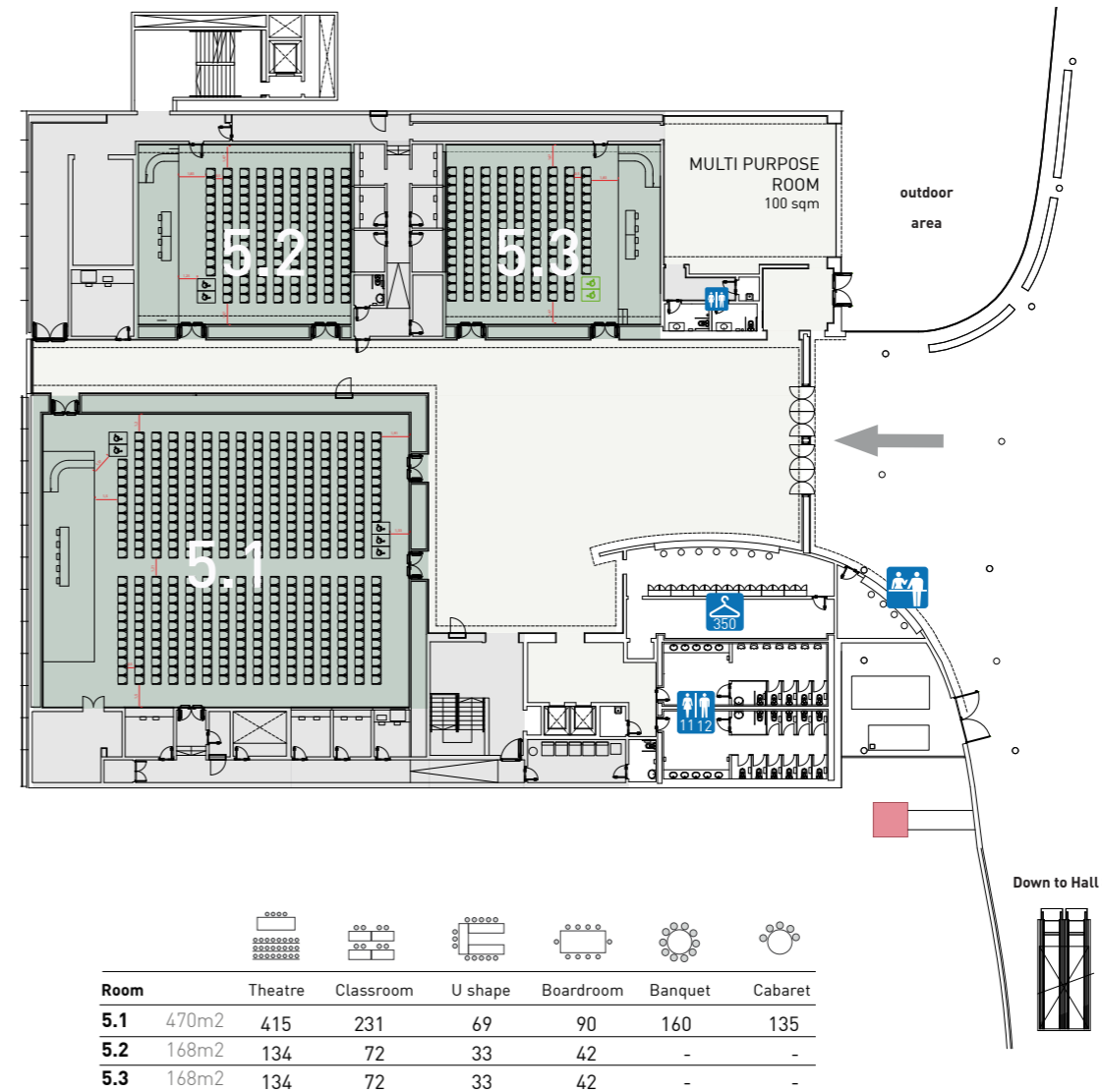
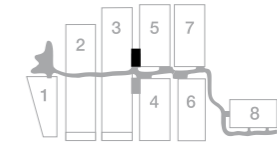







# HALL 6

**Gross Surface** 20,000 m<sup>2</sup>  
**Ground Resistance** 5,000 kg/m<sup>2</sup>  
**Height** 12 - 15.8 m

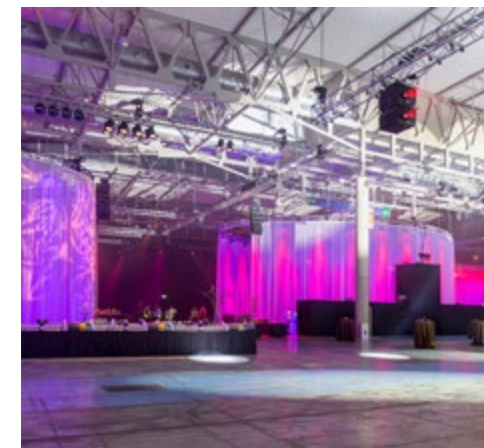

- Outlet
- Cloakroom
- WC
- Hall manager
- Info point

**FOOD OUTLET CAPACITIES**

	INDOORS	OUTDOORS
Outlet 26	420	-
Outlet 31	50	-
Outlet 32	50	-
Outlet 33	50	-
Outlet 34	50	-

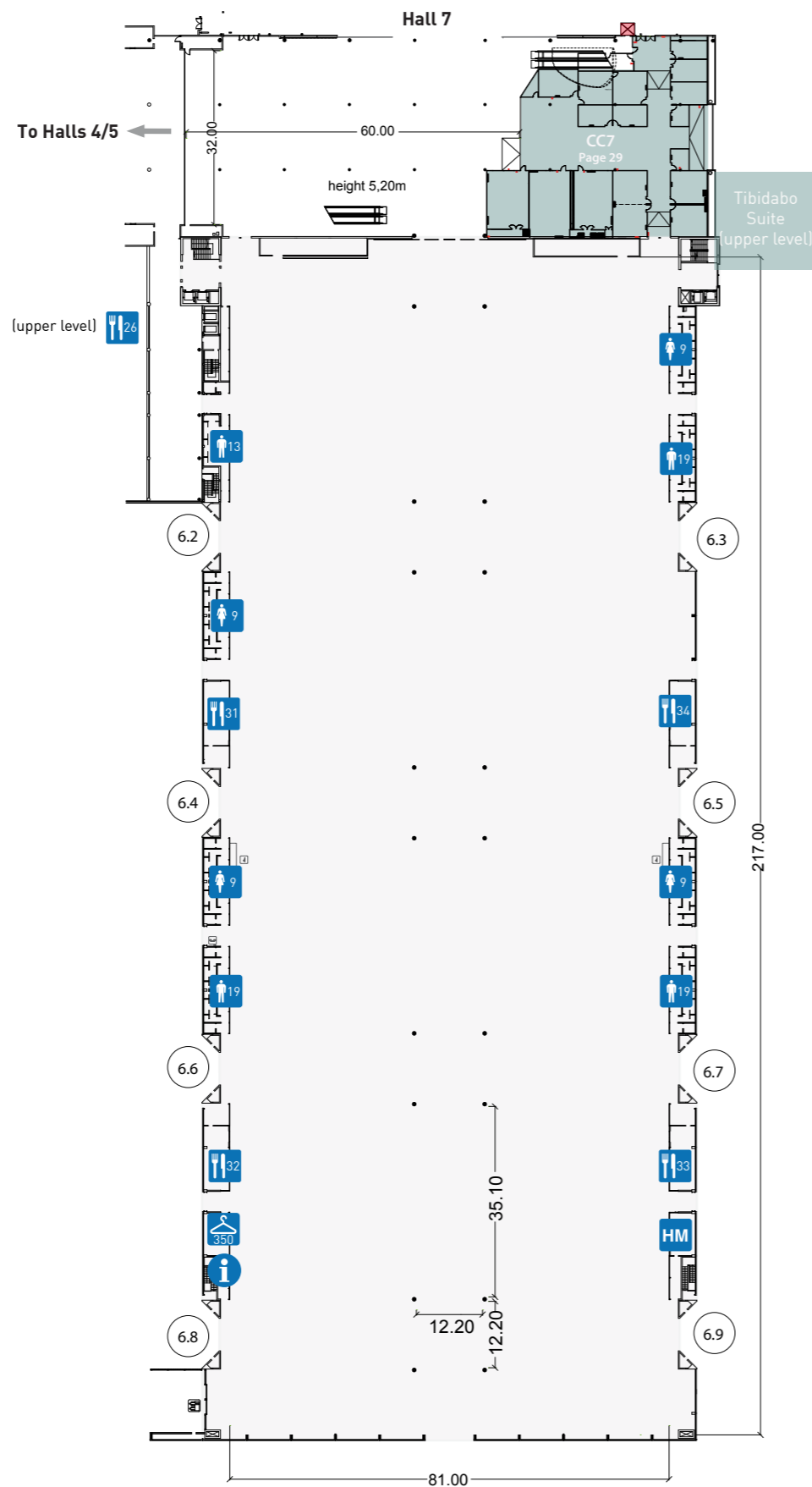
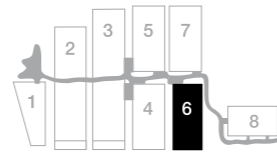

# TIBIDABO SUITE

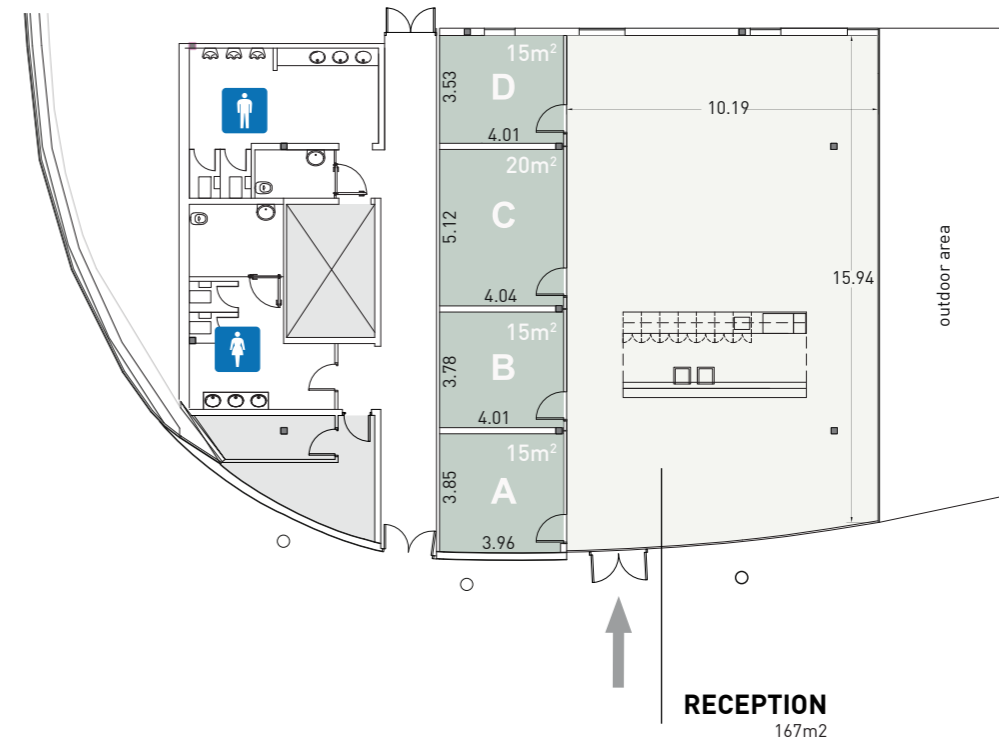
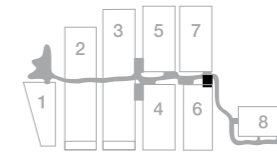

# PLENARY ROOM

## HALL 6

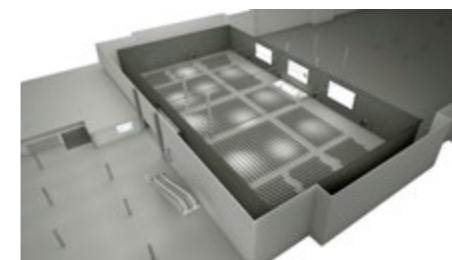

**Gross Surface** 3,400 sqm  
**Curtain height** 10 m

Permanent structure to build a temporary plenary room of 3,600 seats extendible to 5,600 seats



# HALL 7

Gross Surface	17,000 m <sup>2</sup>
Ground Resistance	3,000 kg/m <sup>2</sup>
Height	11 m

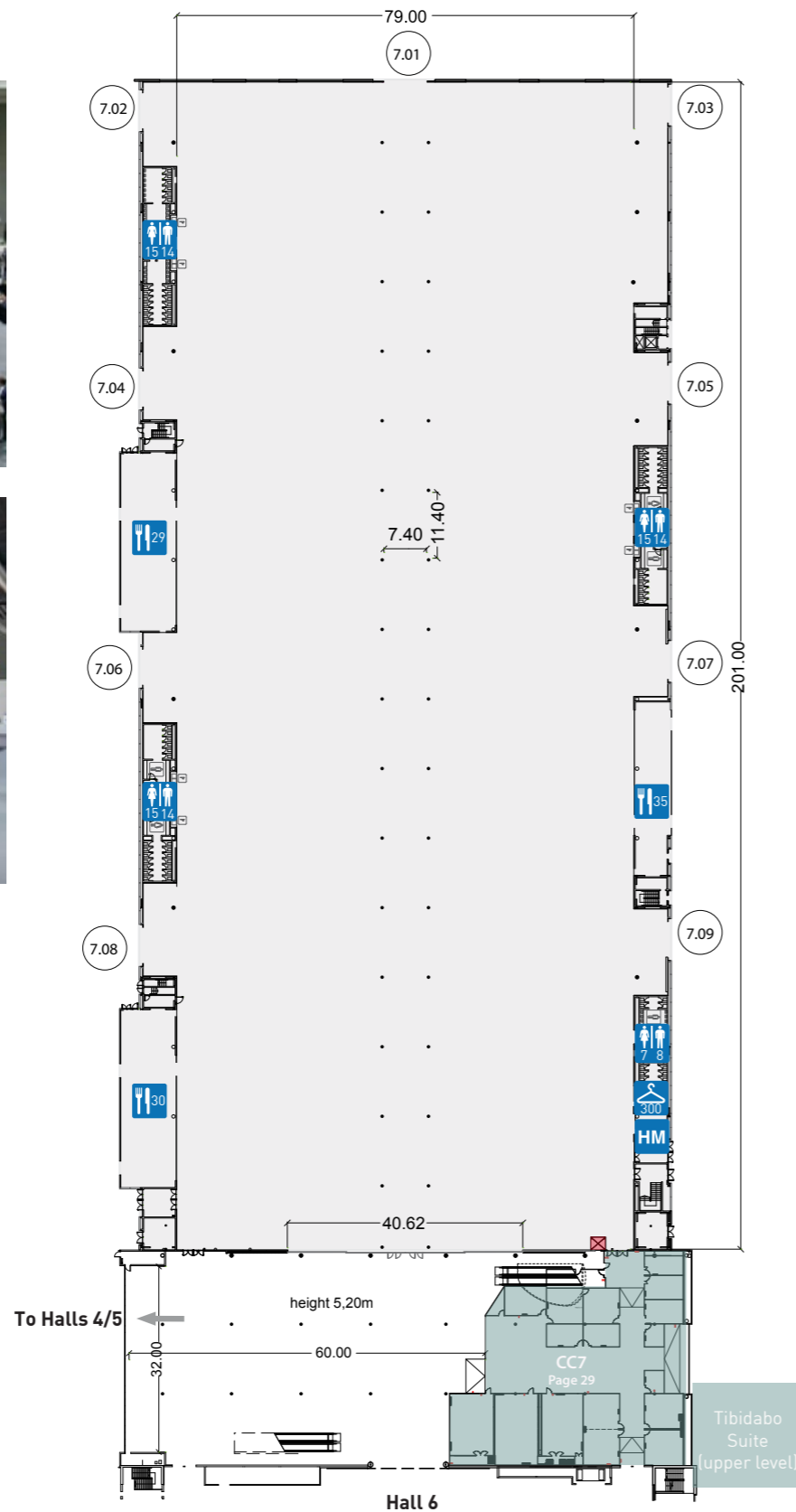
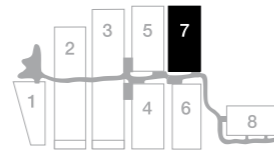

- Outlet
- Cloakroom
- WC
- Hall manager

### FOOD OUTLET CAPACITIES

	INDOORS	OUTDOORS
Outlet 29	100	140
Outlet 30	100	100
Outlet 35	80	140

# CONFERENCE CENTER 7

Room	Theatre	Classroom	U shape	Boardroom	
7.1 A + B + C	253m <sup>2</sup>	222	120	63	72
A	81m <sup>2</sup>	77	30	21	24
B	91m <sup>2</sup>	80	36	27	30
C	81m <sup>2</sup>	74	30	21	24
7.2 & 7.3	37m <sup>2</sup>	20/21	12	14	16
7.2 + 7.3	74m <sup>2</sup>	67	36	27	30
7.4 & 7.5	40m <sup>2</sup>	25	12	14	16
7.4 + 7.5	80m <sup>2</sup>	67	36	27	30
7.6 & 7.7	13m <sup>2</sup>	-	-	-	8
7.8 & 7.9	26m <sup>2</sup>	-	-	-	16
7.10	21m <sup>2</sup>	-	-	-	14
7.11	38m <sup>2</sup>	-	-	-	16
7.12	24m <sup>2</sup>	-	-	-	14
7.13	24m <sup>2</sup>	-	-	-	14
7.14	38m <sup>2</sup>	-	-	-	16
7.15	35m <sup>2</sup>	-	-	-	16

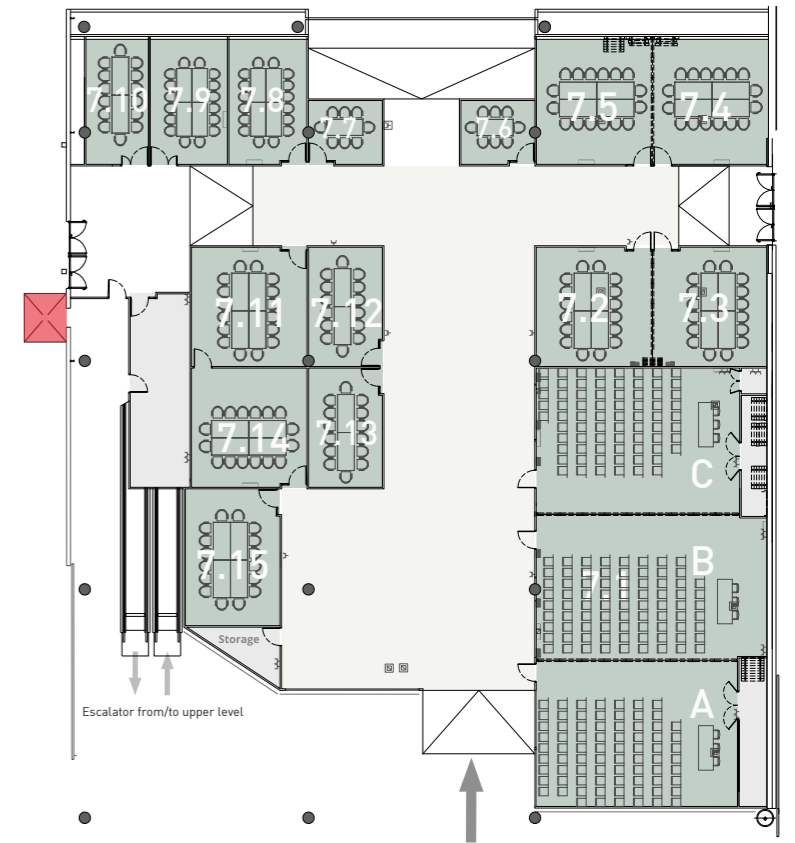
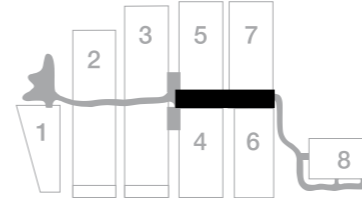

# LINK HALLS 4, 5, 6 and 7

Gross Surface	7,500 m <sup>2</sup>
Ground Resistance	1,000 kg/m <sup>2</sup>
Height	5,20 m

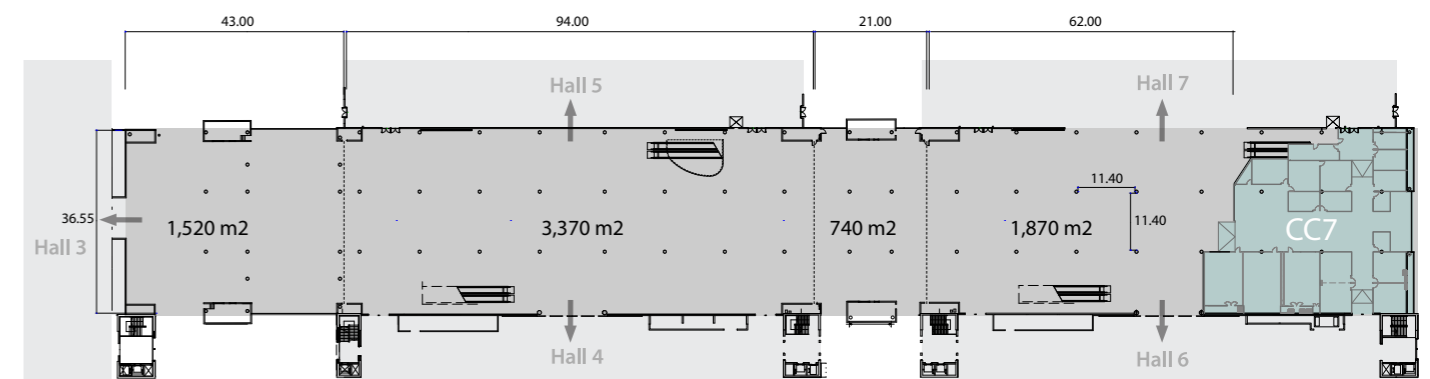





ast Food

Simple Wins Center

Simple.Mobile.Tools.

BLACKLINE

Deloitte



# HALL 8.1

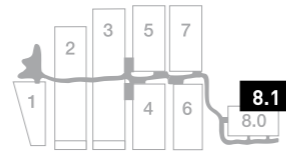

Gross Surface	12,700 m <sup>2</sup>
Exhibition Area	10,500 m <sup>2</sup>
Ground Resistance	1,500 kg/m <sup>2</sup>
Height	11 m

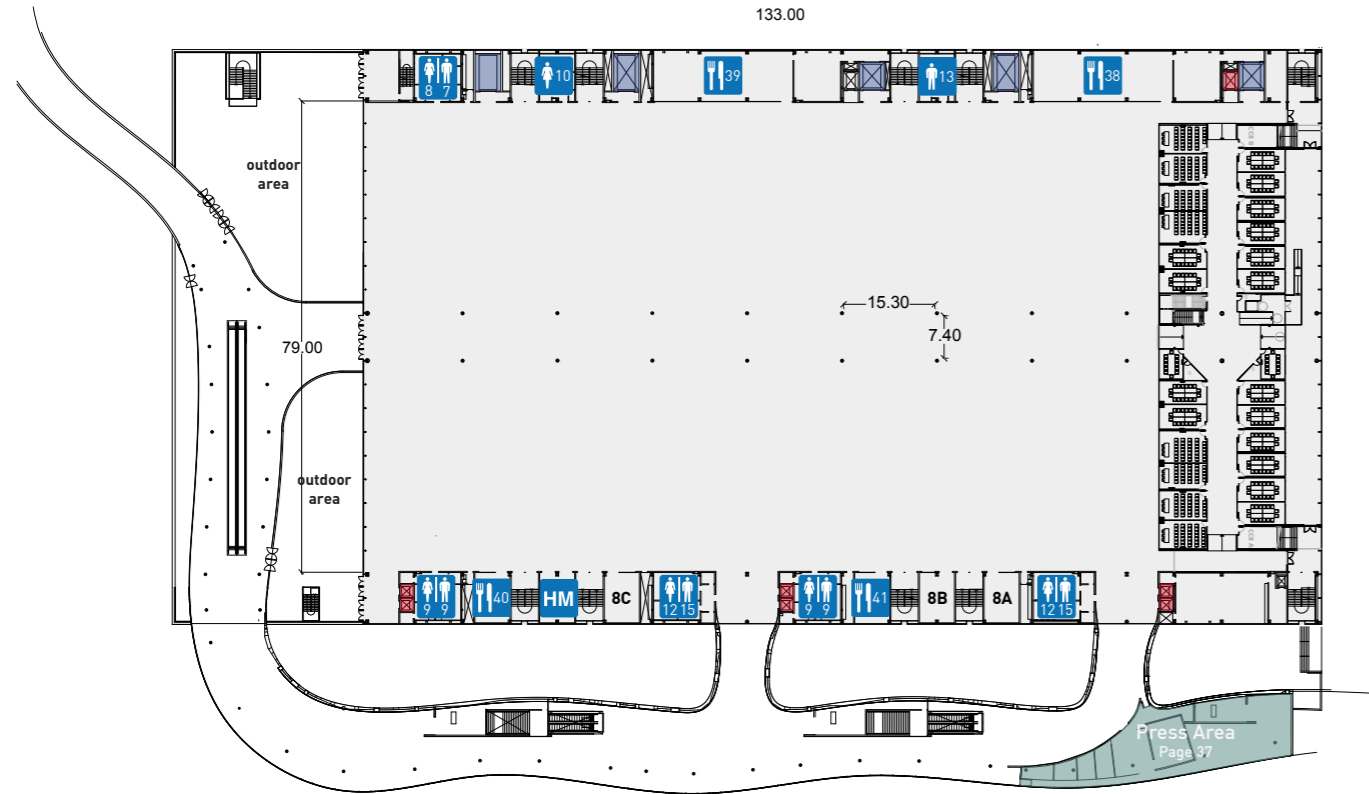

- Outlet
- WC
- Hall manager
- Goodslifts 3 units 6 ton  
2 units 4 ton

## FOOD OUTLET CAPACITIES

	INDOORS	OUTDOORS
Outlet 38	120	-
Outlet 39	120	-
Outlet 40	10	-
Outlet 41	10	-



# CONFERENCE CENTER 8

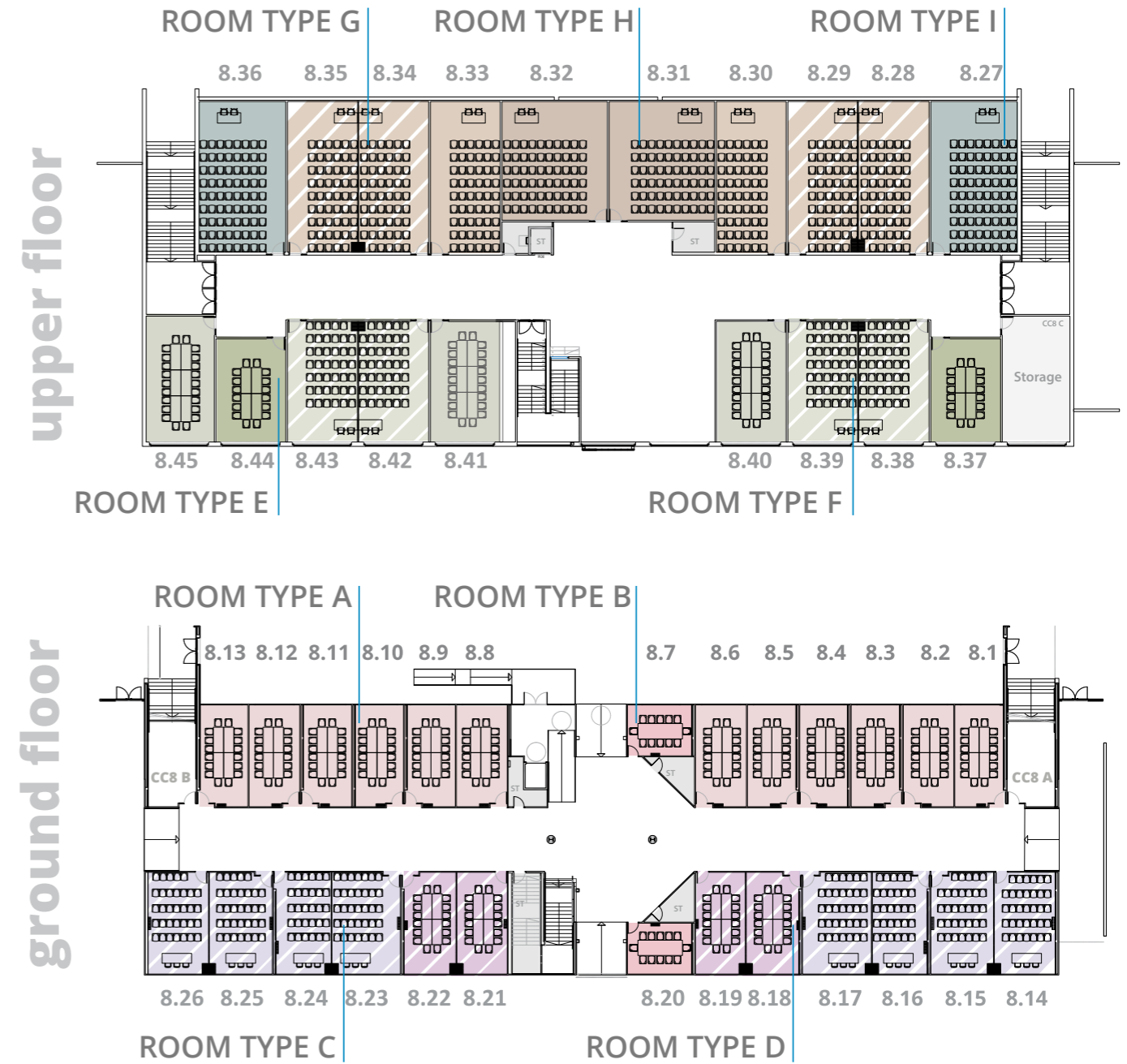
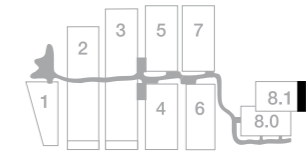

## Capacities

Room			
12 X	Type A	30 m <sup>2</sup>	16 pax boardroom
2 X	Type B	20 m <sup>2</sup>	12 pax boardroom
8 X	Type C	44 m <sup>2</sup>	29 pax theatre
all 8 can be merged into 4		Type C merged	78 m <sup>2</sup> 74 pax theatre
4 X	Type D	32 m <sup>2</sup>	29 pax theatre
all 4 can be merged into 2		Type D merged	64 m <sup>2</sup> 57 pax theatre
2 X	Type E	42 m <sup>2</sup>	16 pax boardroom
7 X	Type F	50 m <sup>2</sup>	22 pax boardroom
4 can be merged into 2		Type F merged	100 m <sup>2</sup> 96 pax theatre
6 X	Type G	63 m <sup>2</sup>	28 pax boardroom
4 can be merged into 2		Type G merged	127 m <sup>2</sup> 124 pax theatre
2 X	Type H	75 m <sup>2</sup>	84 pax theatre
2 X	Type I	80 m <sup>2</sup>	81 pax theatre



# HALL 8.0

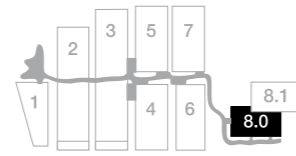

Gross Surface 13,800 m<sup>2</sup>  
 Ground Resistance 3,5000 kg/m<sup>2</sup>  
 Height 6.70 m

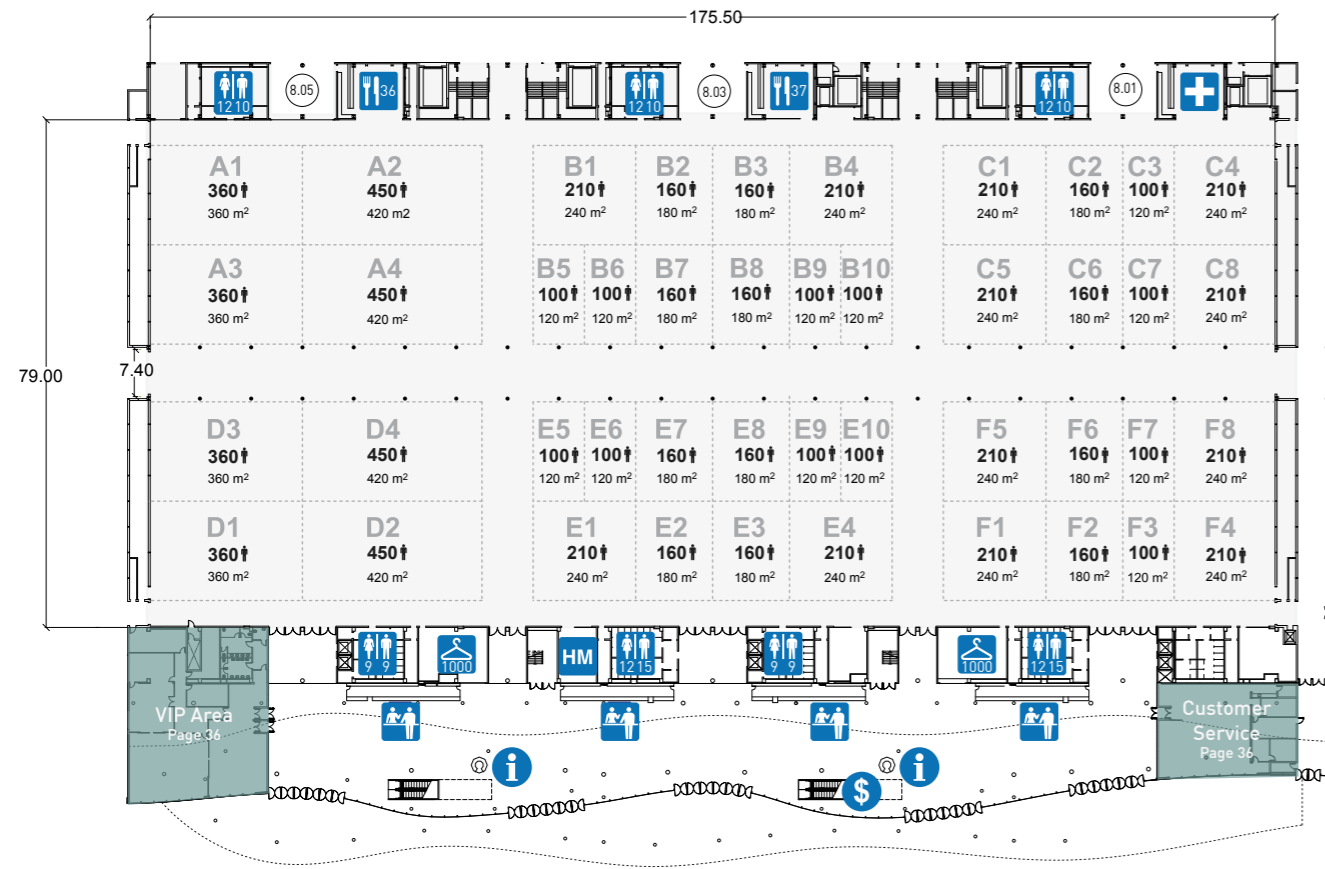

All possible divisions that can be created with the completely soundproof air wall system. Capacities of rooms differ from 2,500 to 100 seats in theatre style.

- Outlet
- Cloakroom
- WC
- Hall manager
- Info point
- ATM
- Registration counter
- First Aid

### FOOD OUTLET CAPACITIES

	INDOORS	OUTDOORS
Outlet 36	50	-
Outlet 37	50	-





# NORTH ACCESS

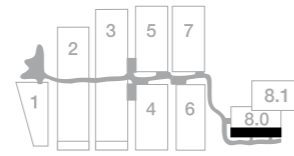

## LEVEL 0

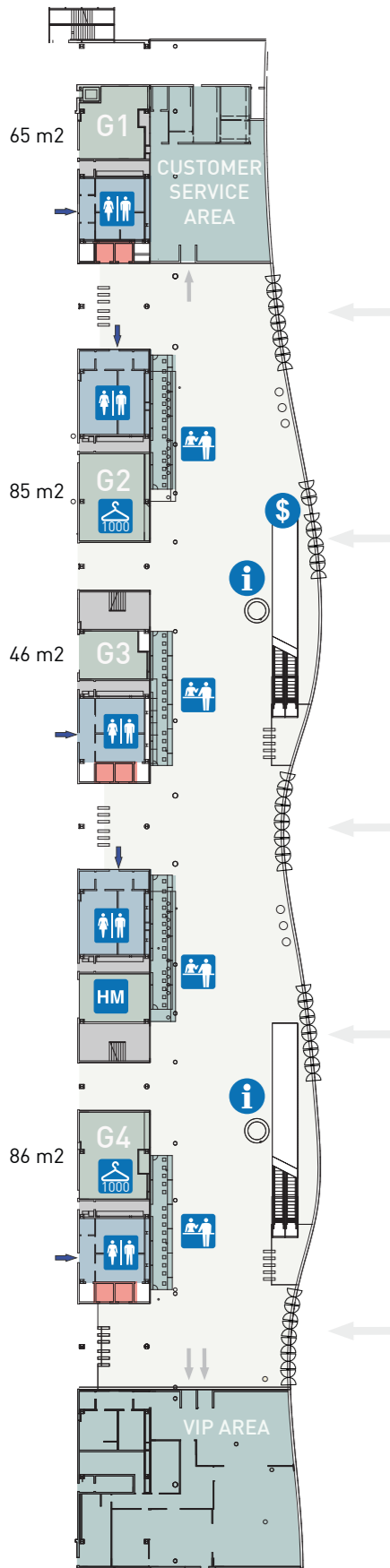

### CUSTOMER SERVICE AREA

300 m<sup>2</sup>

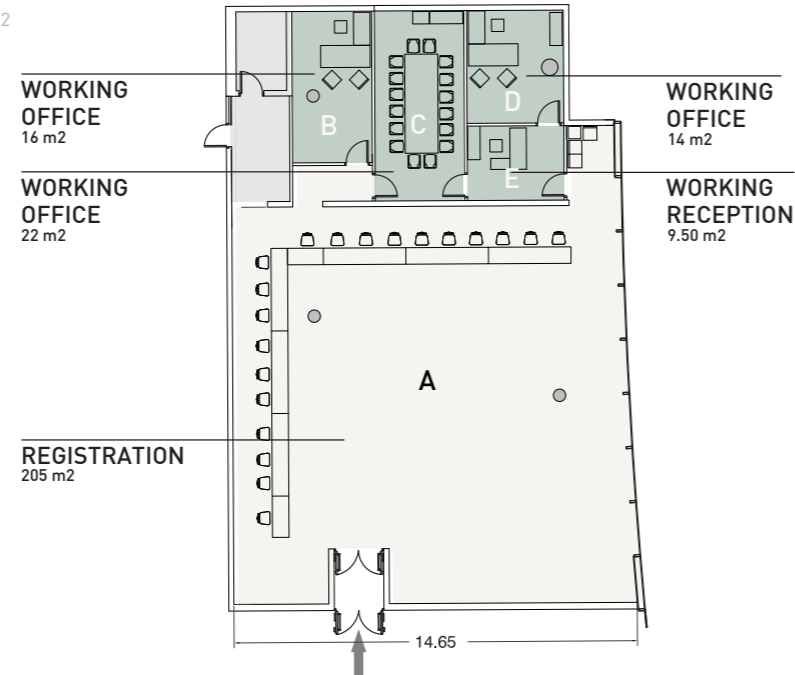

### VIP AREA

440 m<sup>2</sup>

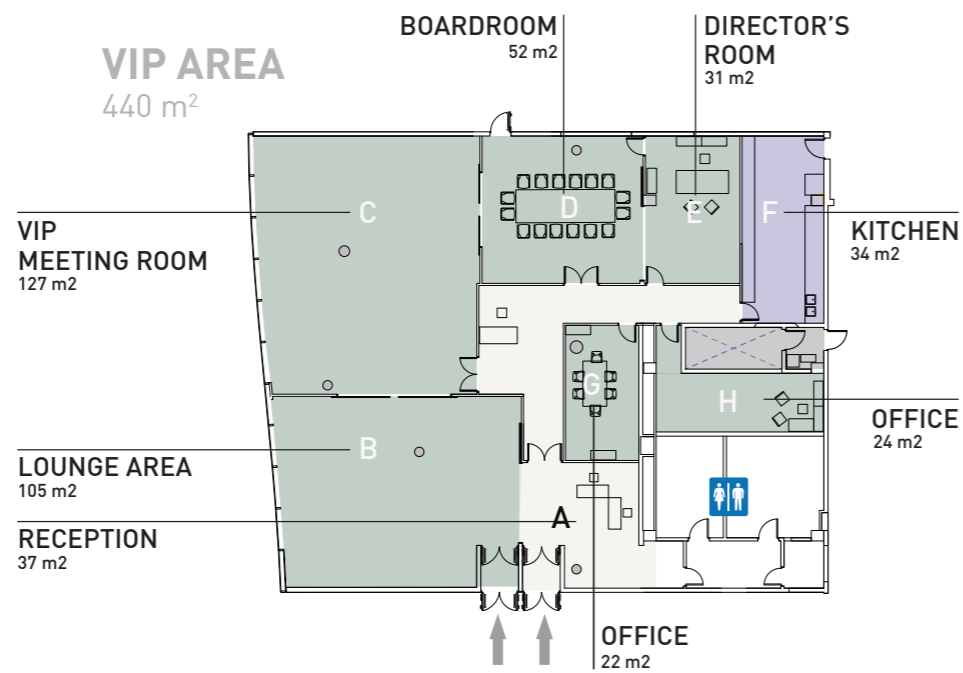

- WC
- Info point
- Registration counter
- Hall manager
- ATM

## LEVEL 1

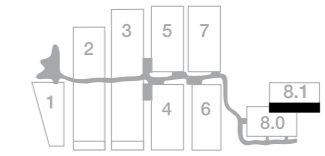
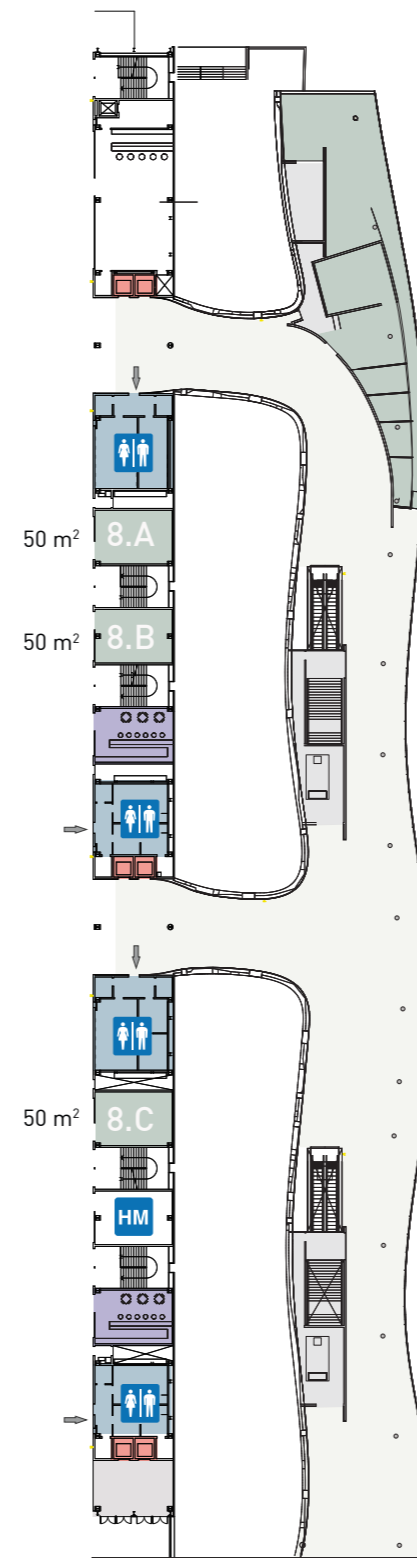

### PRESS AREA

370 m<sup>2</sup>

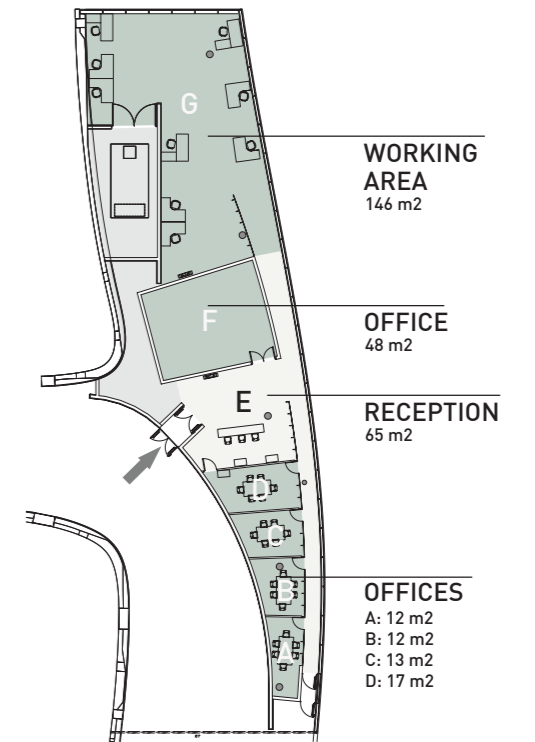



# SERVICES

Fira Barcelona is proud to introduce you to the professional services supplied by the venue together with our skillful partners. Along with its state-of-the-art venue and team, Fira Barcelona has a large and outstanding experience on organisers and exhibitors services. It can be as varied as audio-visuals, stand building, feature areas, deployment of internet, security, any possible services you might require: we have all suppliers needed and in complete synchrony.

We have established partnerships with a wide range of suppliers with long, proved and strong international experience.

Fira Barcelona coordinates and monitors all their services. The fact of being strategically positioned inside the venue gives them the advantage of providing the best service, know-how on the venue logistics, a very close relation with the operations team and having the team leader sitting very near the organiser's office during build up, show days and dismantling.



## DESIGN STANDS

CUSTOM-BUILT STAND: THE IDEAL FRAMEWORK FOR DOING BUSINESS

We are specialists in creating any space you can imagine. Complete support for stand design, construction, services and logistics through a single (and enthusiastic!) contact for all your requirements. A single contact from start to finish: total design, construction, services and logistics support for a customized project: utilities, catering, signage, plants, furniture, a/v support rigging, telecommunications, staffing, advertising...



## ONLINE ORDERING SYSTEM

A CUSTOMIZED E-COMMERCE WEBPAGE THAT ALLOWS YOU TO SELL EVEN MORE

At ServiFira, Fira's Exhibitor Service Department, we take care of everything to make sure your involvement in the event is a complete success. In doing so, we offer you the most comprehensive and innovative catalogue of exhibitor services on the market. If your exhibitor needs furniture, plants, internet connections, staff, these can be easily ordered through an e-commerce webpage adapted to your needs.



## CATERING SERVICES

A WORLD OF MOUTHWATERING EXPERIENCES

Fira Barcelona offers you the unique cuisine of Nucló Catering. Specialists to provide high-quality standards for any scale event, from coffee breaks to events with thousands of attendees, Nucló Catering unites a flawless service combined with incredible experiences. Mediterranean or International cuisine can be delivered at any space inside Fira and also at other emblematic spaces of the city.



## AV SOLUTIONS

POWERFUL PARTNERS TO BOOST YOUR EVENT WITH ALL RANGE OF AV EQUIPMENT

Our main objective is to offer a comprehensive service with the highest quality. Fira Barcelona's partners always wants to stay ahead in both planning and solutions. Customer and commitment oriented suppliers are able to deliver the best products available in the market with constant research of the latest releases. Our services range from design and planning to the technical production and final execution of the project, supplying technical professional video equipment, computers, sound, lighting and translation.



## OTHER SERVICES

ANYTHING YOU NEED

We can also offer event-related services such as carpet, rigging services, signage and advertising, design companies for feature areas, shell scheme stands and also support staff as hostesses, security and cleaning. Fira Barcelona boasts a series of highly-qualified teams to cover every possible requirement of an event. From the ICT or Catering to Exhibitor Services Department, Fira Barcelona puts everything in gear to ensure the success of every event.



[www.firabarcelona-guestevents.com](http://www.firabarcelona-guestevents.com)

January 2022





**Fira Barcelona**

[guestevents@firabarcelona.com](mailto:guestevents@firabarcelona.com)

[www.firabarcelona-guestevents.com](http://www.firabarcelona-guestevents.com)

+34 93 233 20 00