

Link between Halls 4, 5 6 and 7

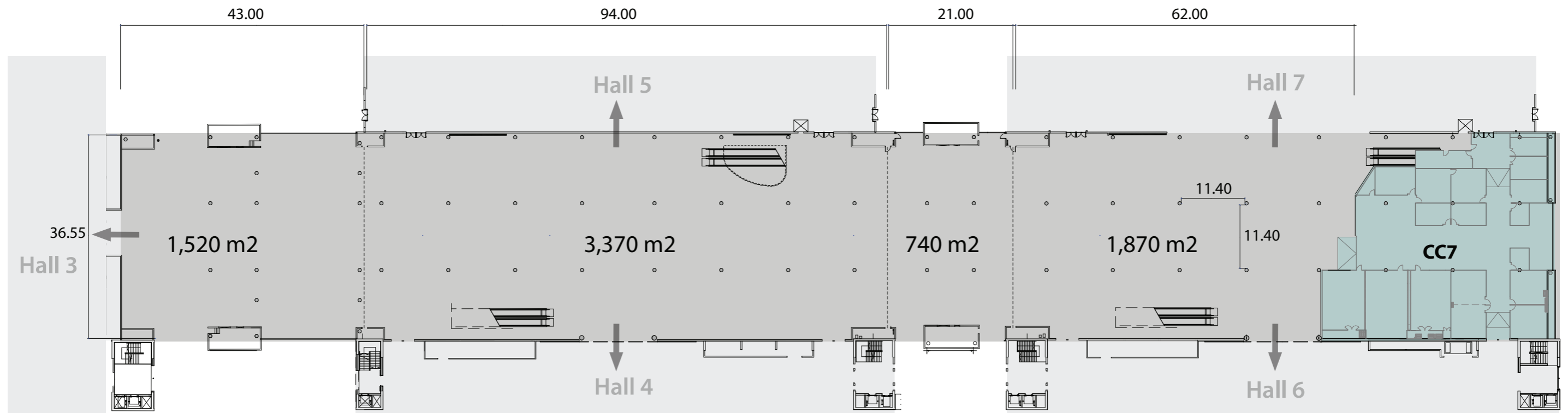

height: 5,50m
ground resistance 5,000 kg/m²

Link between Halls 4, 5 6 and 7

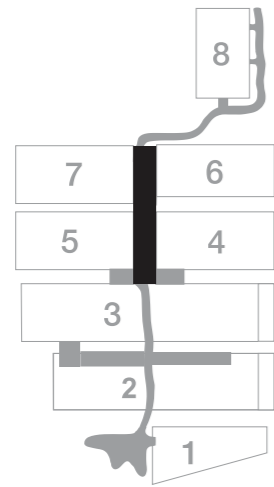
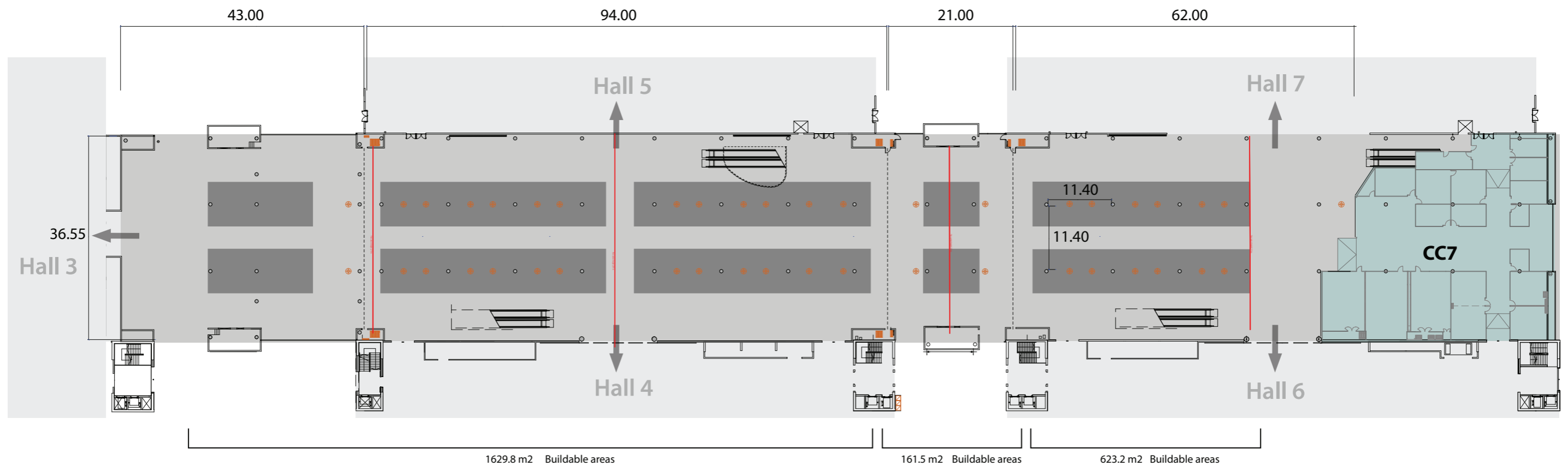
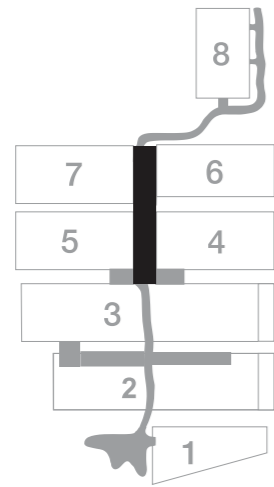

1629.8 m2 Buildable areas 161.5 m2 Buildable areas 623.2 m2 Buildable areas

- Buildable areas
- Fire curtain.
In case of fire, it lowers to a height of 2,50m from the floor. All constructions below a fire curtain need to have this into consideration.
- Service chests

height: 5,50m
ground resistance 5,000 kg/m2