

# Conference Center 4 - Room 4.4

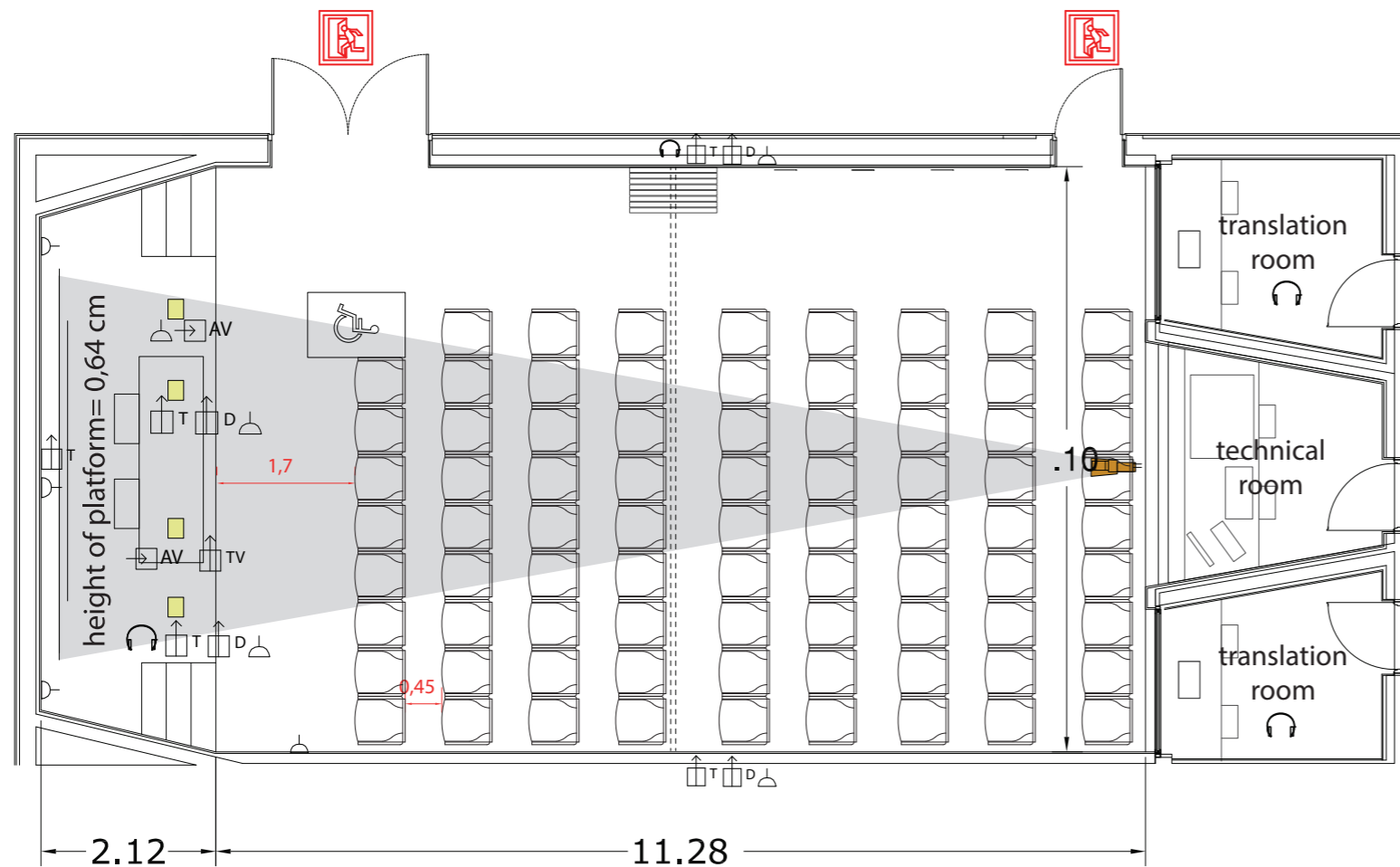

option for dividing the room in two:

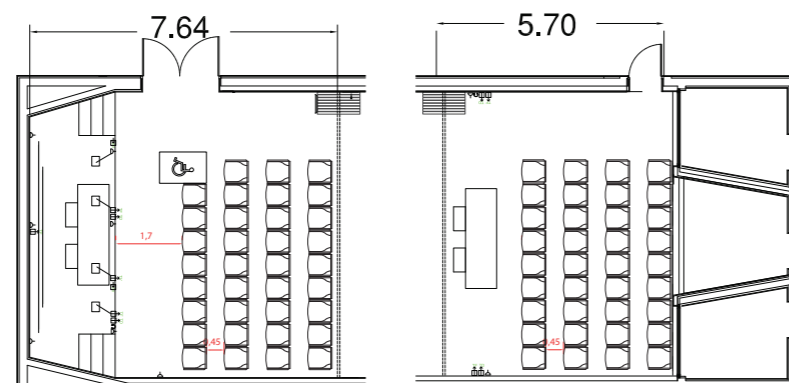

AV installed in the room: PA System, 2 translation booths, Screen 420 X 315cm, projection size 266 X 200 (4:3) or 355 X 200 (16:9), projector 6000 HD, HDMI input. 4 lectern/table mics, 1 wireless mic (handheld or headset), PC laptop, laser presenter. The AV technician is not included. Contact our team for a quote.

\*\*Use of translation cabin: the connections and digital desk are included in the room, but if you require to use the translation room, please contact our team for a quote of translation headphones and receivers.

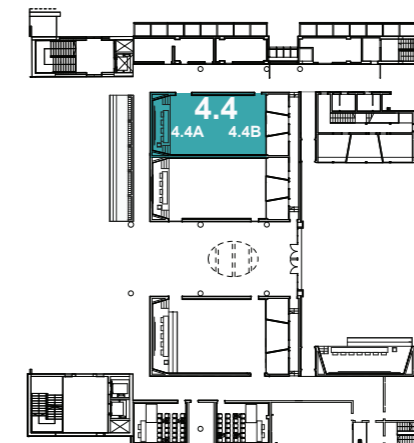

93,81 sqm (54,16 sqm + 40,47 sqm)  
 Room height : 4,25m  
 Screens : 1

- Emergency exit
- Fire extinguisher
- Built-in floor box
- Video connection
- Projector
- Sound connection
- Telephone line
- Data/internet line
- TV/antenna line
- Power socket

The default layout of the room is theatre style. If you wish to have a different layout, please contact our team (for a quote).

| ROOM CAPACITY |                   |               |                 |              |               |
|---------------|-------------------|---------------|-----------------|--------------|---------------|
|               |                   |               |                 |              |               |
| Theatre<br>80 | Classroom**<br>36 | U shape<br>24 | Boardroom<br>30 | Banquet<br>- | Cocktail<br>- |
| or 36 + 36    |                   |               |                 |              |               |

\*\*Room furnished with tablet arm chairs.