

# COLUMNS DETAILS

## Gran Via

Hall 1	C101 to C105	page 3
Hall 2	C201 to C211	page 9
Hall 3	C301 to C305	page 21
Hall 4	C401 to C405	page 26
Hall 5	C501 to C505	page 30
Hall 6	C601 to C605	page 36
Hall 7	C701 to C705	page 41
Underwalkway	CU01 to CU04	page 47
Hall 8.0	C8001 to C8005	page 52
Hall 8.1	C8101 to C8105	page 58



# INSTRUCTIONS

Please check the floorplans to locate each column type name.

Columns are named as

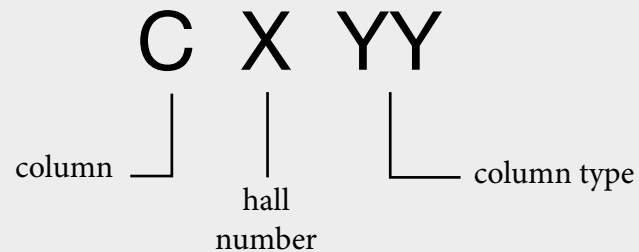

## Technical constraints

No construction elements can be supported by or onto walls, columns or other fixed elements of the halls, and adequate protection must be used or a safe distance must be maintained between the construction materials and the hall walls. In no case should the stability of any object, assembly or structure be conditioned to the infrastructure of Fira de Barcelona. All elements must be self-supporting and self-standing.

Hall columns inside the stand can be cladded without damaging them and in accordance with the permitted height regulations, taking into account the fact that, in the case of connection boxes, these boxes can always be registered. Vinyl columns can only be installed by official Fira suppliers. This service can be contracted through the sales department of Fira Barcelona ([www.servifira.com](http://www.servifira.com))

In the case of cladding or decorating columns with fire equipment, extinguishers, fire alarm call points, signage or any other informational element of the venue, they must always be visible and accessible. They cannot be manipulated nor broken down.

## Cladding policy

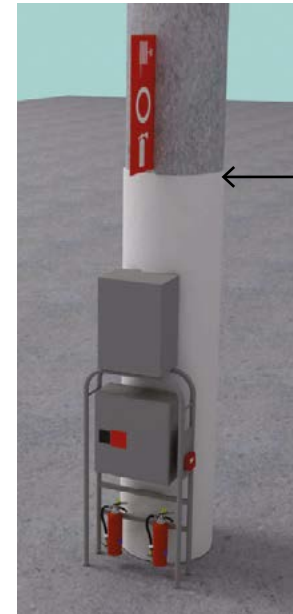

A vinyl can reach up to the upper fire signage

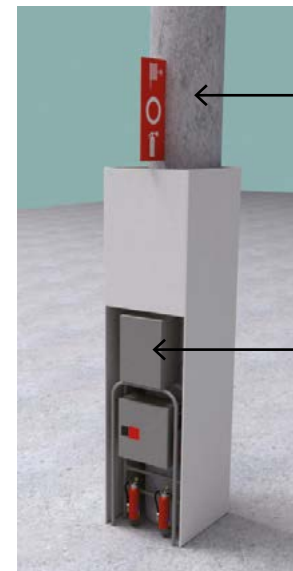

The cladding cannot cover the upper signage

Some of the fire equipment in Halls 3, 4 and 6 include fixed switchboards. These columns are marked with the letter *b* after the type name. The switchboards can be cladded but need to remain accessible during build up and dismantling to other exhibitors.

## HALL 1 Floorplan

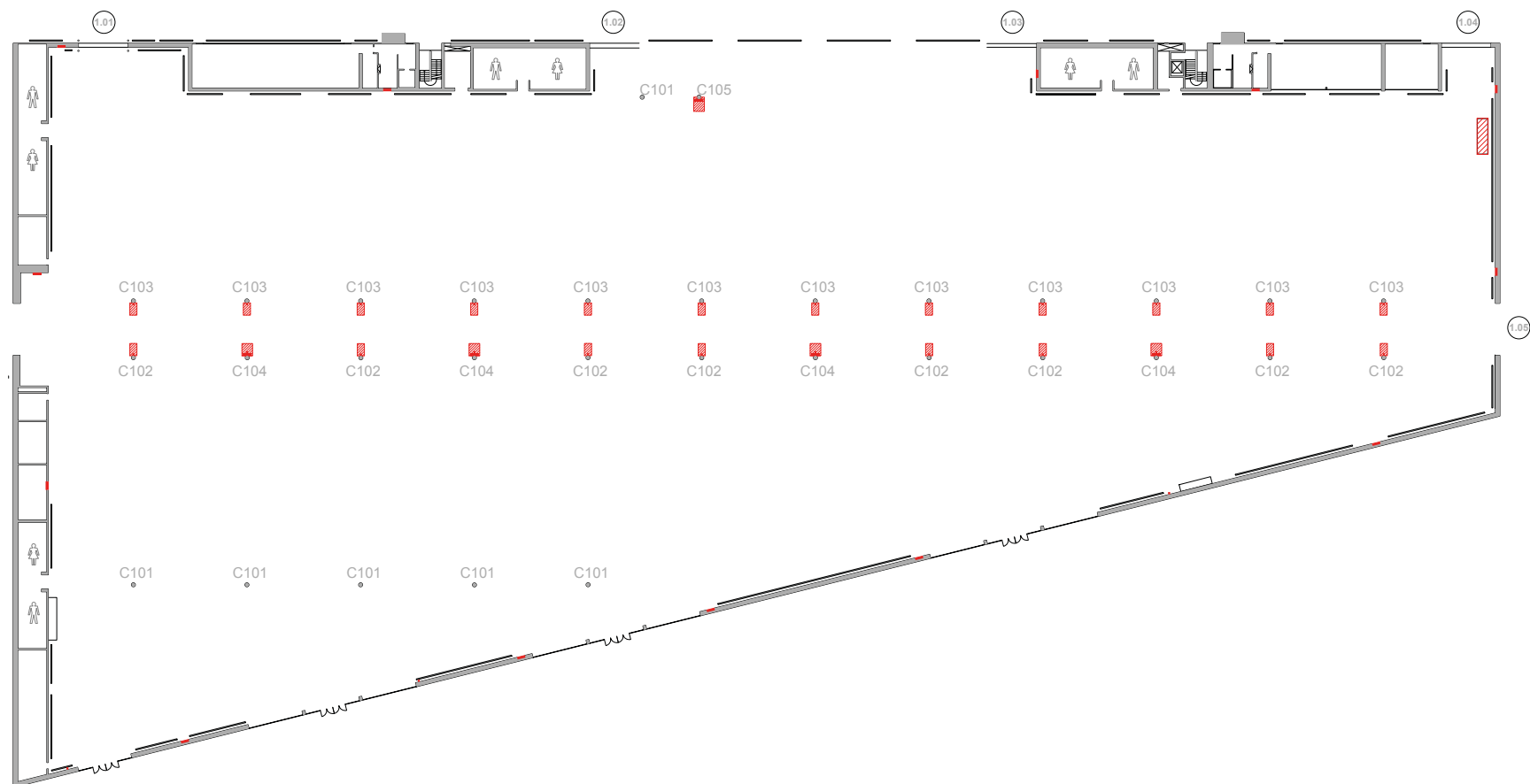

# Column details - Gran Via Hall 1

## Column type C101

### Floorplan & Dimensions

---

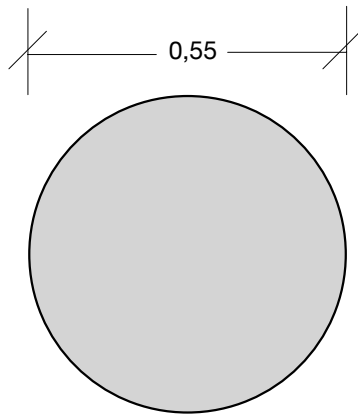

### Picture

---



The current document only provides guidance on venue technical information for organisers.

When designing specific areas or booth spaces please always refer to the technical hall DWG available for download at this website.

# Column details - Gran Via Hall 1

## Column type C102

### Floorplan & Dimensions

main central aisle

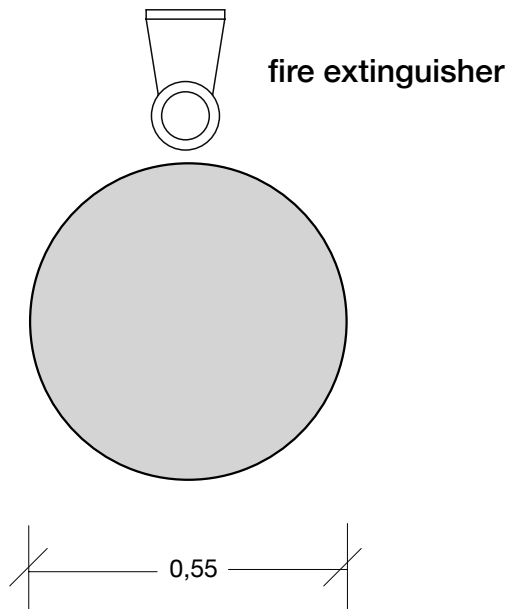

The current document only provides guidance on venue technical information for organisers.

When designing specific areas or booth spaces please always refer to the technical hall DWG available for download at this website.

### Picture

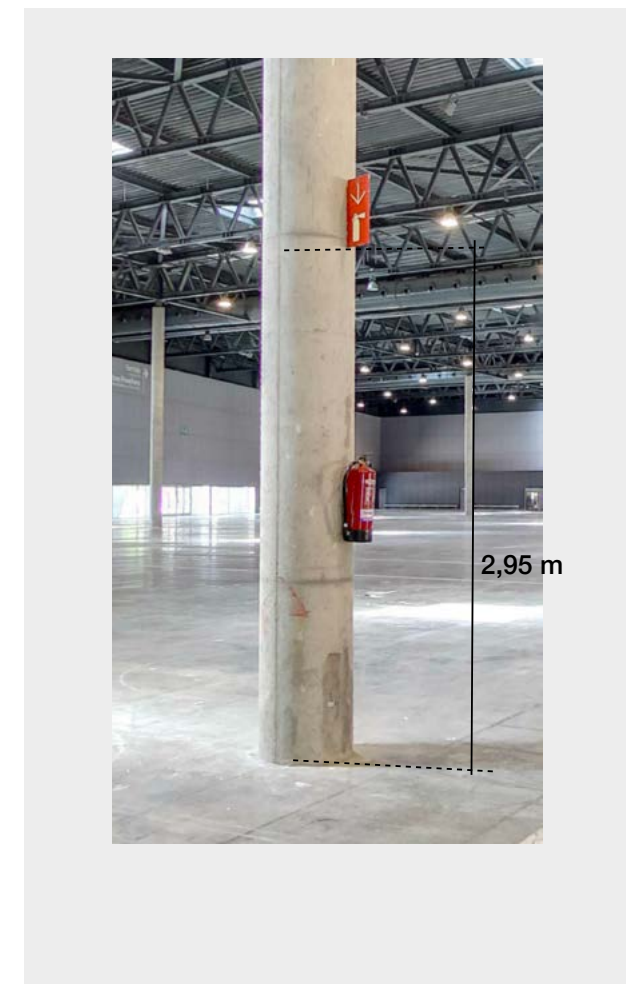

# Column details - Gran Via Hall 1

## Column type C103

### Floorplan & Dimensions

---

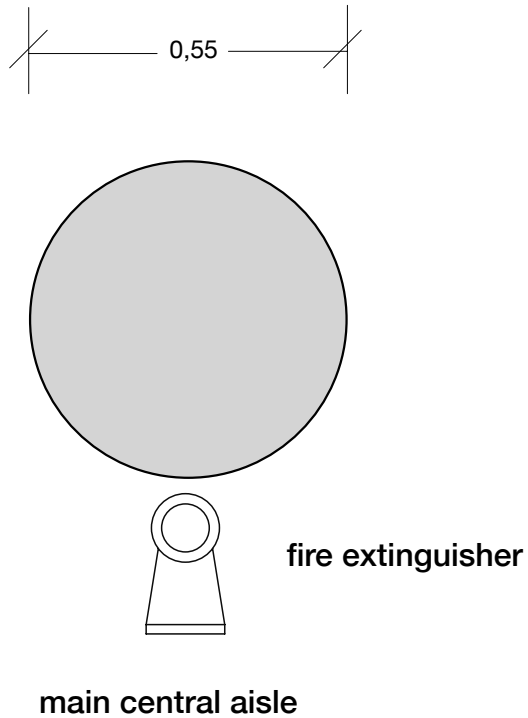

### Picture

---



The current document only provides guidance on venue technical information for organisers.

When designing specific areas or booth spaces please always refer to the technical hall DWG available for download at this website.

# Column details - Gran Via Hall 1

## Column type C104

### Floorplan & Dimensions

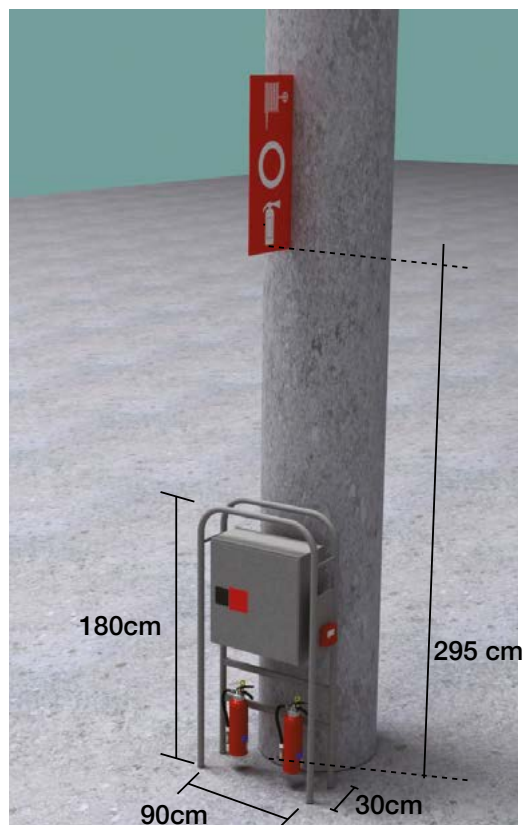
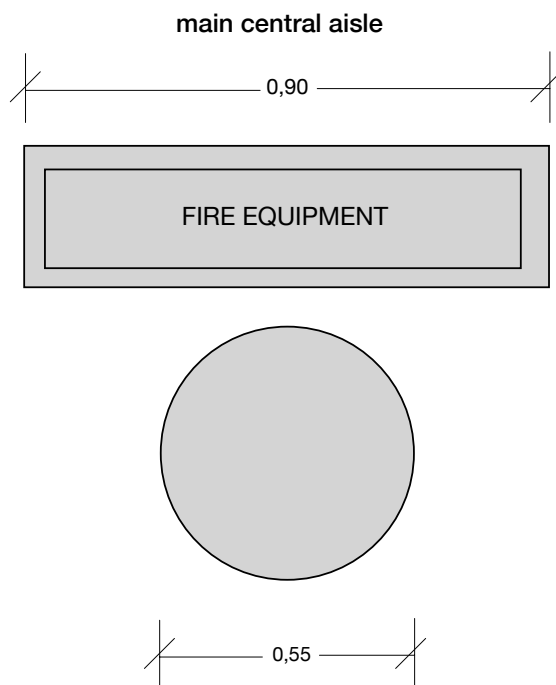

Note that the fire extinguisher equipment and sign need to remain accessible and visible at all times.

### Picture



The current document only provides guidance on venue technical information for organisers.

When designing specific areas or booth spaces please always refer to the technical hall DWG available for download at this website.

# Column details - Gran Via Hall 1

## Column type C105

### Floorplan & Dimensions

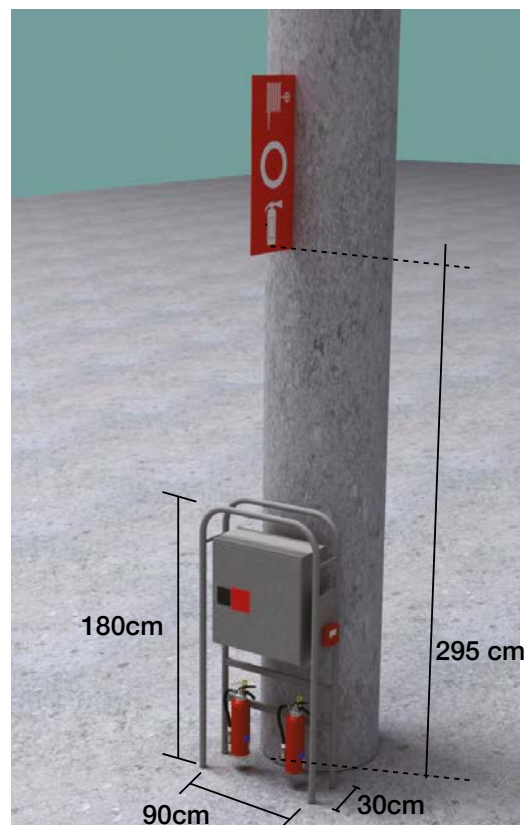
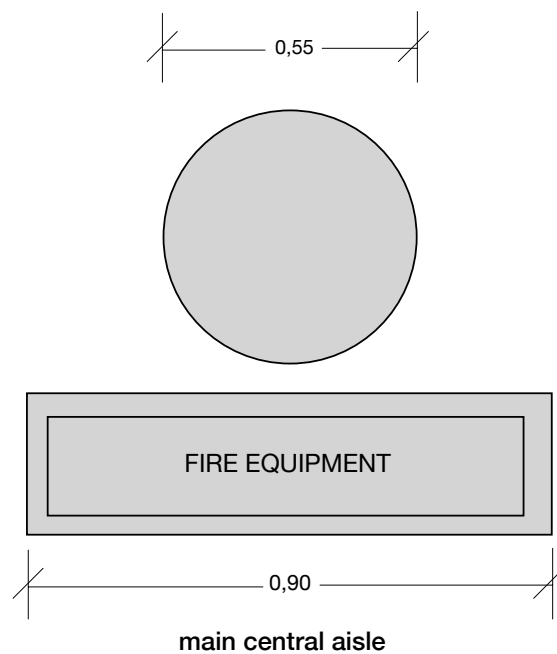

Note that the fire extinguisher equipment and sign need to remain accessible and visible at all times.

### Picture



The current document only provides guidance on venue technical information for organisers.

When designing specific areas or booth spaces please always refer to the technical hall DWG available for download at this website.



# HALL 2 Floorplan

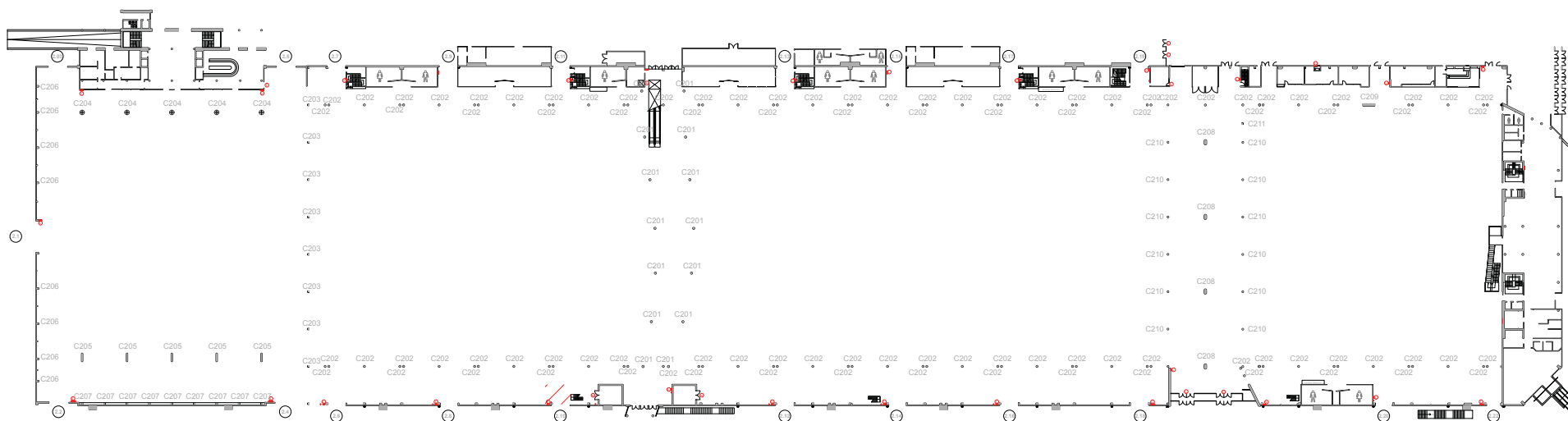

The current document only provides guidance on venue technical information for organisers.

When designing specific areas or booth spaces please always refer to the technical hall DWG available for download at this website.

# Column details - Gran Via Hall 2

## Column type C201

### Floorplan & Dimensions

---

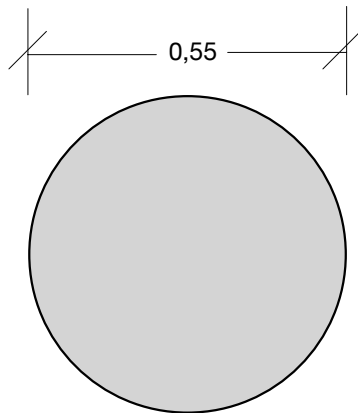

### Picture

---



The current document only provides guidance on venue technical information for organisers.

When designing specific areas or booth spaces please always refer to the technical hall DWG available for download at this website.

# Column details - Gran Via Hall 2

## Column type C202

### Floorplan & Dimensions

Single

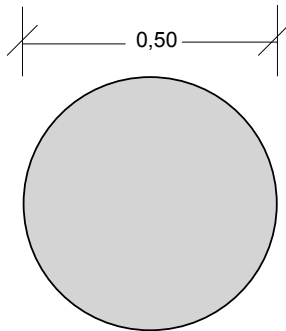

Double

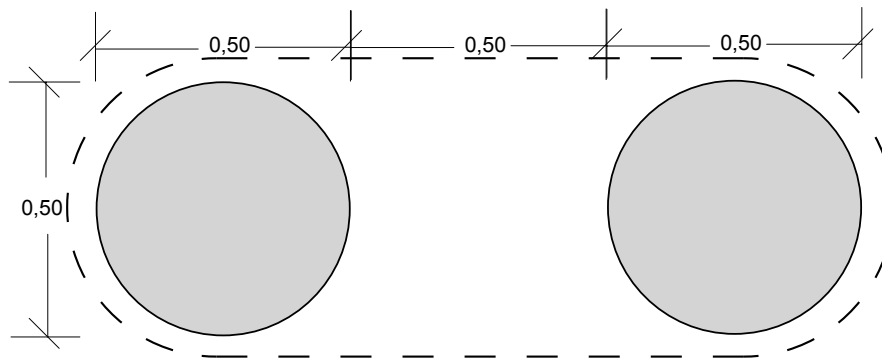

The current document only provides guidance on venue technical information for organisers.

When designing specific areas or booth spaces please always refer to the technical hall DWG available for download at this website.

### Picture

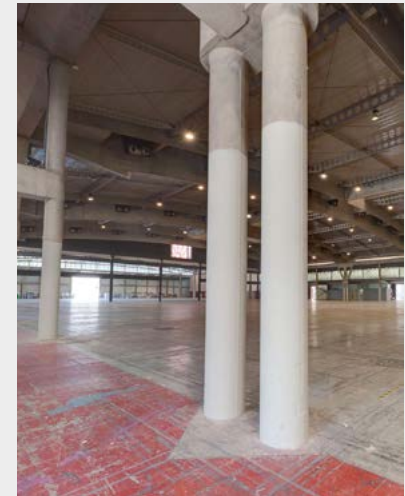

# Column details - Gran Via Hall 2

## Column type C203

### Floorplan & Dimensions

---

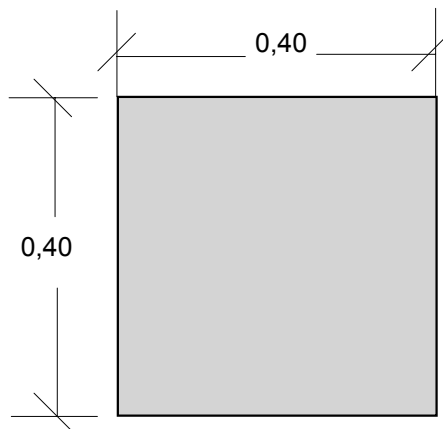

### Picture

---

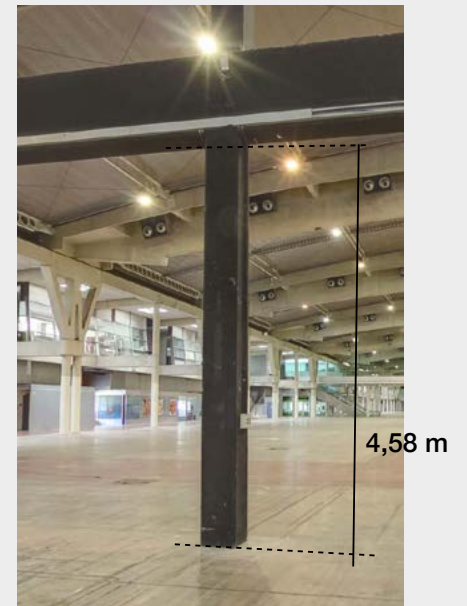

The current document only provides guidance on venue technical information for organisers.

When designing specific areas or booth spaces please always refer to the technical hall DWG available for download at this website.



# Column details - Gran Via Hall 2

## Column type C204

### Floorplan & Dimensions

---

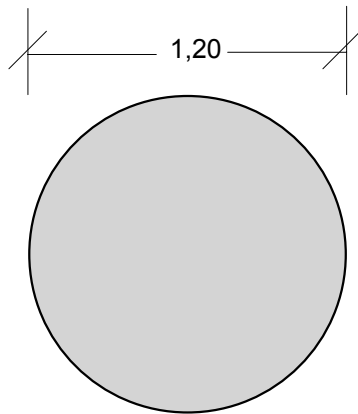

### Picture

---



The current document only provides guidance on venue technical information for organisers.

When designing specific areas or booth spaces please always refer to the technical hall DWG available for download at this website.

# Column details - Gran Via Hall 2

## Column type C205

### Floorplan & Dimensions

---

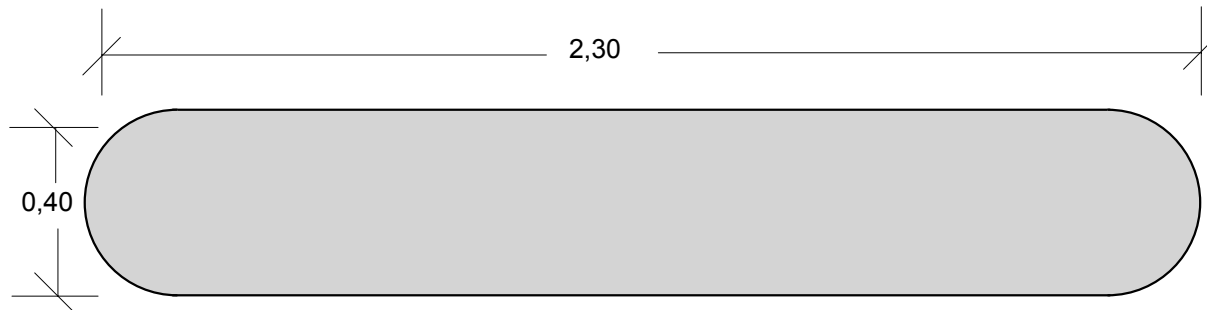

### Picture

---



The current document only provides guidance on venue technical information for organisers.

When designing specific areas or booth spaces please always refer to the technical hall DWG available for download at this website.

# Column details - Gran Via Hall 2

## Column type C206

### Floorplan & Dimensions

---

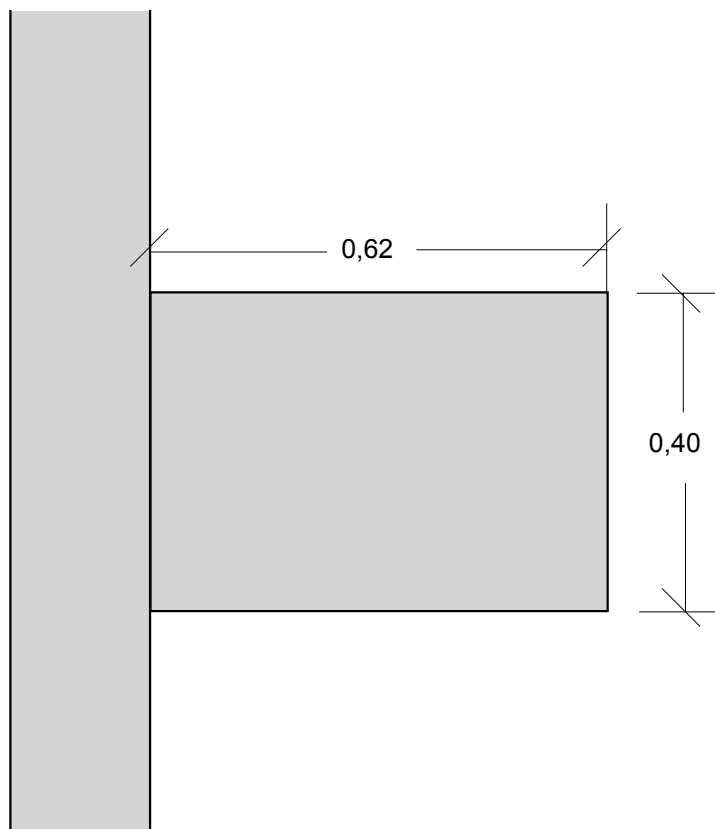

The current document only provides guidance on venue technical information for organisers.

When designing specific areas or booth spaces please always refer to the technical hall DWG available for download at this website.

### Picture

---

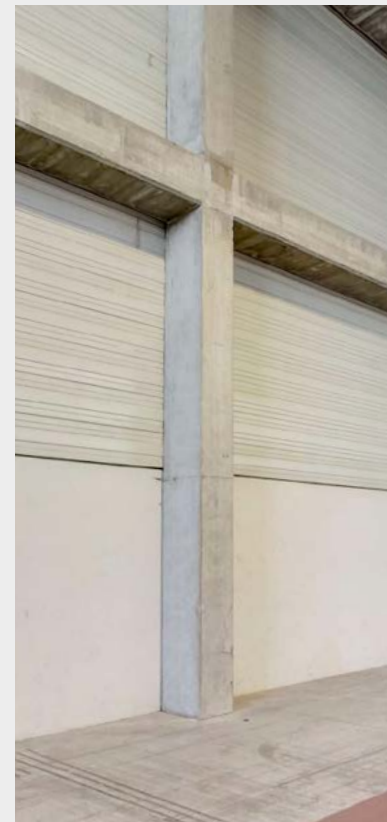

# Column details - Gran Via Hall 2

## Column type C207

### Floorplan & Dimensions

---

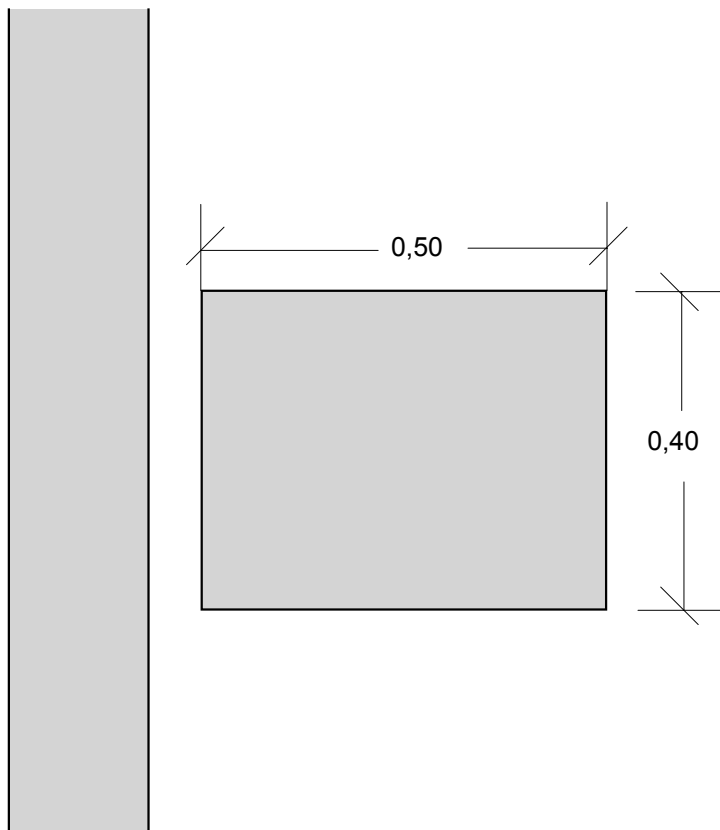

### Picture

---



The current document only provides guidance on venue technical information for organisers.

When designing specific areas or booth spaces please always refer to the technical hall DWG available for download at this website.



# Column details - Gran Via Hall 2

## Column type C208

### Floorplan & Dimensions

---

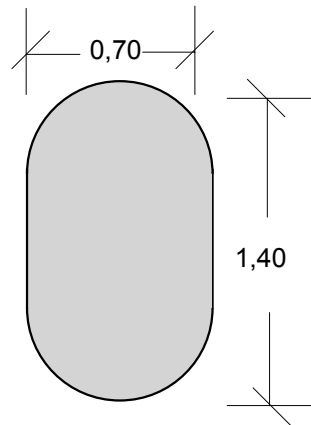

### Picture

---

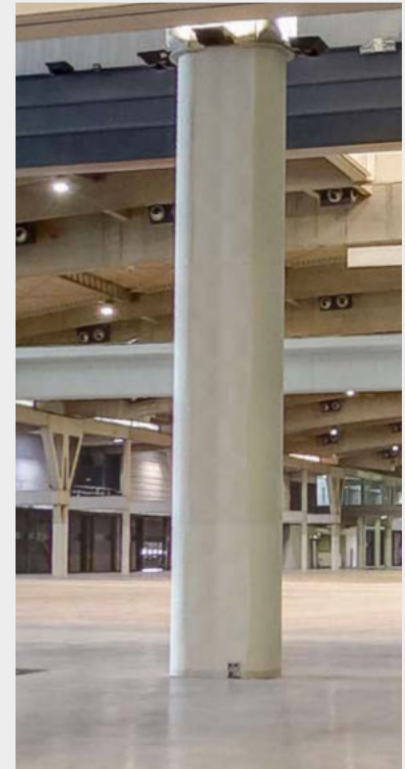

The current document only provides guidance on venue technical information for organisers.

When designing specific areas or booth spaces please always refer to the technical hall DWG available for download at this website.

# Column details - Gran Via Hall 2

## Column type C209

### Floorplan & Dimensions

---

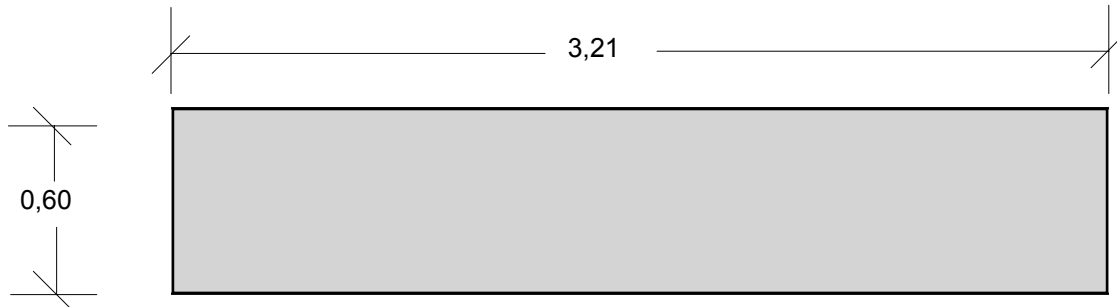

### Picture

---



The current document only provides guidance on venue technical information for organisers.

When designing specific areas or booth spaces please always refer to the technical hall DWG available for download at this website.

# Column details - Gran Via Hall 2

## Column type C210

### Floorplan & Dimensions

---

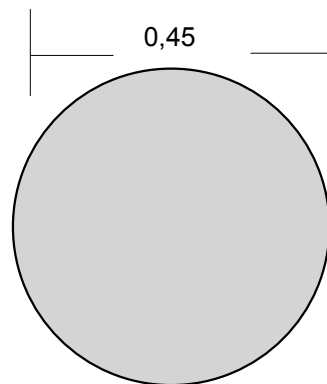

### Picture

---

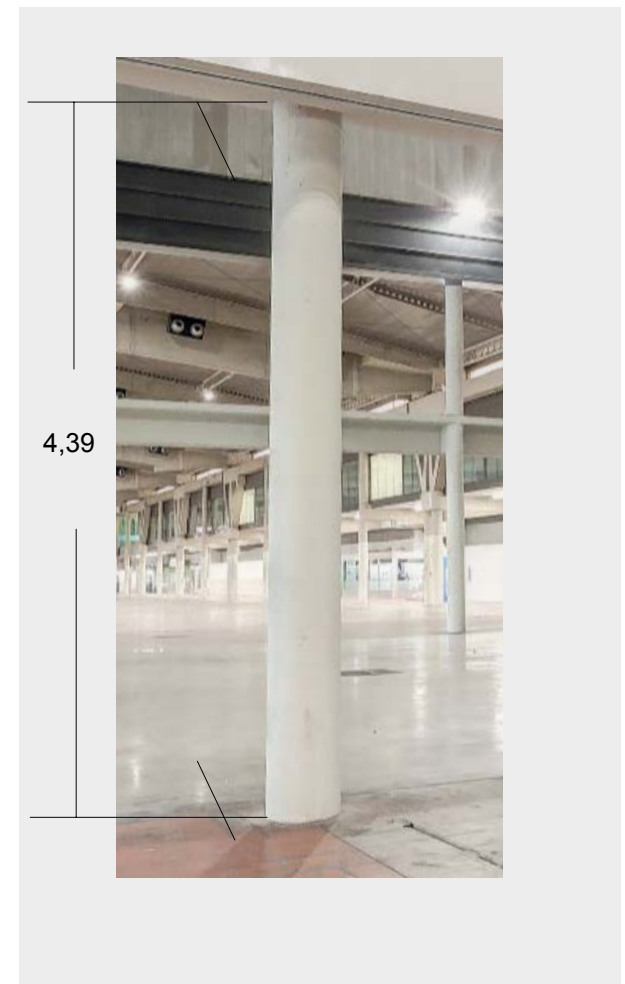

The current document only provides guidance on venue technical information for organisers.

When designing specific areas or booth spaces please always refer to the technical hall DWG available for download at this website.

# Column details - Gran Via Hall 2

## Column type C211

### Floorplan & Dimensions

---

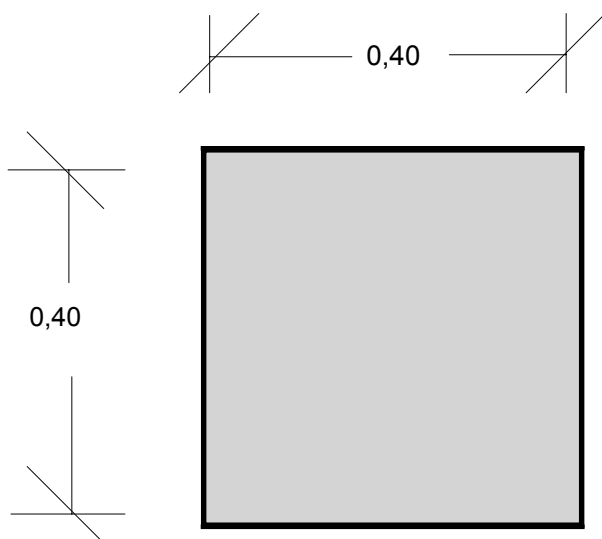

### Picture

---



The current document only provides guidance on venue technical information for organisers.

When designing specific areas or booth spaces please always refer to the technical hall DWG available for download at this website.



# HALL 3

## Floorplan

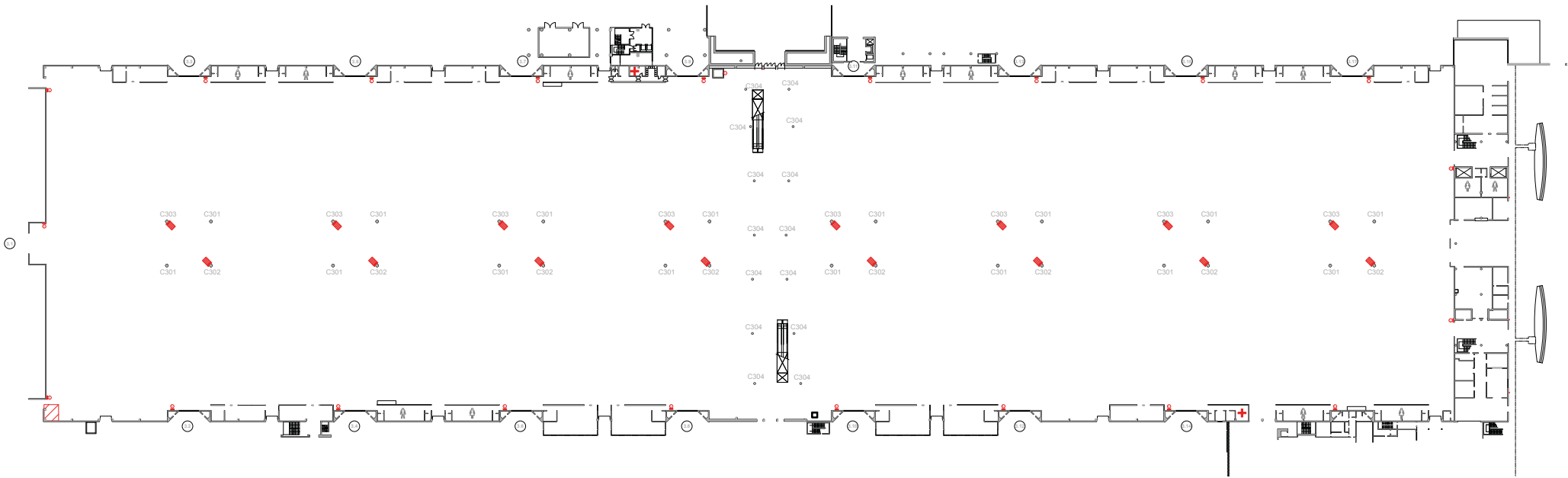

The current document only provides guidance on venue technical information for organisers.

When designing specific areas or booth spaces please always refer to the technical hall DWG available for download at this website.

# Column details - Gran Via Hall 3

## Column type C301

### Floorplan & Dimensions

---

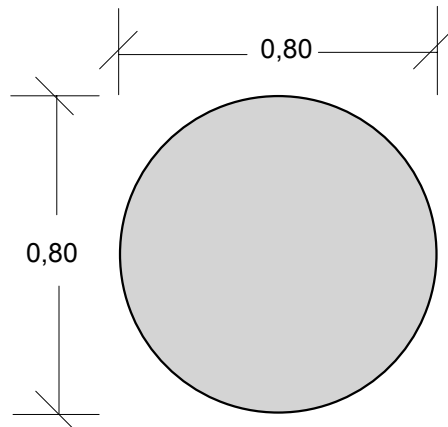

### Picture

---



The current document only provides guidance on venue technical information for organisers.

When designing specific areas or booth spaces please always refer to the technical hall DWG available for download at this website.

# Column details - Gran Via Hall 3

## Column type C302

### Floorplan & Dimensions

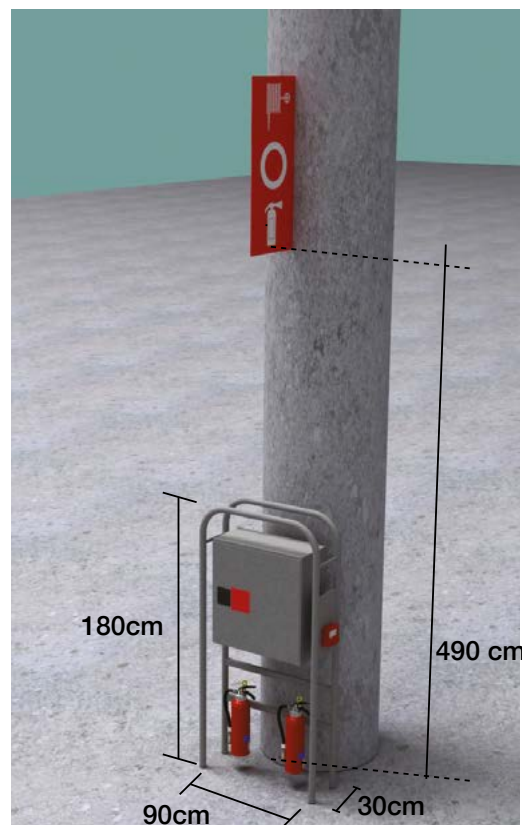
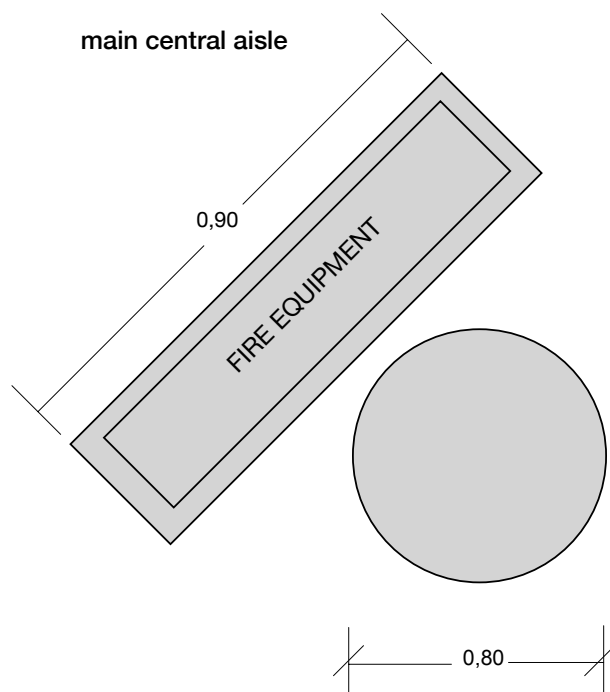

Note that the fire extinguisher equipment and sign need to remain accessible and visible at all times.

### Picture



The current document only provides guidance on venue technical information for organisers.

When designing specific areas or booth spaces please always refer to the technical hall DWG available for download at this website.

# Column details - Gran Via Hall 3

## Column type C303

### Floorplan & Dimensions

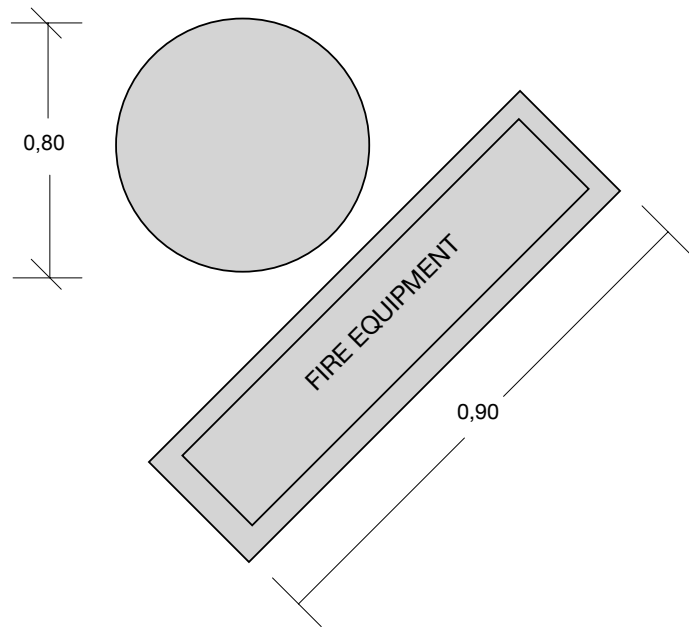

main central aisle

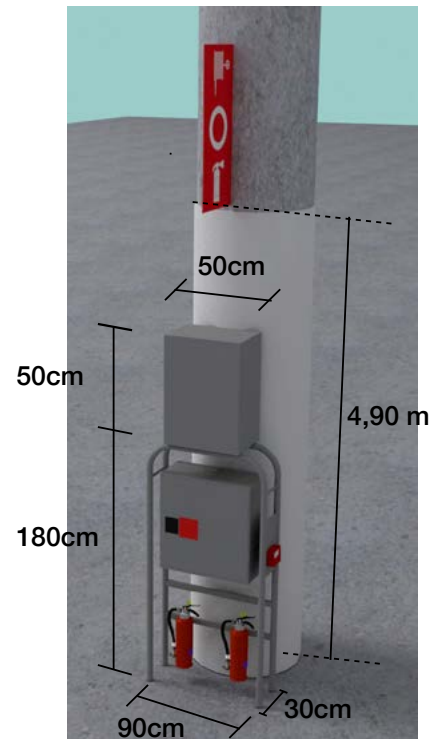

Note that the fire extinguisher equipment and sign need to remain accessible and visible at all times. These columns include a switchboard with 12 schuko type sockets of 10A to be used during build-up only.

### Picture



The current document only provides guidance on venue technical information for organisers.

When designing specific areas or booth spaces please always refer to the technical hall DWG available for download at this website.



# Column details - Gran Via Hall 3

## Column type C304

### Floorplan & Dimensions

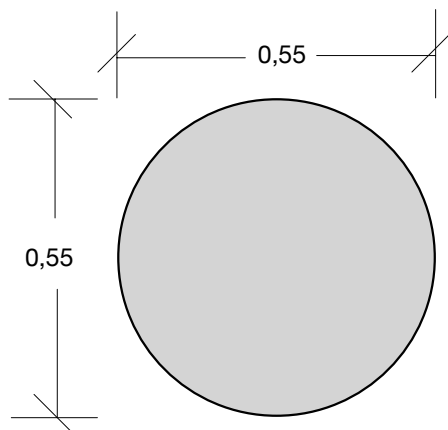

### Picture



The current document only provides guidance on venue technical information for organisers.

When designing specific areas or booth spaces please always refer to the technical hall DWG available for download at this website.

# HALL 4 Floorplan

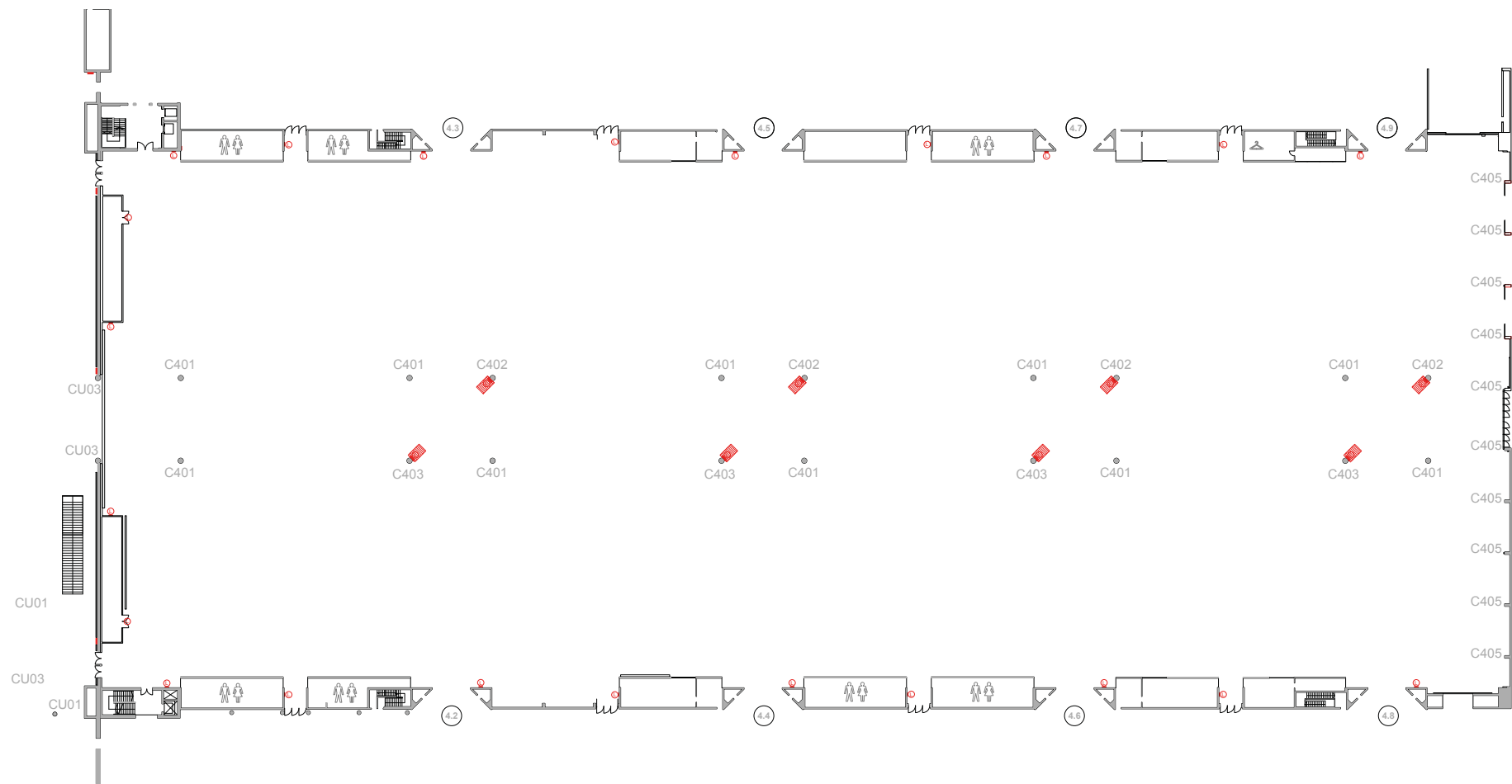

The current document only provides guidance on venue technical information for organisers.

When designing specific areas or booth spaces please always refer to the technical hall DWG available for download at this website.

# Column details - Gran Via Hall 4

## Column type C401

### Floorplan & Dimensions

---

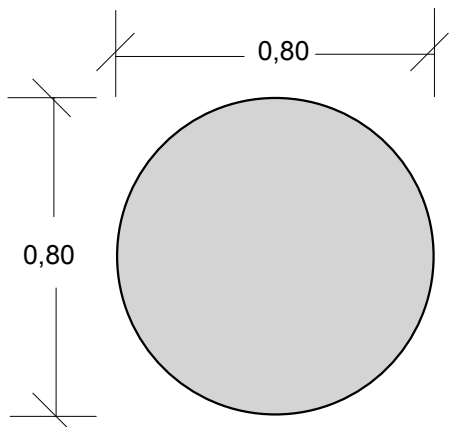

### Picture

---



The current document only provides guidance on venue technical information for organisers.

When designing specific areas or booth spaces please always refer to the technical hall DWG available for download at this website.

# Column details - Gran Via Hall 4

## Column type C402

### Floorplan & Dimensions

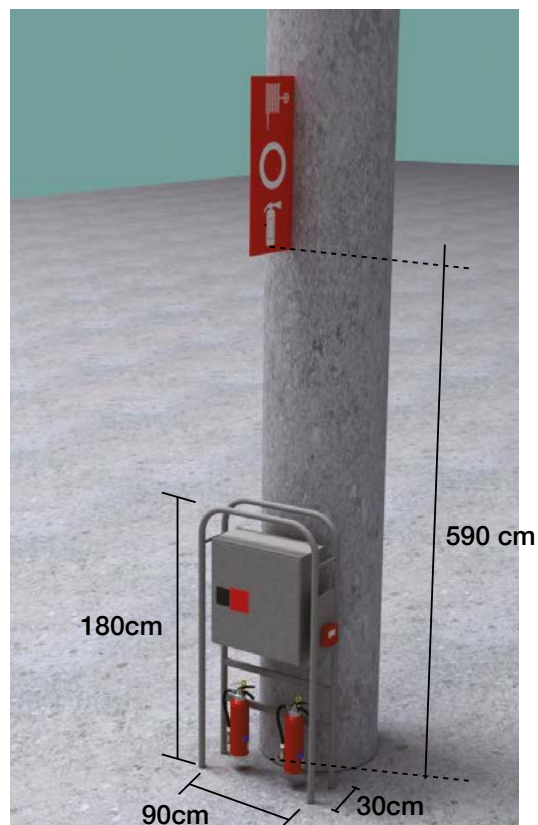
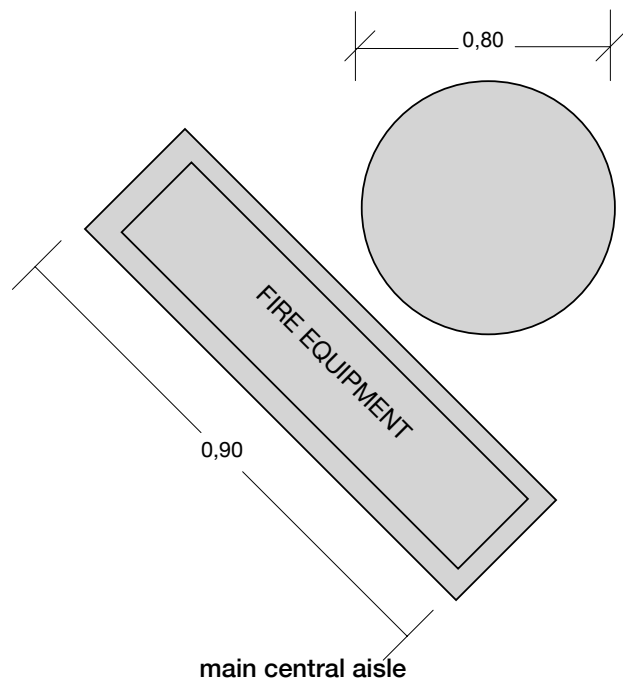

Note that the fire extinguisher equipment and sign need to remain accessible and visible at all times.

### Picture



The current document only provides guidance on venue technical information for organisers.

When designing specific areas or booth spaces please always refer to the technical hall DWG available for download at this website.

# Column details - Gran Via Hall 4

## Column type C403

### Floorplan & Dimensions

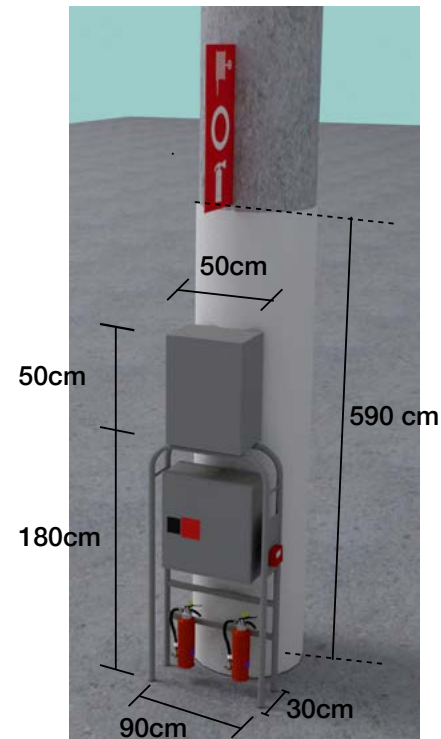
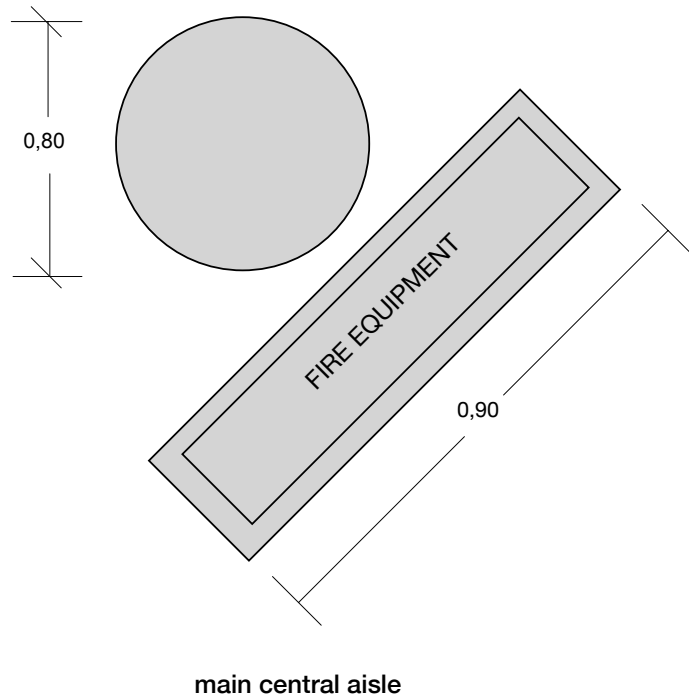

Note that the fire extinguisher equipment and sign need to remain accessible and visible at all times. These columns include a switchboard with 12 schuko type sockets of 10A to be used during build-up only.

### Picture



The current document only provides guidance on venue technical information for organisers.

When designing specific areas or booth spaces please always refer to the technical hall DWG available for download at this website.

# HALL 5 Floorplan

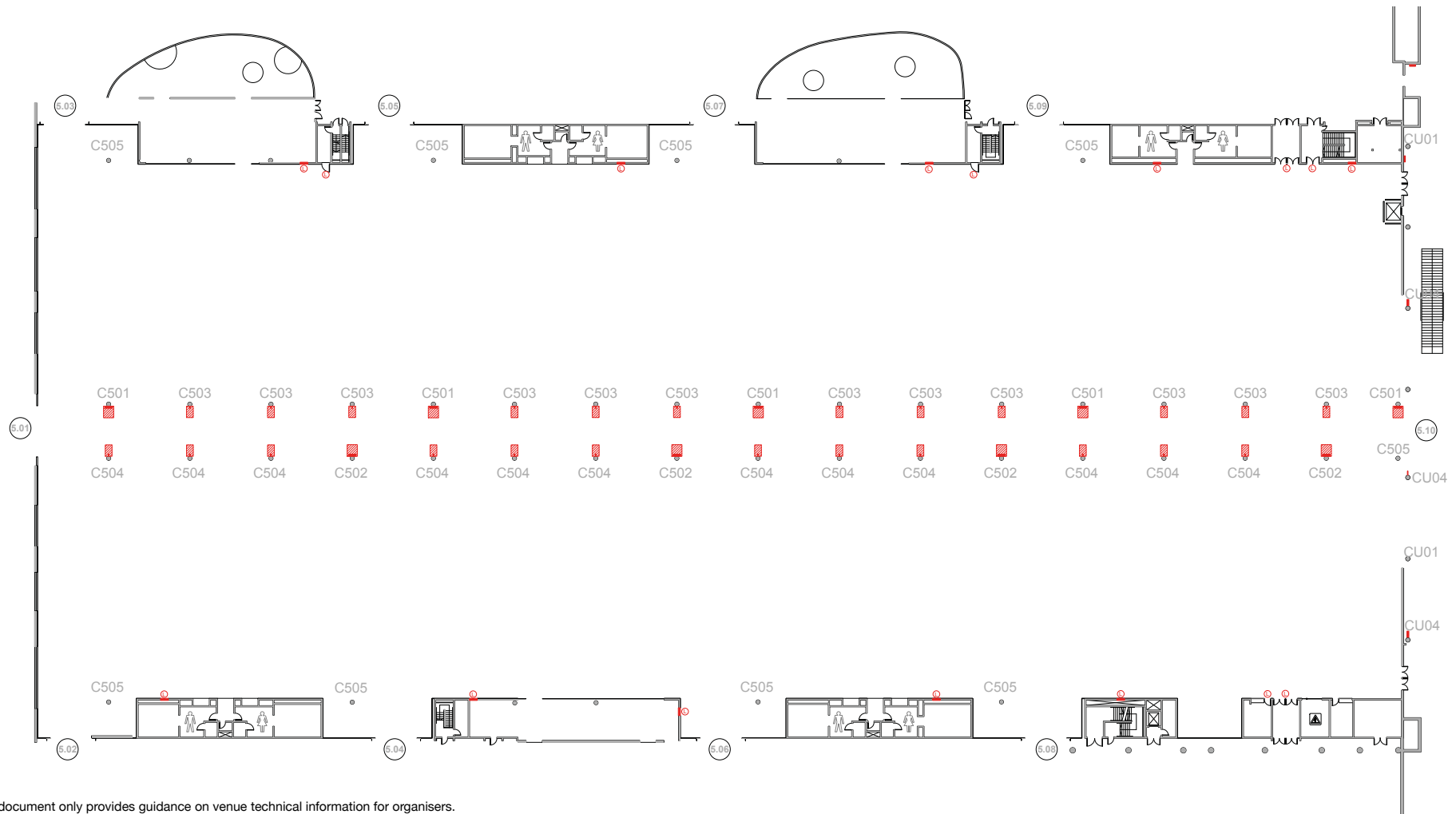

The current document only provides guidance on venue technical information for organisers.

When designing specific areas or booth spaces please always refer to the technical hall DWG available for download at this website.



# Column details - Gran Via Hall 5

## Column type C501

### Floorplan & Dimensions

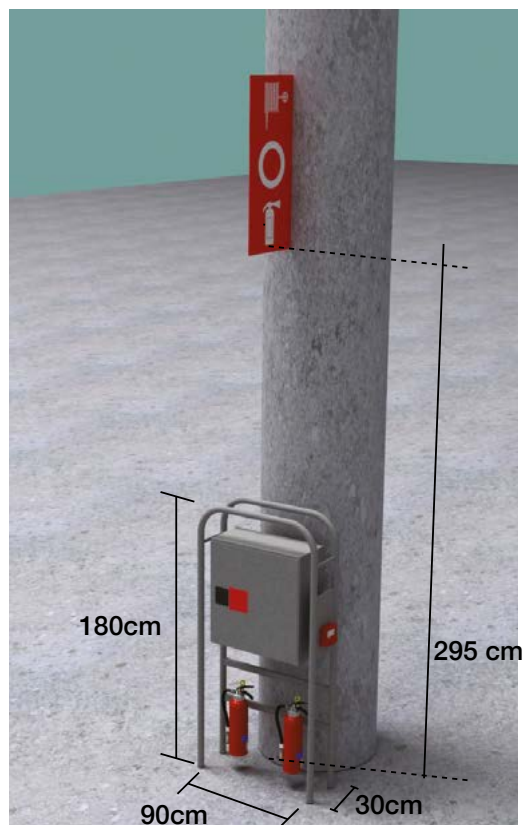
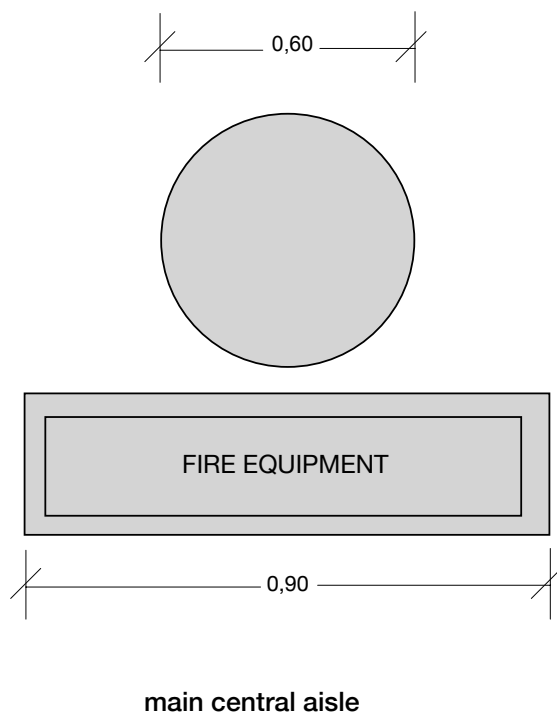

Note that the fire extinguisher equipment and sign need to remain accessible and visible at all times.

### Picture



The current document only provides guidance on venue technical information for organisers.

When designing specific areas or booth spaces please always refer to the technical hall DWG available for download at this website.

# Column details - Gran Via Hall 5

## Column type C502

### Floorplan & Dimensions

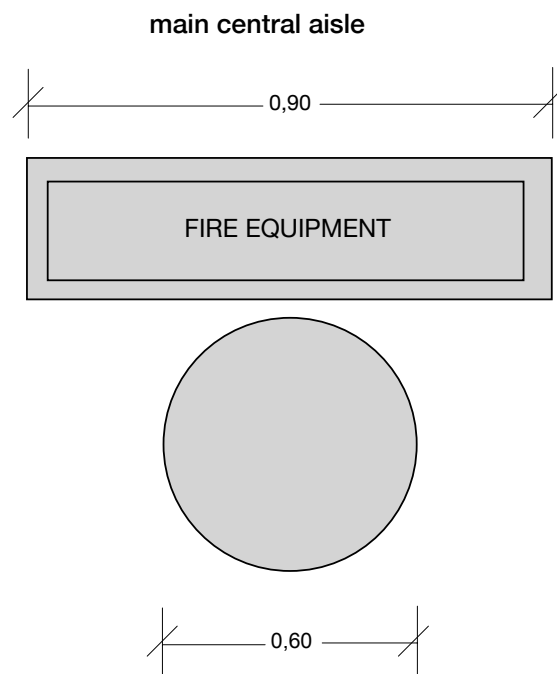

The current document only provides guidance on venue technical information for organisers.

When designing specific areas or booth spaces please always refer to the technical hall DWG available for download at this website.

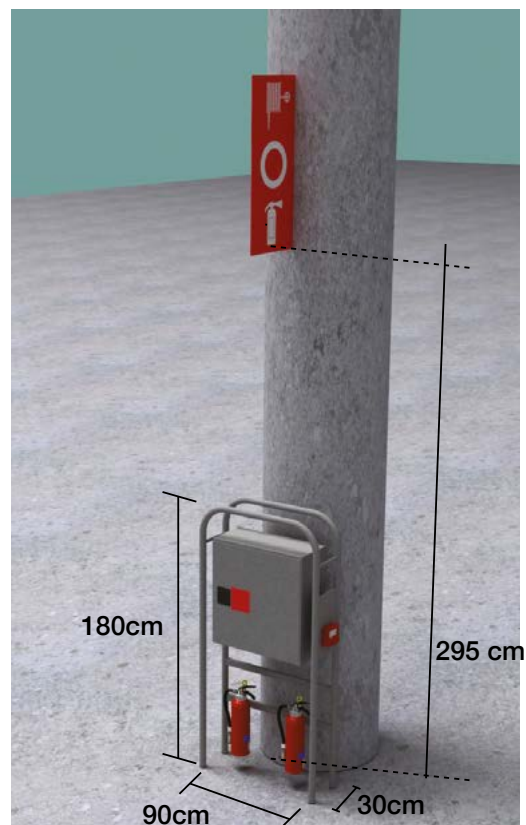

Note that the fire extinguisher equipment and sign need to remain accessible and visible at all times.

### Picture

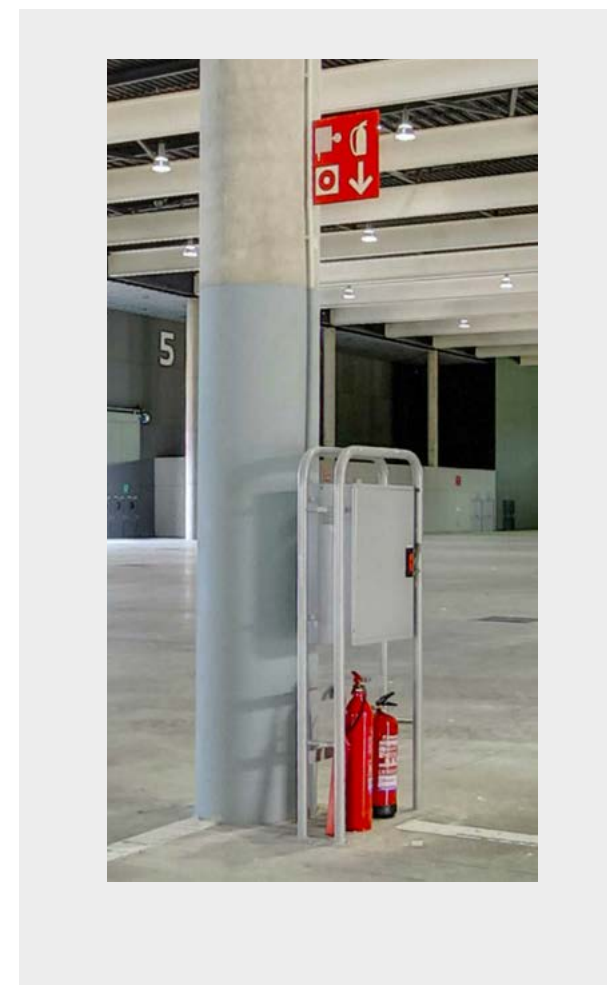

# Column details - Gran Via Hall 5

## Column type C503

### Floorplan & Dimensions

---

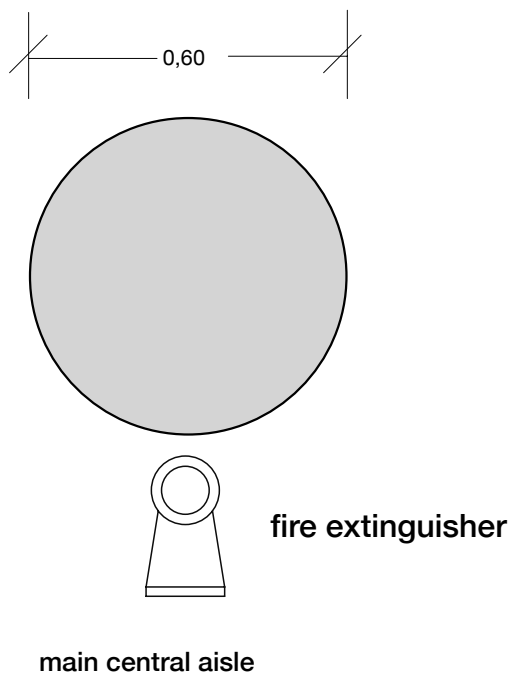

### Picture

---



The current document only provides guidance on venue technical information for organisers.

When designing specific areas or booth spaces please always refer to the technical hall DWG available for download at this website.

# Column details - Gran Via Hall 5

## Column type C504

### Floorplan & Dimensions

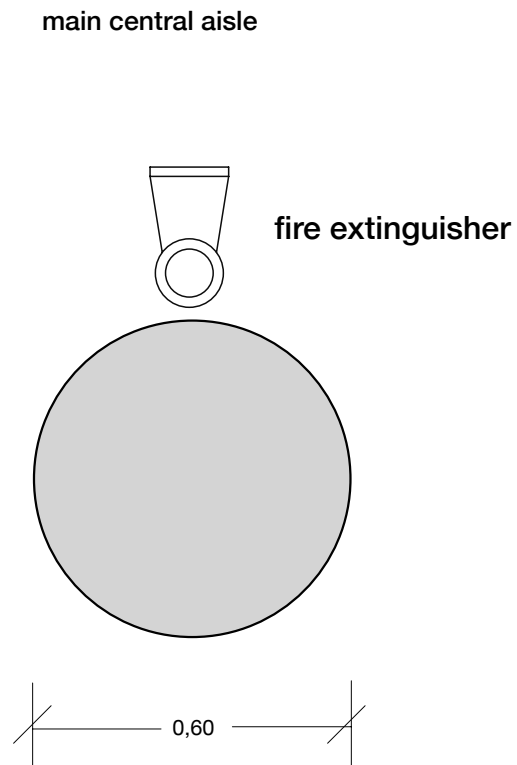

The current document only provides guidance on venue technical information for organisers.

When designing specific areas or booth spaces please always refer to the technical hall DWG available for download at this website.

### Picture



# Column details - Gran Via Hall 5

## Column type C505

### Floorplan & Dimensions

---

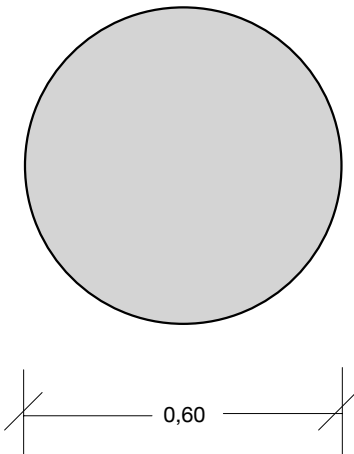

### Picture

---



The current document only provides guidance on venue technical information for organisers.

When designing specific areas or booth spaces please always refer to the technical hall DWG available for download at this website.

# HALL 6 Floorplan

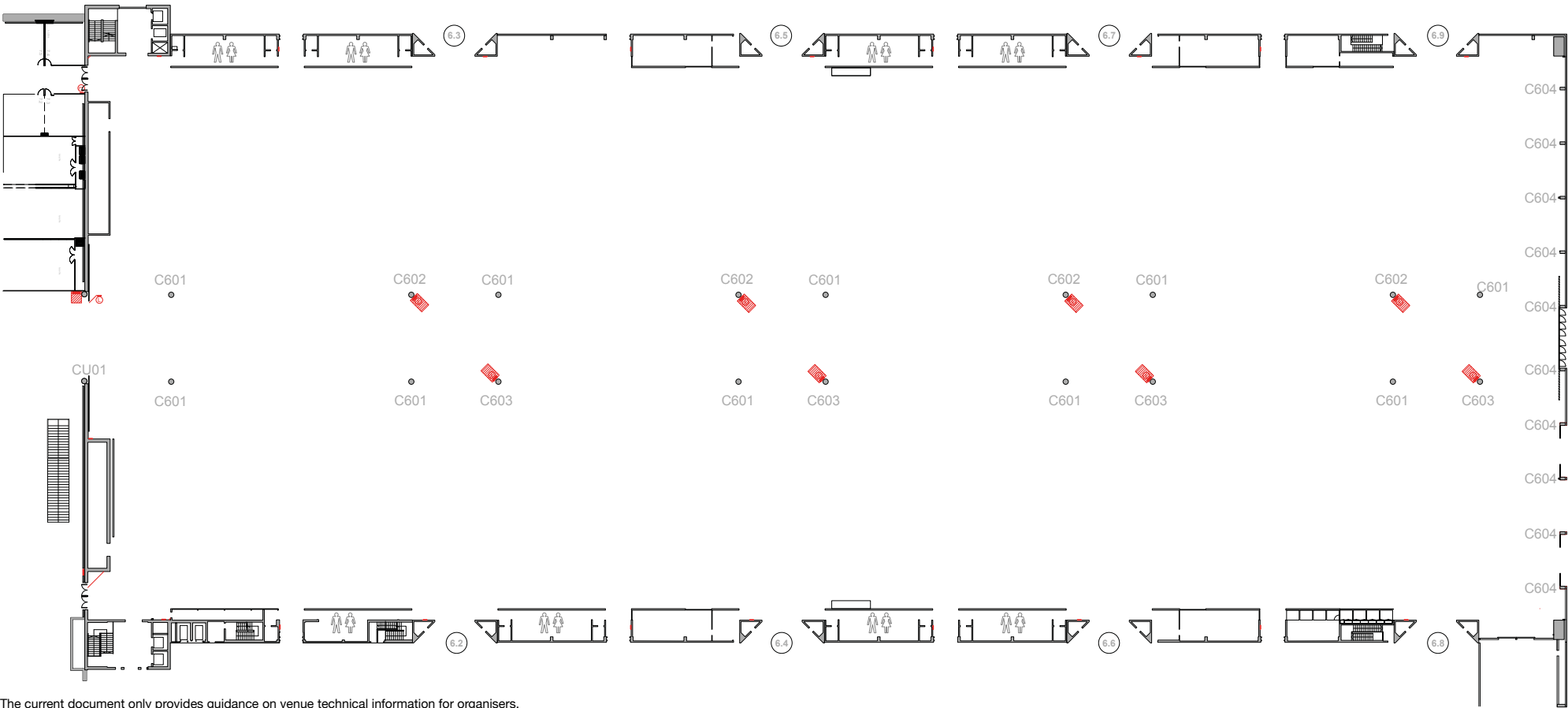

The current document only provides guidance on venue technical information for organisers.  
When designing specific areas or booth spaces please always refer to the technical hall DWG available for download at this website.



# Column details - Gran Via Hall 6

## Column type C601

### Floorplan & Dimensions

---

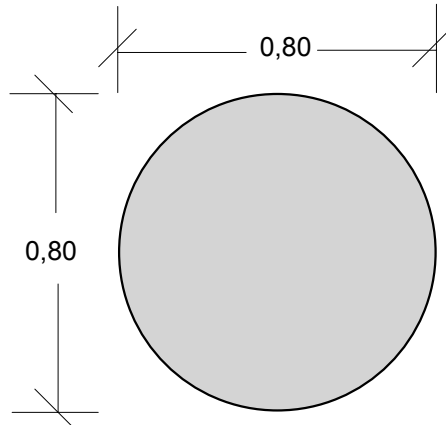

### Picture

---



The current document only provides guidance on venue technical information for organisers.

When designing specific areas or booth spaces please always refer to the technical hall DWG available for download at this website.

# Column details - Gran Via Hall 6

## Column type C602

### Floorplan & Dimensions

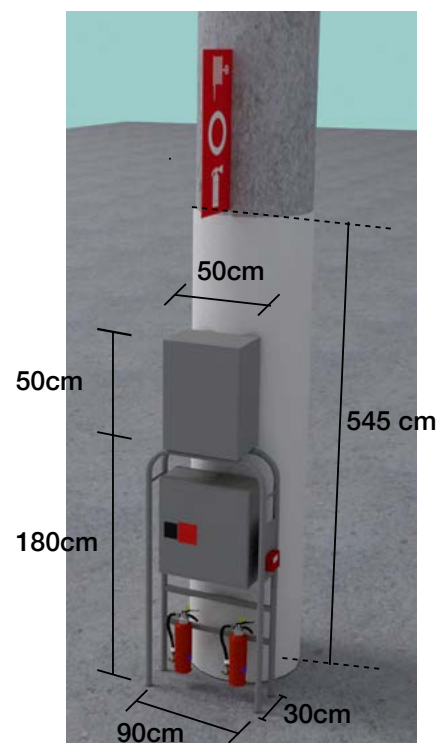
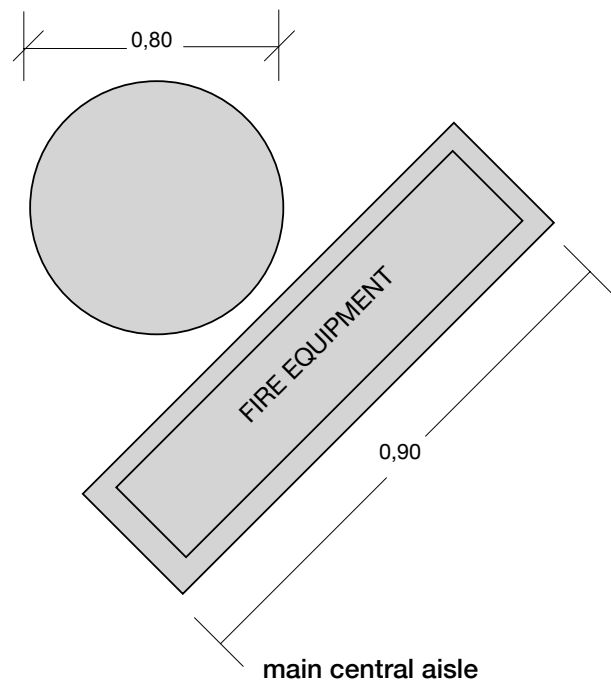

Note that the fire extinguisher equipment and sign need to remain accessible and visible at all times. These columns include a switchboard with 12 schuko type sockets of 10A to be used during build-up only.

### Picture



The current document only provides guidance on venue technical information for organisers.

When designing specific areas or booth spaces please always refer to the technical hall DWG available for download at this website.

# Column details - Gran Via Hall 6

## Column type C603

### Floorplan & Dimensions

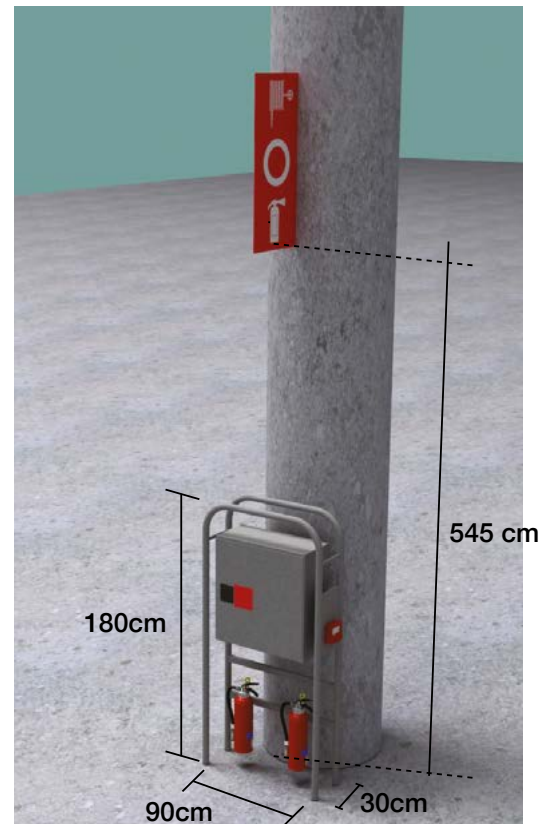
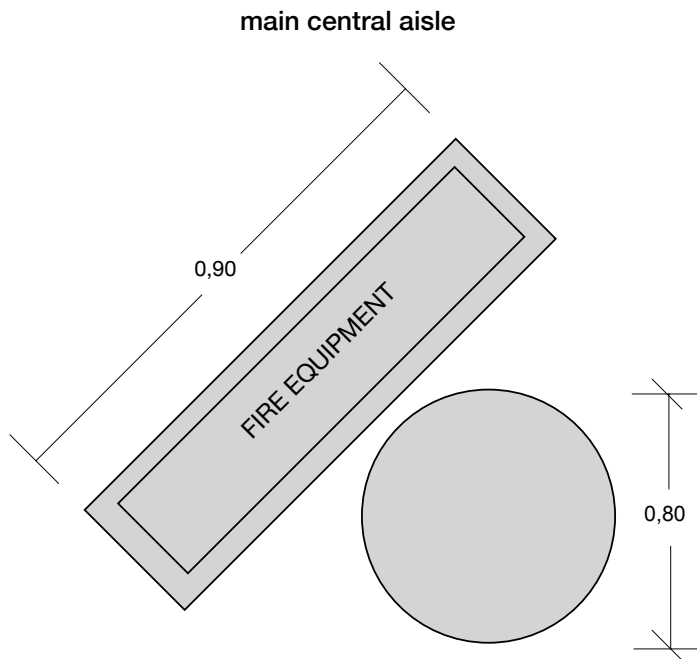

Note that the fire extinguisher equipment and sign need to remain accessible and visible at all times.

### Picture



The current document only provides guidance on venue technical information for organisers.

When designing specific areas or booth spaces please always refer to the technical hall DWG available for download at this website.

# Column details - Gran Via Hall 6

## Column type C604

### Floorplan & Dimensions

---

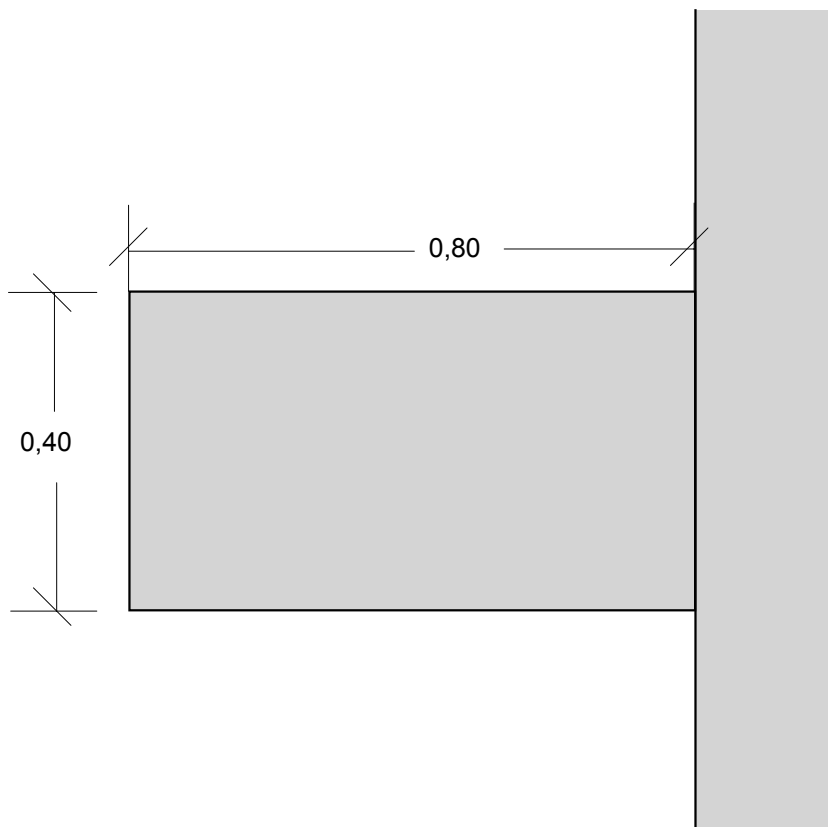

The current document only provides guidance on venue technical information for organisers.

When designing specific areas or booth spaces please always refer to the technical hall DWG available for download at this website.

### Picture

---



# HALL 7 Floorplan

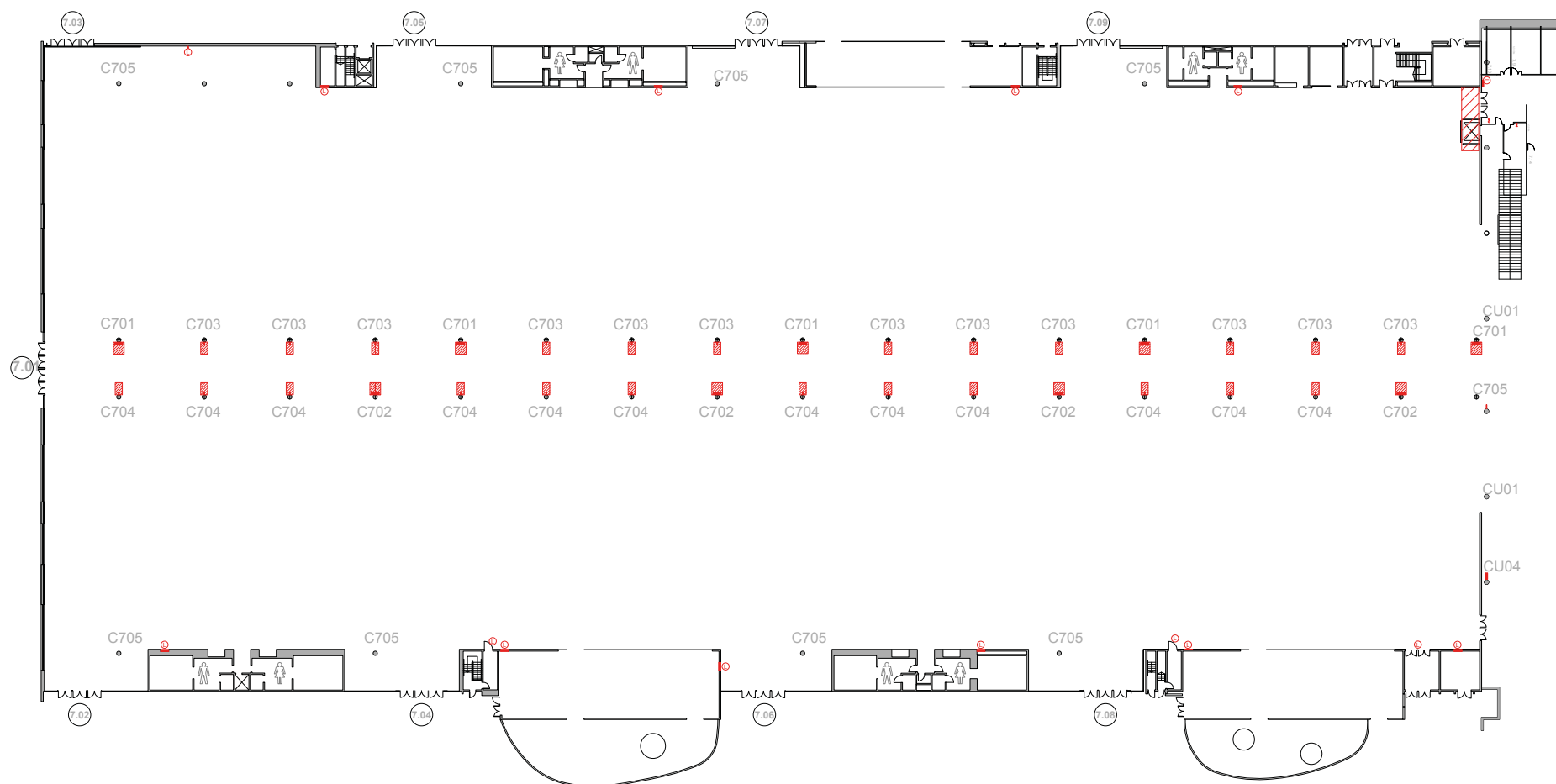

The current document only provides guidance on venue technical information for organisers.

When designing specific areas or booth spaces please always refer to the technical hall DWG available for download at this website.

# Column details - Gran Via Hall 7

## Column type C701

### Floorplan & Dimensions

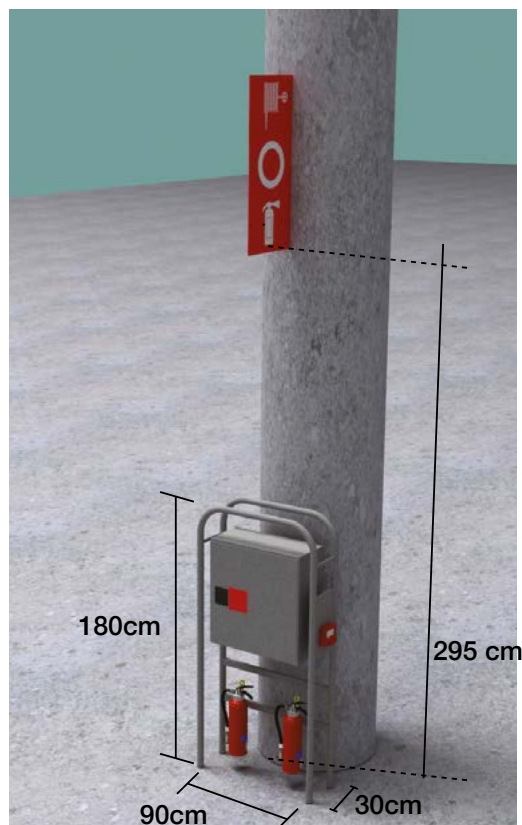
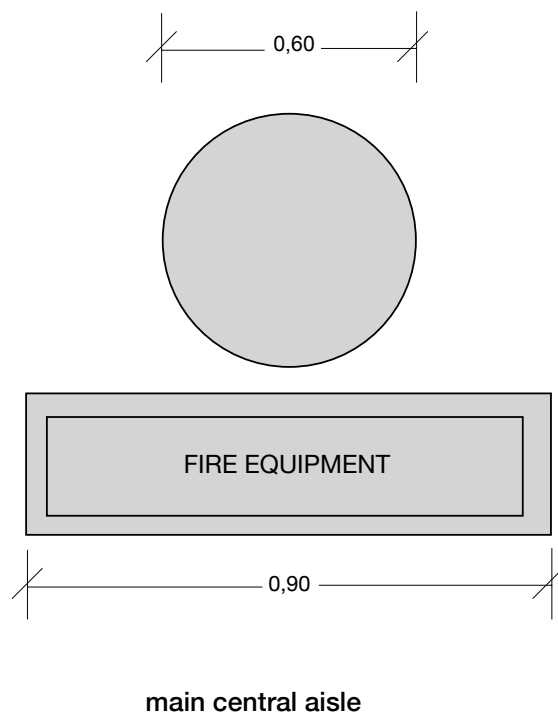

Note that the fire extinguisher equipment and sign need to remain accessible and visible at all times.

### Picture



The current document only provides guidance on venue technical information for organisers.

When designing specific areas or booth spaces please always refer to the technical hall DWG available for download at this website.



# Column details - Gran Via Hall 7

## Column type C702

### Floorplan & Dimensions

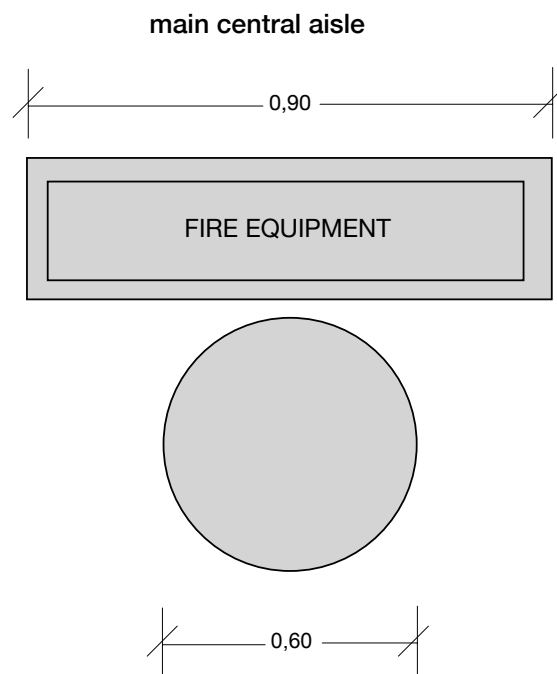

The current document only provides guidance on venue technical information for organisers.

When designing specific areas or booth spaces please always refer to the technical hall DWG available for download at this website.

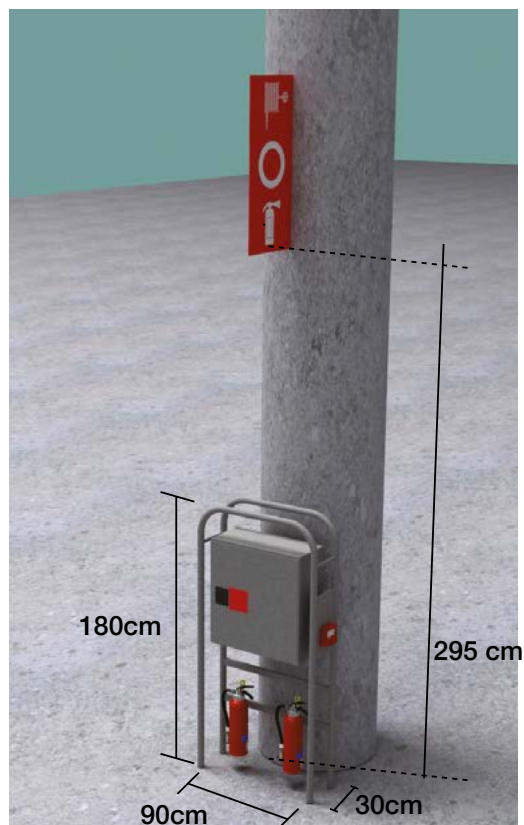

Note that the fire extinguisher equipment and sign need to remain accessible and visible at all times.

### Picture

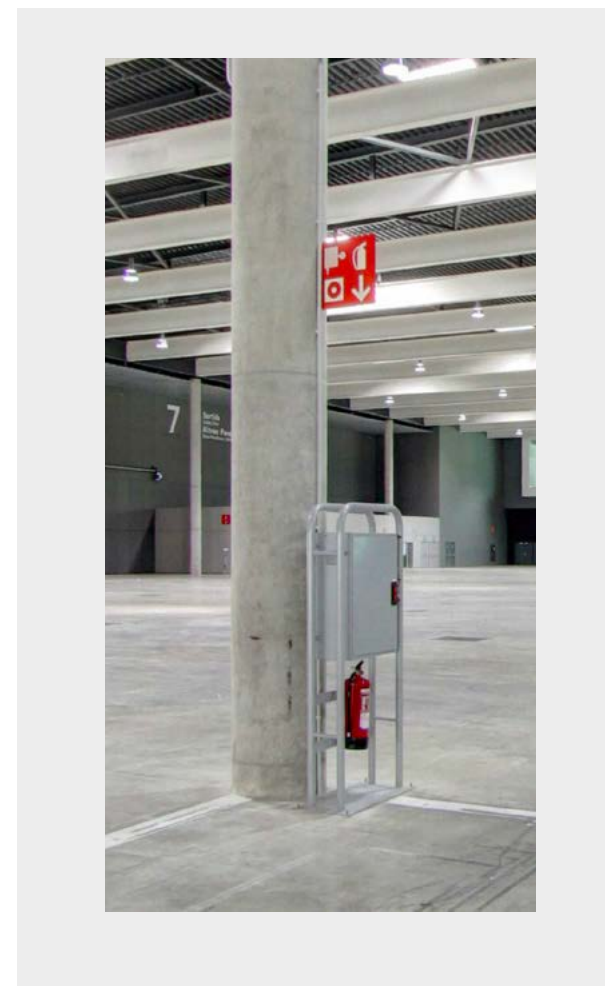

# Column details - Gran Via Hall 7

## Column type C703

### Floorplan & Dimensions

---

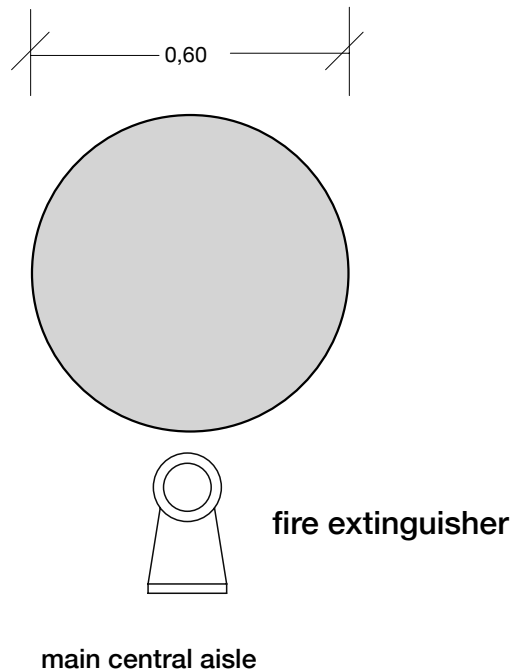

### Picture

---

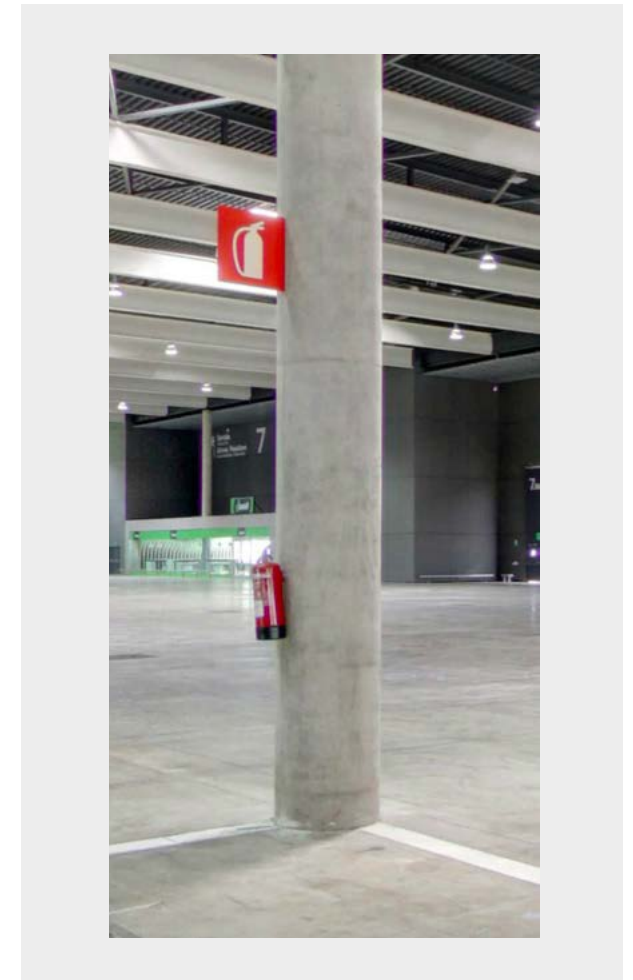

The current document only provides guidance on venue technical information for organisers.

When designing specific areas or booth spaces please always refer to the technical hall DWG available for download at this website.

# Column details - Gran Via Hall 7

## Column type C704

### Floorplan & Dimensions

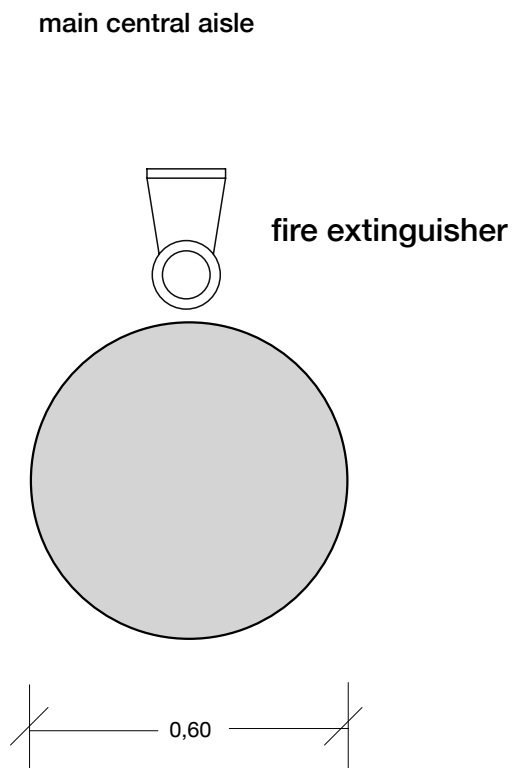

The current document only provides guidance on venue technical information for organisers.

When designing specific areas or booth spaces please always refer to the technical hall DWG available for download at this website.

### Picture

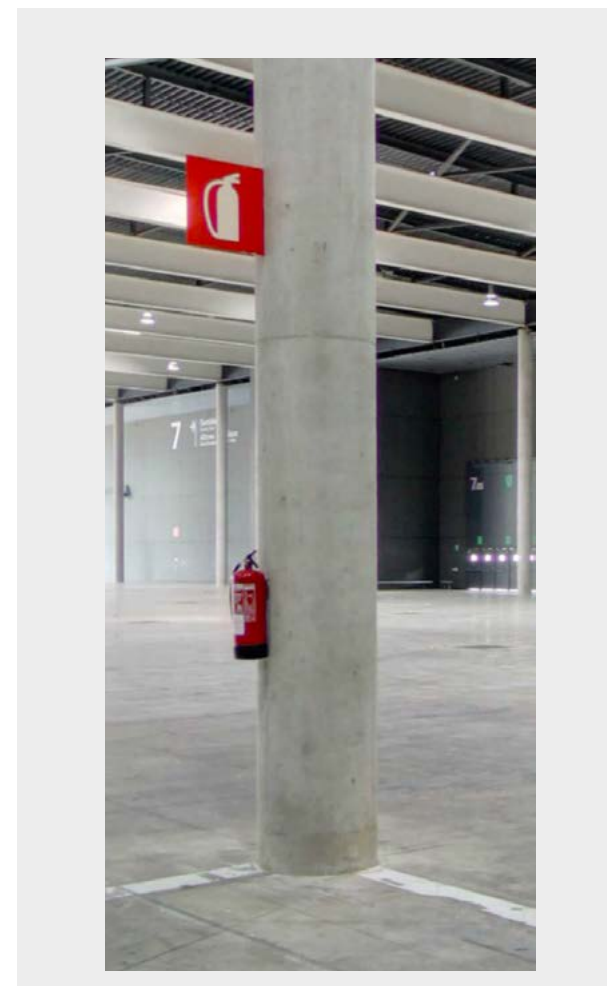

# Column details - Gran Via Hall 7

## Column type C705

### Floorplan & Dimensions

---

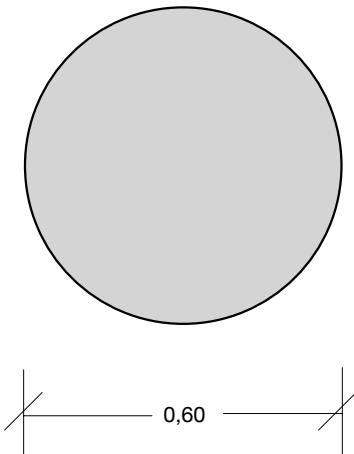

### Picture

---



The current document only provides guidance on venue technical information for organisers.

When designing specific areas or booth spaces please always refer to the technical hall DWG available for download at this website.

# UNDERWALKWAY Floorplan

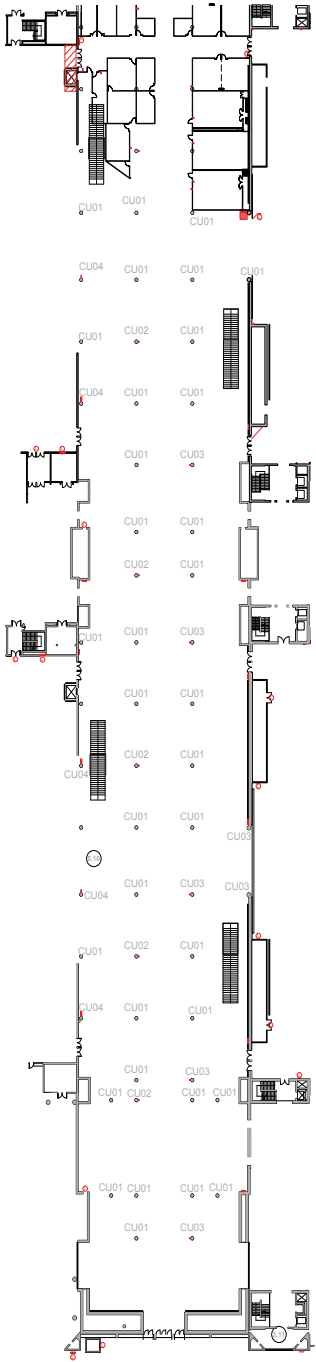

The current document only provides guidance on venue technical information for organisers.

When designing specific areas or booth spaces please always refer to the technical hall DWG available for download at [this website](#).

# Column details - Gran Via Underwalkway Halls 4, 5, 6 and 7

## Column type CU01

### Floorplan & Dimensions

---

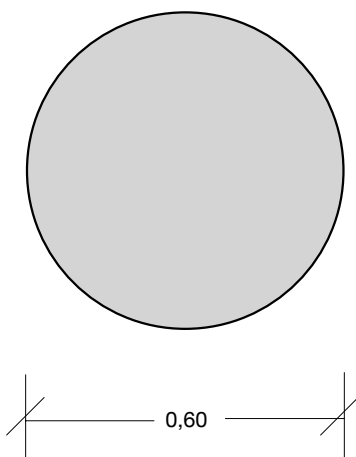

The current document only provides guidance on venue technical information for organisers.

When designing specific areas or booth spaces please always refer to the technical hall DWG available for download at this website.

### Picture

---





# Column details - Gran Via Underwalkway Halls 4, 5, 6 and 7

## Column type CU02

### Floorplan & Dimensions

---

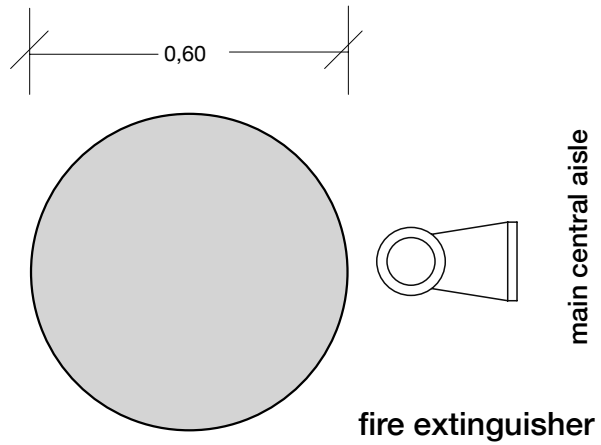

### Picture

---

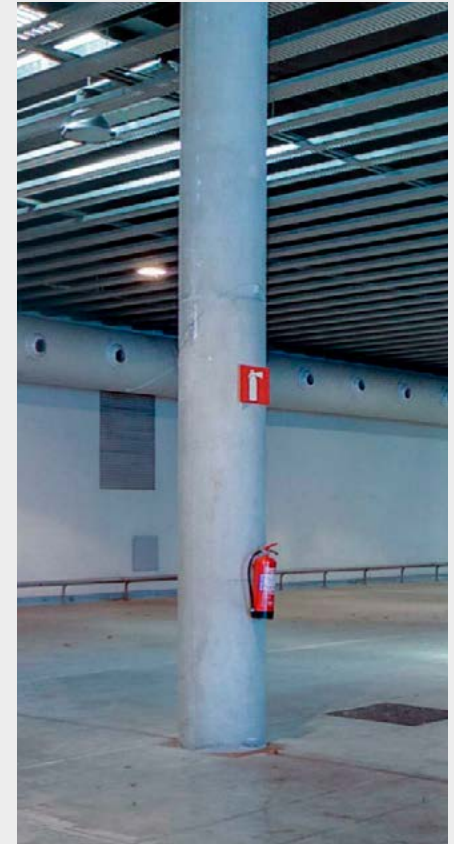

The current document only provides guidance on venue technical information for organisers.

When designing specific areas or booth spaces please always refer to the technical hall DWG available for download at this website.

# Column details - Gran Via Underwalkway Halls 4, 5, 6 and 7

## Column type CU03

### Floorplan & Dimensions

---

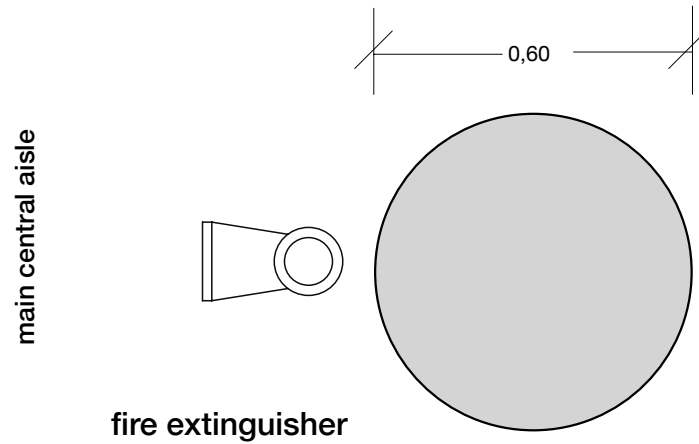

### Picture

---



The current document only provides guidance on venue technical information for organisers.

When designing specific areas or booth spaces please always refer to the technical hall DWG available for download at this website.

# Column details - Gran Via Underwalkway Halls 4, 5, 6 and 7

## Column type CU04

### Floorplan & Dimensions

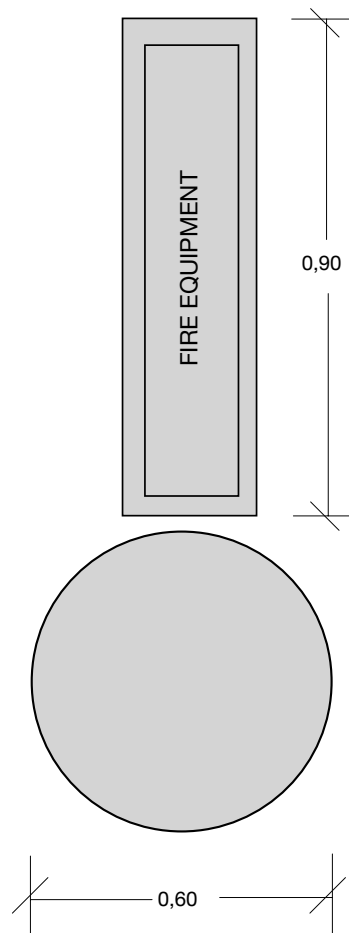

The current document only provides guidance on venue technical information for organisers.

When designing specific areas or booth spaces please always refer to the technical hall DWG available for download at this website.

### Picture

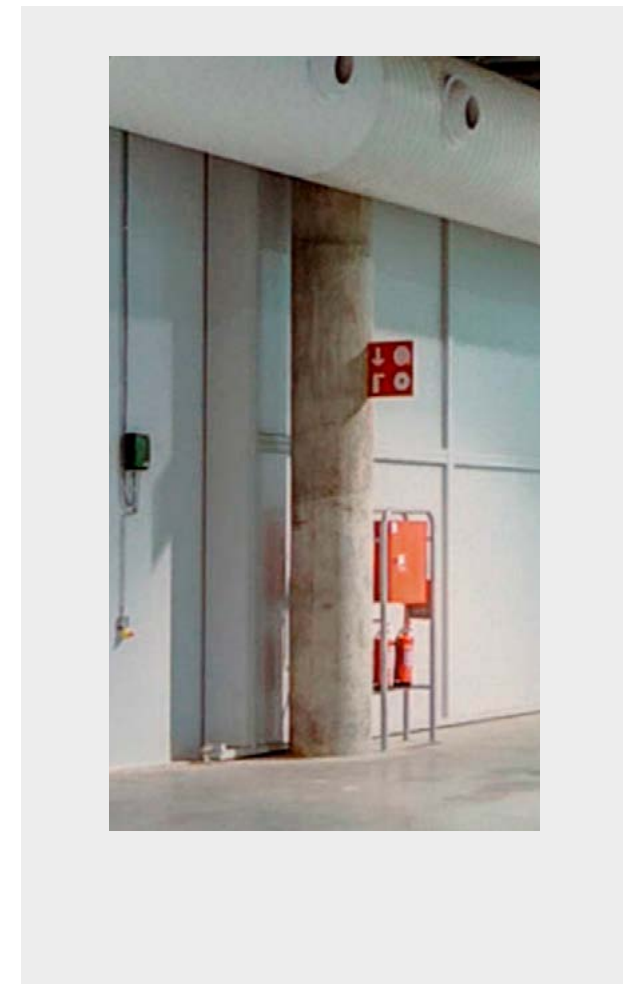

# HALL 8.0 Floorplan



The current document only provides guidance on venue technical information for organisers.  
When designing specific areas or booth spaces please always refer to the technical hall DWG available for download at [this website](#).

# Column details - Gran Via Hall 8.0

## Column type C8001

### Floorplan & Dimensions

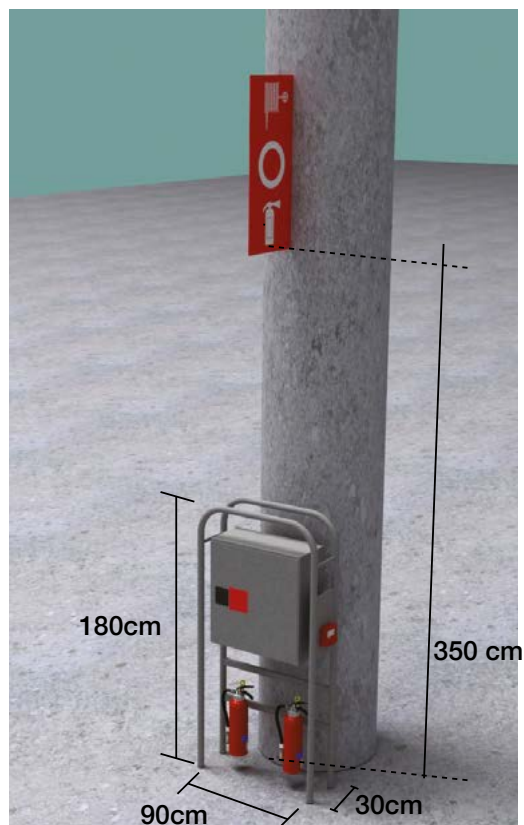
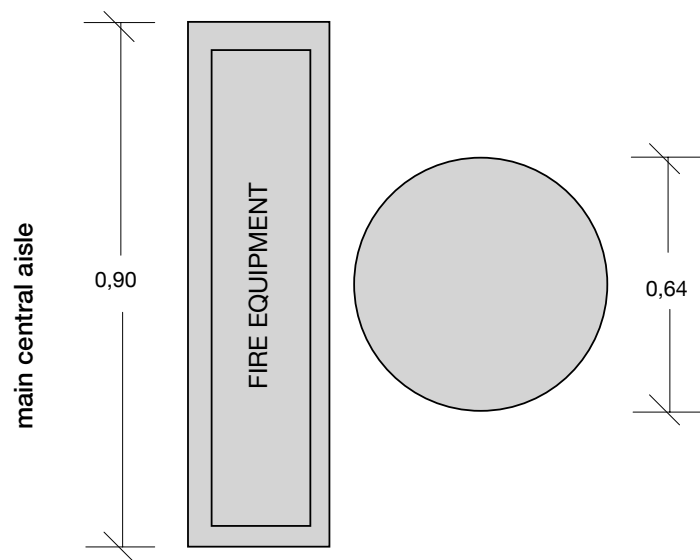

Note that the fire extinguisher equipment and sign need to remain accessible and visible at all times.

### Picture



The current document only provides guidance on venue technical information for organisers.

When designing specific areas or booth spaces please always refer to the technical hall DWG available for download at this website.

# Column details - Gran Via Hall 8.0

## Column type C8002

### Floorplan & Dimensions

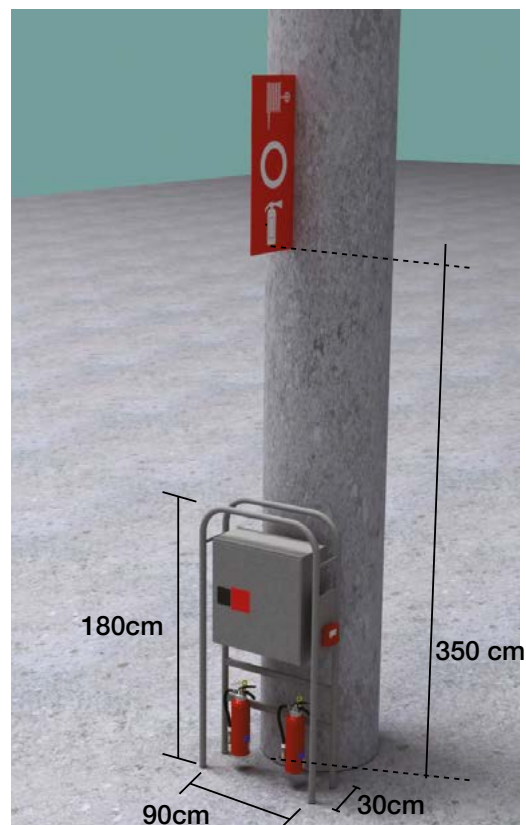
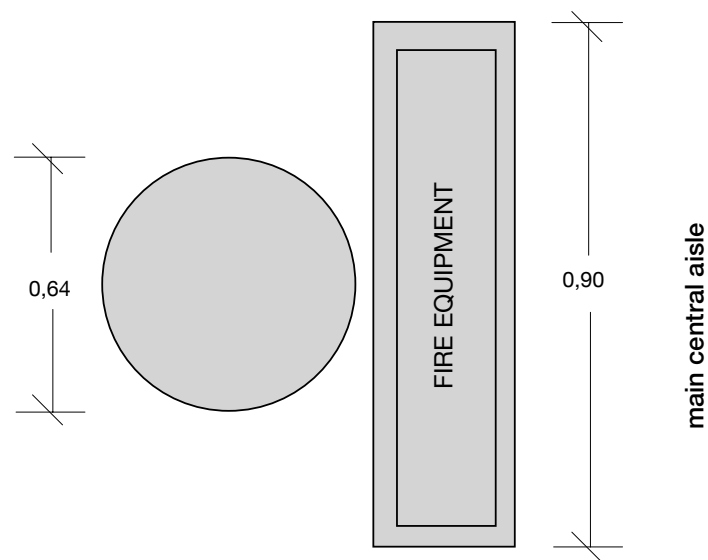

Note that the fire extinguisher equipment and sign need to remain accessible and visible at all times.

### Picture



The current document only provides guidance on venue technical information for organisers.

When designing specific areas or booth spaces please always refer to the technical hall DWG available for download at this website.

# Column details - Gran Via Hall 8.0

## Column type C8003

### Floorplan & Dimensions

---

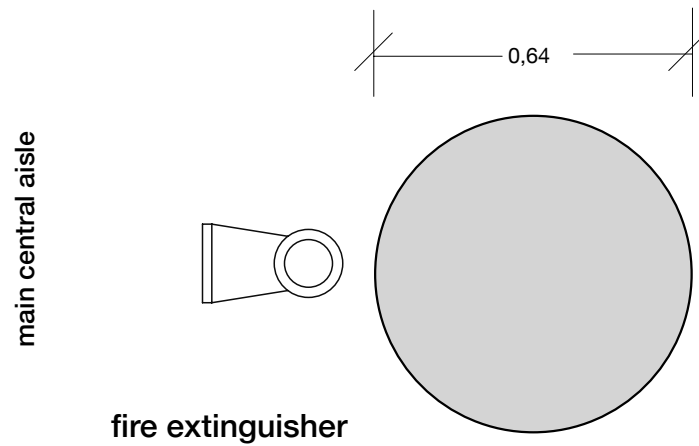

### Picture

---

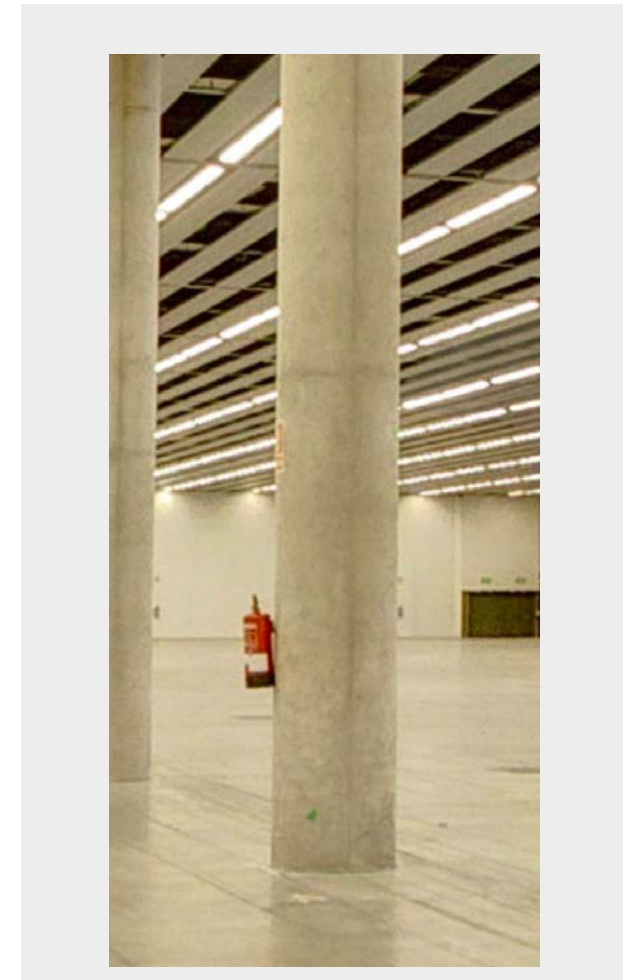

The current document only provides guidance on venue technical information for organisers.

When designing specific areas or booth spaces please always refer to the technical hall DWG available for download at this website.



# Column details - Gran Via Hall 8.0

## Column type C8004

### Floorplan & Dimensions

---

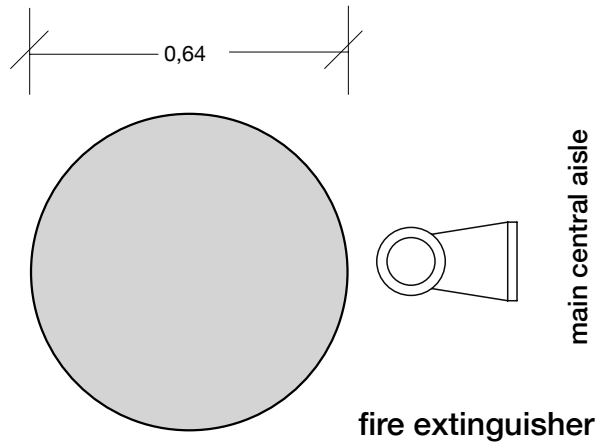

### Picture

---



The current document only provides guidance on venue technical information for organisers.

When designing specific areas or booth spaces please always refer to the technical hall DWG available for download at this website.

# Column details - Gran Via Hall 8.0

## Column type C8005

### Floorplan & Dimensions

---

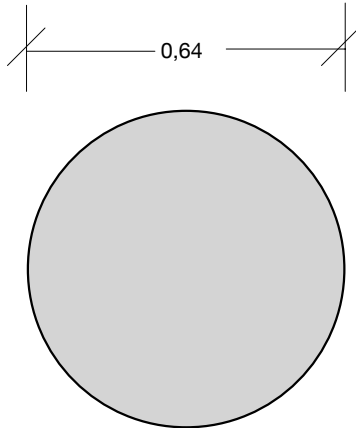

### Picture

---



The current document only provides guidance on venue technical information for organisers.

When designing specific areas or booth spaces please always refer to the technical hall DWG available for download at this website.

# HALL 8.1

## Floorplan

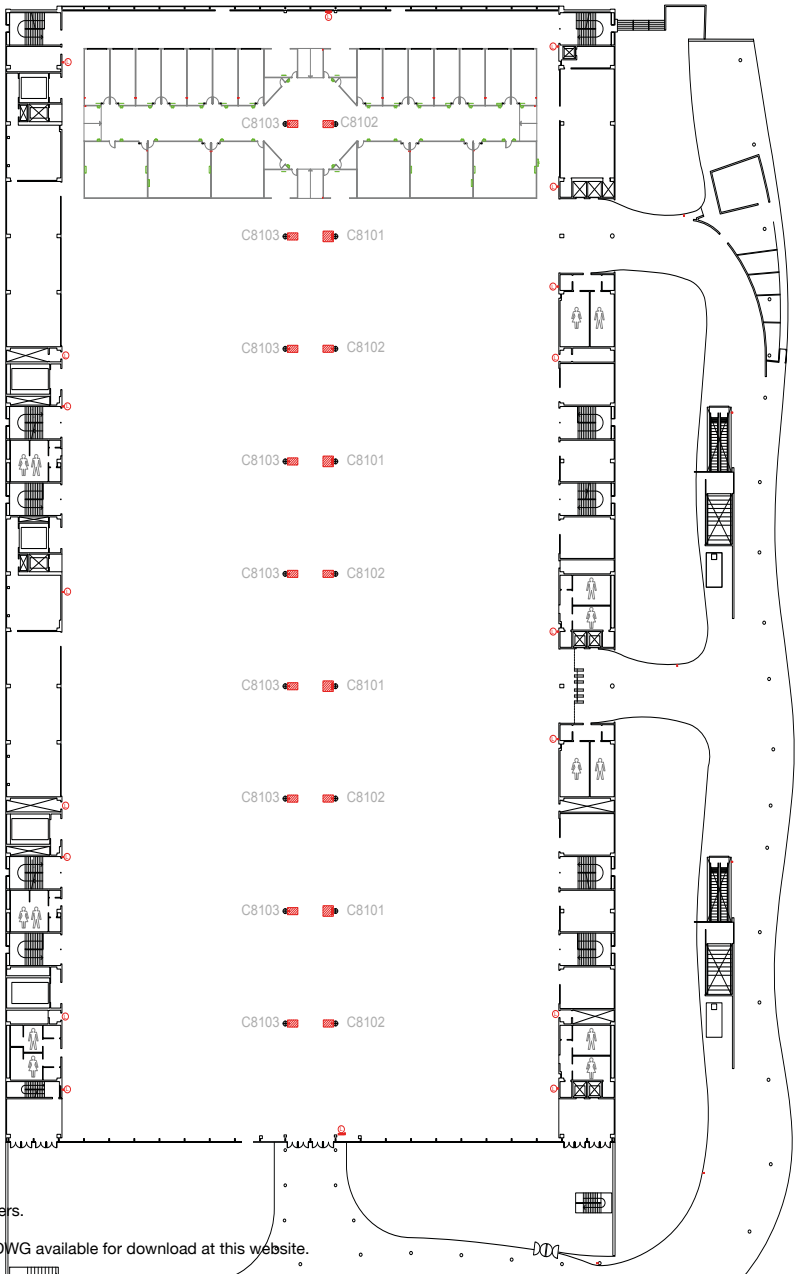

The current document only provides guidance on venue technical information for organisers.

When designing specific areas or booth spaces please always refer to the technical hall DWG available for download at [this website](#).

# Column details - Gran Via Hall 8.1

## Column type C8101

### Floorplan & Dimensions

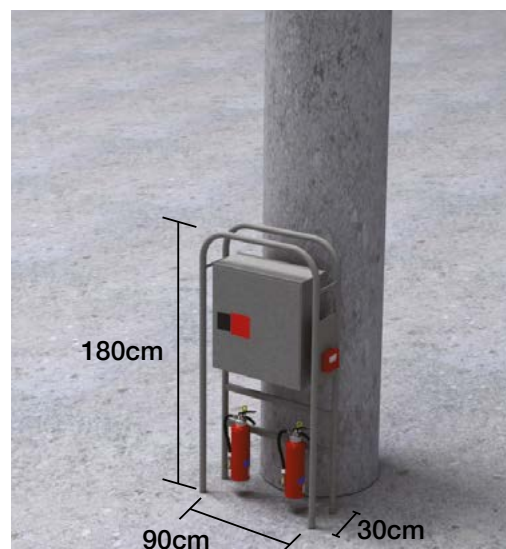
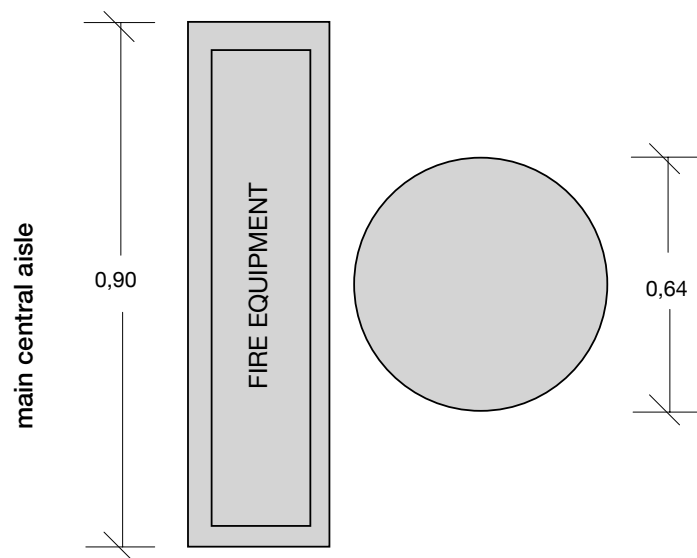

Note that the fire extinguisher equipment and sign need to remain accessible and visible at all times.

### Picture



The current document only provides guidance on venue technical information for organisers.

When designing specific areas or booth spaces please always refer to the technical hall DWG available for download at this website.

# Column details - Gran Via Hall 8.1

## Column type C8102

### Floorplan & Dimensions

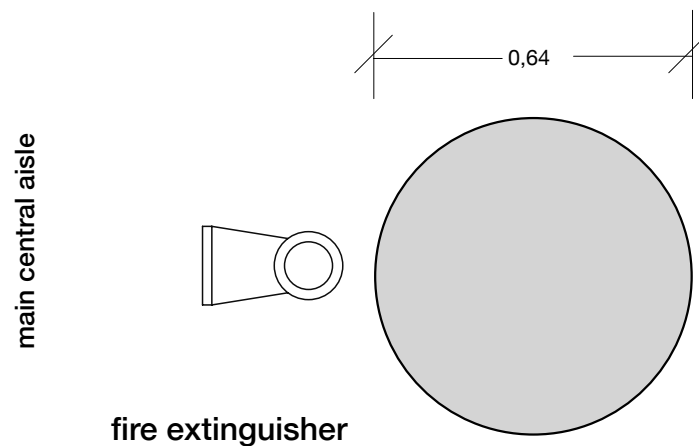

### Picture

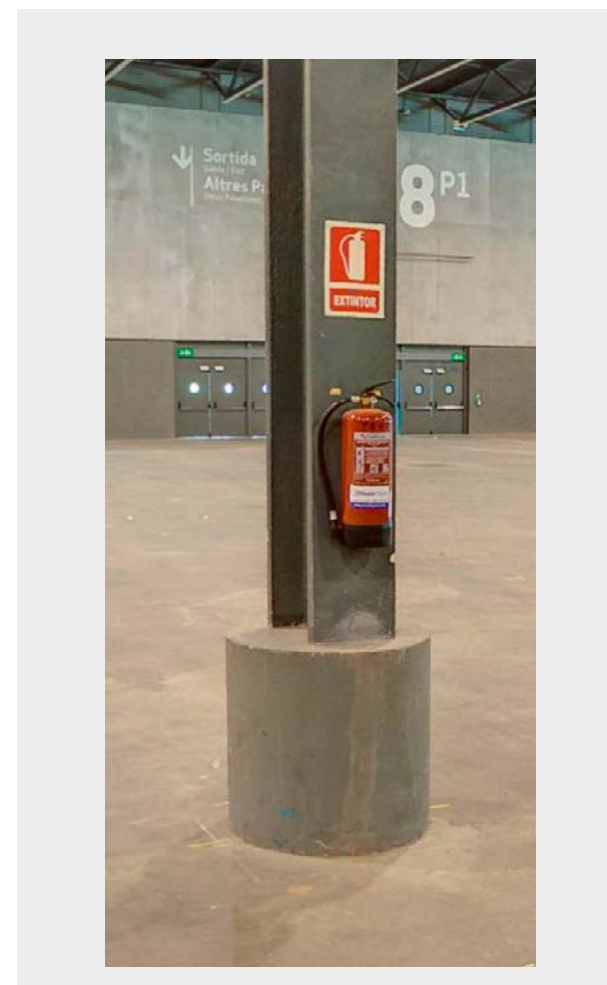

The current document only provides guidance on venue technical information for organisers.

When designing specific areas or booth spaces please always refer to the technical hall DWG available for download at this website.

# Column details - Gran Via Hall 8.1

## Column type C8103

### Floorplan & Dimensions

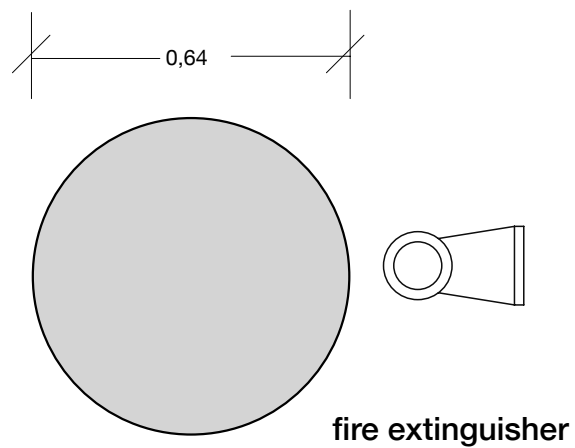

### Picture

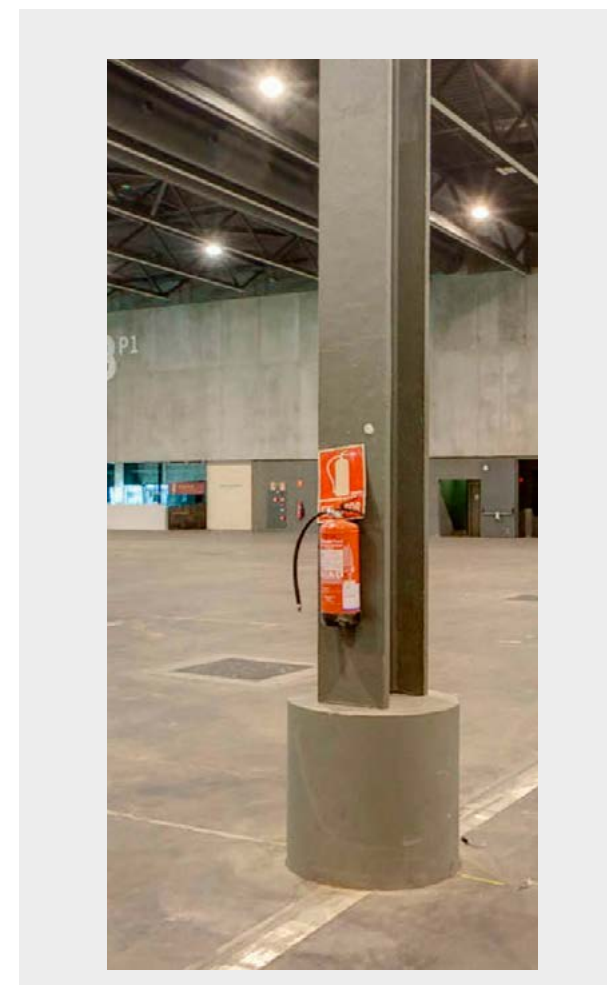

The current document only provides guidance on venue technical information for organisers.

When designing specific areas or booth spaces please always refer to the technical hall DWG available for download at this website.