

Link between Halls 4, 5 6 and 7

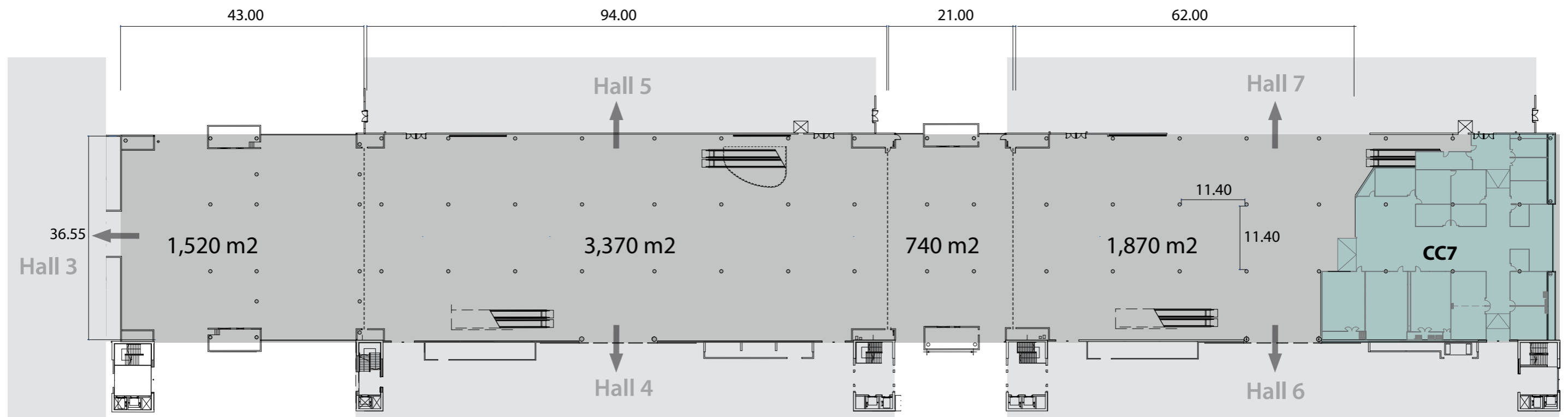
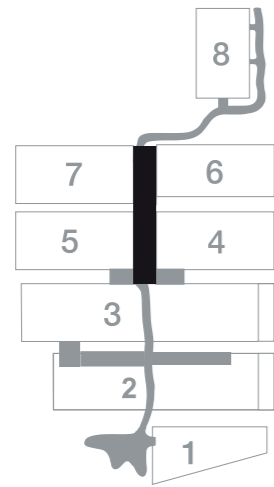

height: 5,20m / max construction height 4m
ground resistance 1.000 kg/m²

..... dividing panels

Link between Halls 4, 5 6 and 7

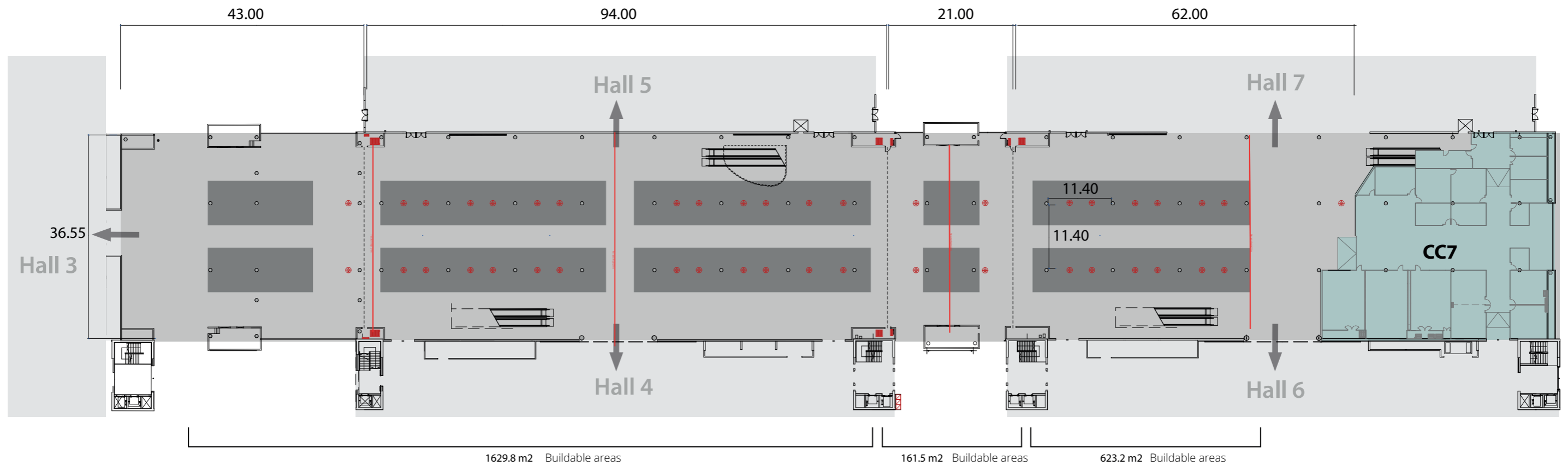
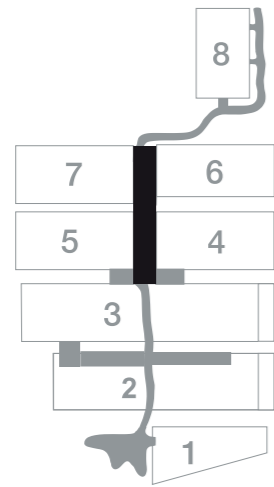

- Buildable areas
- Fire curtain.
In case of fire, it lowers to a height of 2,70m from the floor. All constructions below a fire curtain need to have this into consideration.
- + Service chests

height: 5,20m / max construction height 4m
ground resistance 5,000 kg/m²